

COPYRIGHT © 2010 BY BAXTER & WOODMAN, INC.  
 STATE OF ILLINOIS PROFESSIONAL DESIGN FIRM  
 No. - BR-12/13/2010  
 1: Mokena\VCC\0109530-Lawrence Union Branch\Drawings\00AS\Phase 2\Union\0109530-Ph2-XS-Union.rvt  
 5/8/16 BW

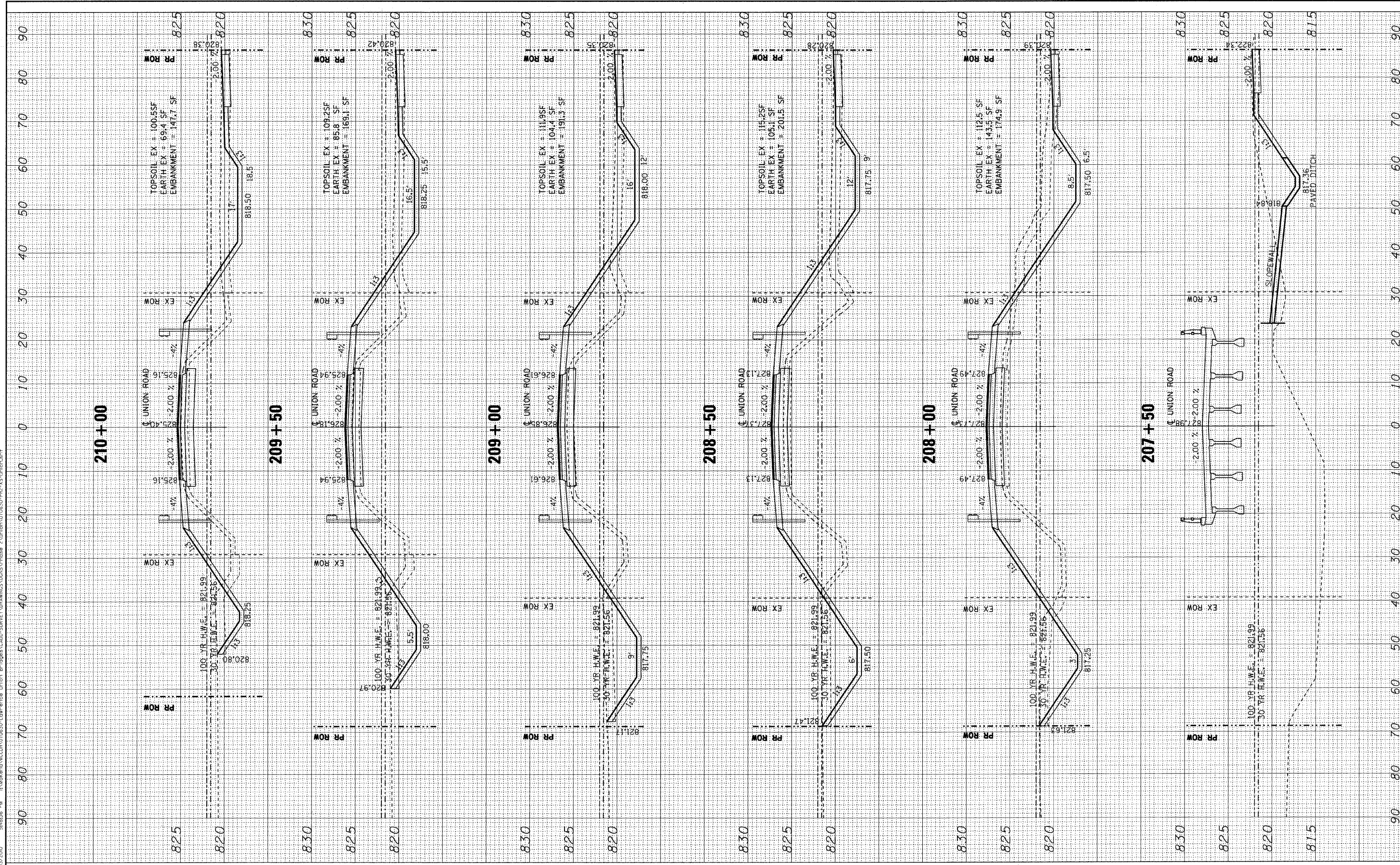

DESIGNED - CAC	REVISED - PER IDOT 10-08-10
DRAWN - BCD	REVISED -
CHECKED - TMS	REVISED -
DATE - 08-20-10	REVISED -

**MCHENRY COUNTY DIVISION OF TRANSPORTATION  
 UNION ROAD BRIDGE OVER  
 SOUTH BRANCH OF KISHWAUKEE RIVER**

**CROSS SECTIONS - UNION ROAD AT  
 SOUTH BRANCH KISHWAUKEE RIVER**

SCALE: H<sub>v</sub> 1"=10' V<sub>v</sub> 1"=5'

STA. TO STA.

F.A.S. RTE. 0034	SECTION 06-00320-02-BR	COUNTY MCHENRY	TOTAL SHEETS 65	SHEET NO. 64
CONTRACT NO. 63536			JOB NO. C-91-140-11 ILLINOIS FED. AID PROJECT BRS-00341071	