

- NOTES:**
1. ALL DIMENSIONS ARE TO THE EDGE OF PAVEMENT UNLESS OTHERWISE NOTED.
  2. FOR THE PROPOSED RIGHT-OF-WAY LIMITS SEE RIGHT-OF-WAY PLANS.
  3. F/G = FACE OF GUARDRAIL

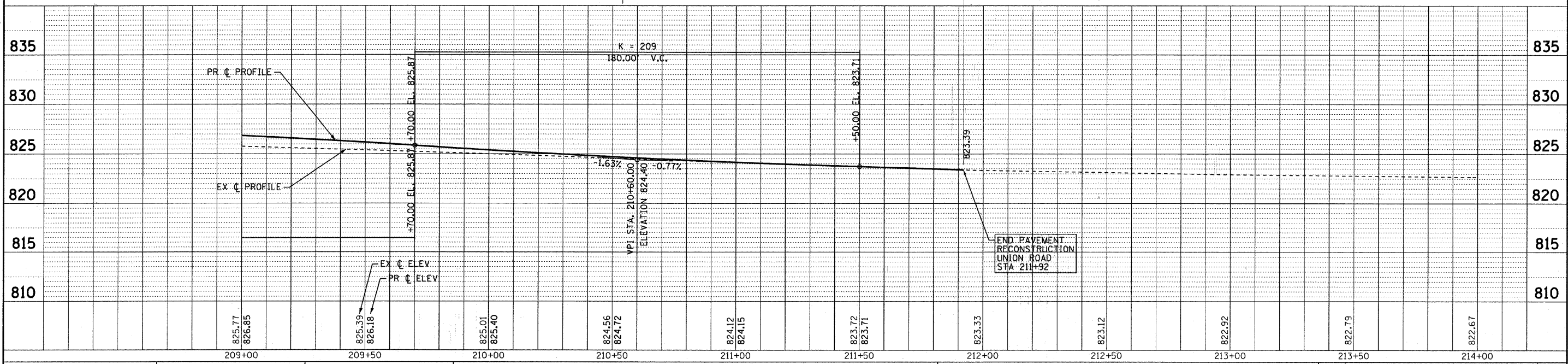

DESIGNED - CAC	REVISED - PER IDOT 10-08-10
DRAWN - BCD	REVISED -
CHECKED - MDW	REVISED -
DATE - 08/20/10	FILE - 070630-PH2-UNION-PP3.sht

**MCHENRY COUNTY DIVISION OF TRANSPORTATION**  
**UNION ROAD BRIDGE OVER**  
**SOUTH BRANCH OF KISHWAUKEE RIVER**

**PLAN AND PROFILE**

SCALE: H: 1"=20' V: 1"=5'

STA. 209+00 TO STA. 214+00

F.A.S. RTE. 0034	SECTION 06-00320-02-BR	COUNTY MCHENRY	TOTAL SHEETS 65	SHEET NO. 16
JOB NO. C-91-140-11		ILLINOIS FED. AID PROJECT		BRS-0034(107)
CONTRACT NO. 63536				