

BL058

K:\Bloomington\03088503\draw\sheet\FILE: 29_MALSR_EXH2.dwg
 LAYOUT: Layout1
 UPDATE BY: adroughan
 SURVEY BOOK #
 DATE: Tue 1/18/05 8:58am
 XREF DWG: reprf001.dwg
 EXT29_TOPO.DWG
 BMIBase.dwg
 PROPGEO.dwg
 CLNTINF.DWG
 TB.DWG

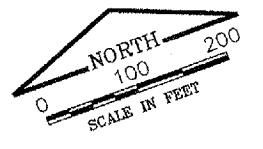

SCALES:
 1" = 100' HOR
 1" = 2' VER

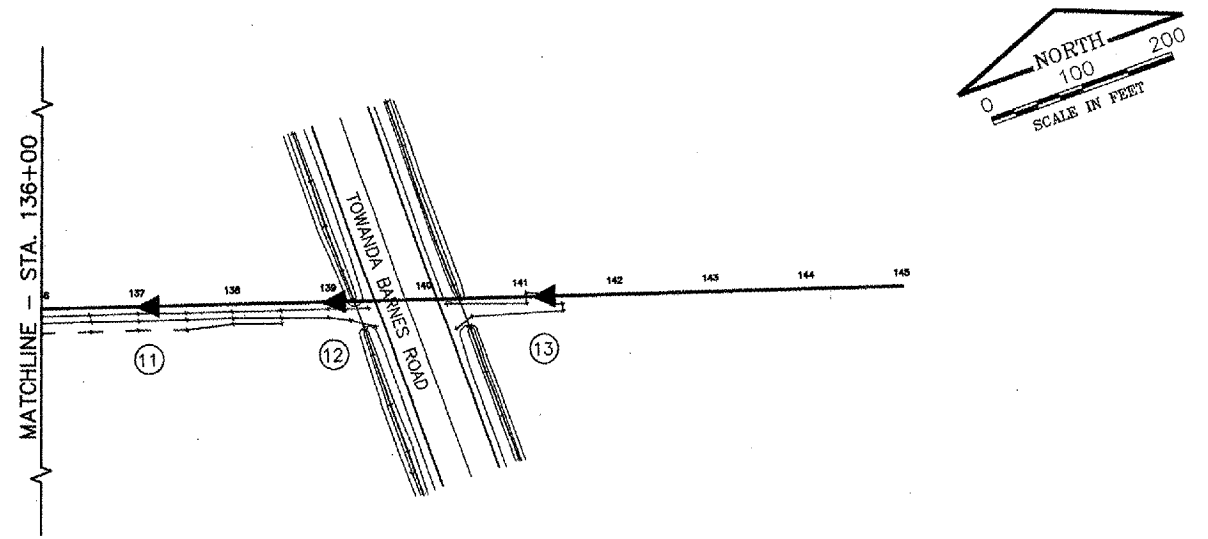
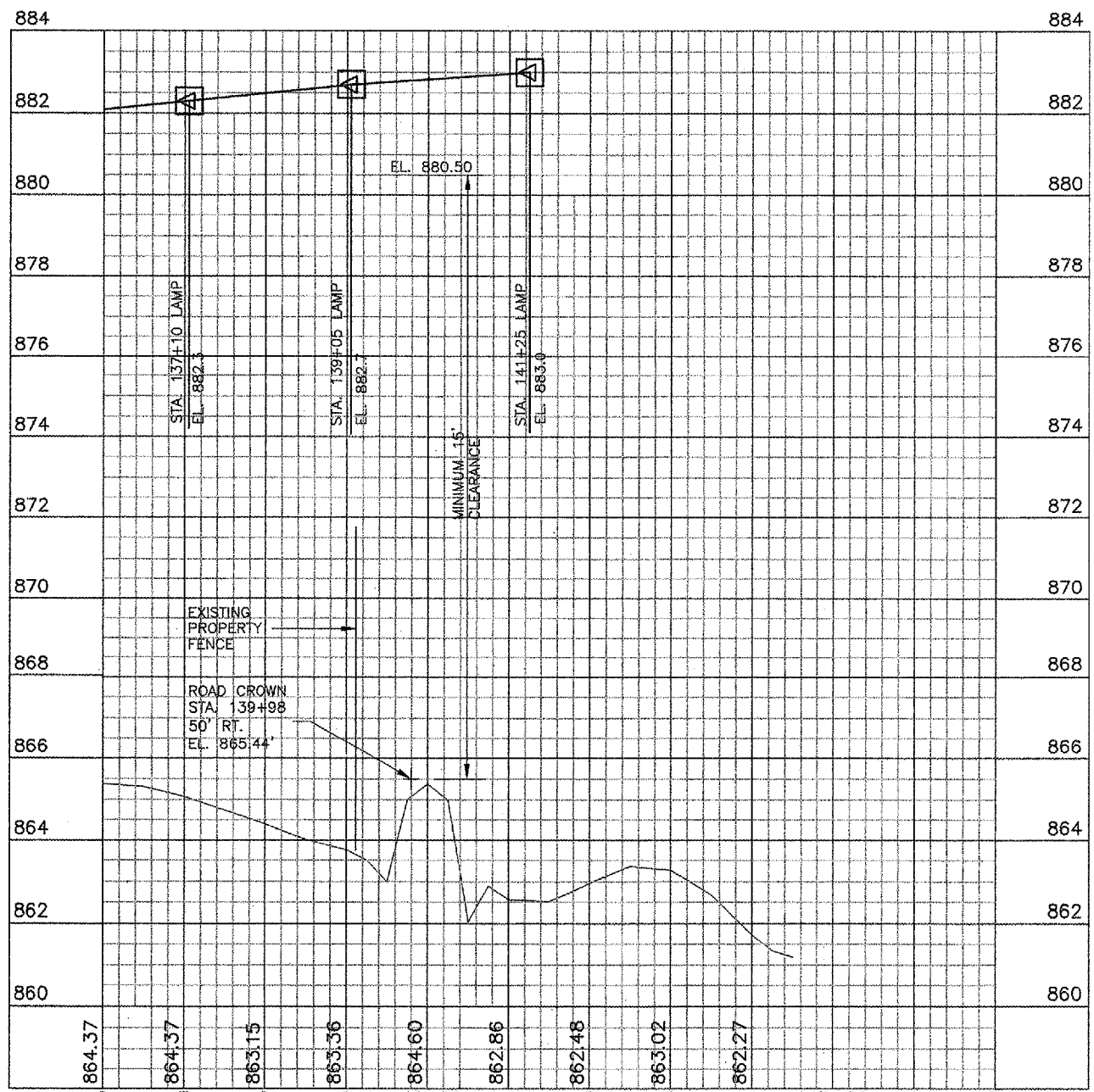

LIGHT STATION LOCATION TABLE

STATION NUMBER	RWY 29 STATION	MALSR STATION	OFFSET	LIGHT ELEVATION	AIMING ANGLE (DEGREES)	APPROX PROP. GRD/FOUND. ELEVATION	APPROX LIGHT TO FOUND. HT.
1	117+30	000+05	0	872.38	3.1	871.22	1.16
2	119+25	002+00	0	873.4	3.2	872.20	1.20
3	121+25	004+00	0	874.4	3.3	872.75	1.65
4	123+25	006+00	0	875.4	3.3	872.85	2.55
5	125+25	008+00	0	876.4	3.3	871.15	5.25
6A	127+25	010+00	28' LT	877.4	3.4	864.90	12.50
6B	127+25	010+00	0	877.4	3.4	865.85	11.55
6C	127+25	010+00	28' RT	877.4	3.4	865.10	12.30
7	129+25	012+00	0	878.4	3.4	864.30	14.10
8	131+25	014+00	0	879.4	3.6	863.75	15.65
9	133+20	015+95	0	880.4	6.0	864.35	16.05
10	135+15	017+90	0	881.4	6.0	865.30	16.10
11	137+10	019+85	0	882.3	6.0	864.35	17.95
12	139+05	021+80	0	882.7	6.0	863.75	18.95
13	141+25	024+00	0	883.0	6.0	862.70	20.30

NOTE:

1.) CONTRACTOR SHALL VERIFY PROPOSED FOUNDATION/GROUND ELEVATION PRIOR TO FINAL LIGHT TOWER PREPARATION.

REVISIONS

NUMBER	BY	DATE

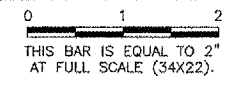

BLOOMINGTON-NORMAL AIRPORT AUTHORITY
CENTRAL ILLINOIS REGIONAL AIRPORT
BLOOMINGTON, ILLINOIS
INSTALL RUNWAY 29 MALSR
MALSR PLAN AND PROFILE 2



DESIGN BY:	TM
DRAWN BY:	CMT
CHECKED BY:	RW
APPROVED BY:	RW
DATE:	12/25/2004
JOB No:	03085-03-00