

F.A.U. RTE.	SECTION	COUNTY	TOTAL SHEETS	SHEET NO.
9182	00-00176-01-RS	ST. CLAIR	9	8
STA 474 + 00		TO STA 545 + 00		
FED. ROAD DIST. NO. 7		ILLINOIS		FED. AID URBAN
CONTRACT NO. 97238				

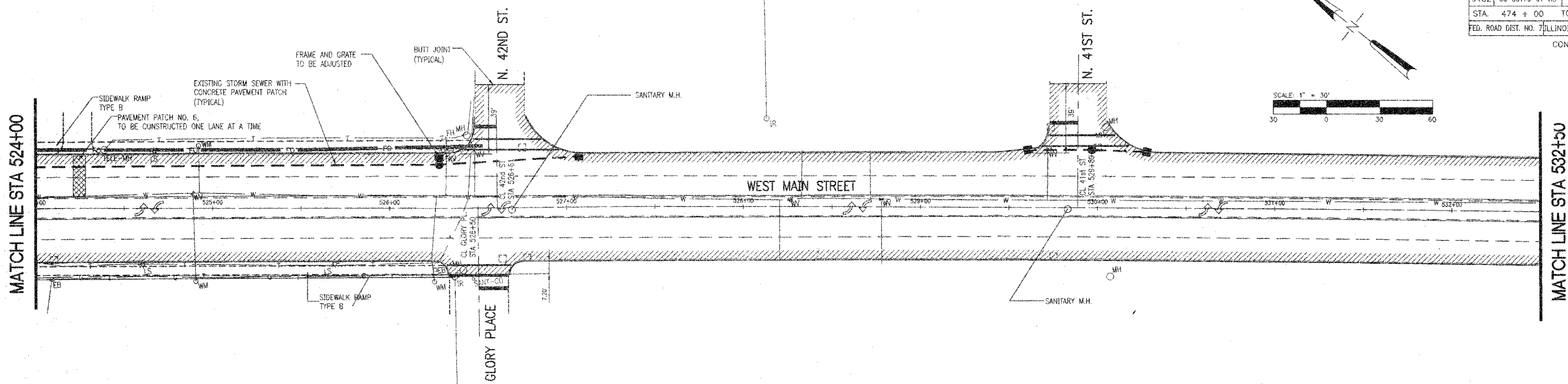

NOTE:
 THE CITY OF BELLEVILLE HAS RECENTLY CONSTRUCTED NEW STORM SEWERS WITH CONCRETE PAVEMENT TRENCH PATCHES. THE PATCHES ARE AT EXISTING PAVEMENT GRADE AND WILL REQUIRE PARTIAL DEPTH REMOVAL. THE APPROXIMATE LOCATION OF THE NEW SEWERS ARE SHOWN ON THE PLANS AND THE AREA OF PATCH REMOVAL IS INCLUDED IN THE TOTAL SQUARE YARDS OF BITUMINOUS SURFACE REMOVAL 1-1/2".

DATE	
BY	
SURVEYED	
PLAN	
NOTE BOOK ALIGNMENT CHECKED	
NO. _____	
CADD FILE NAME	

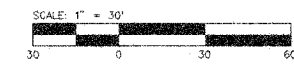
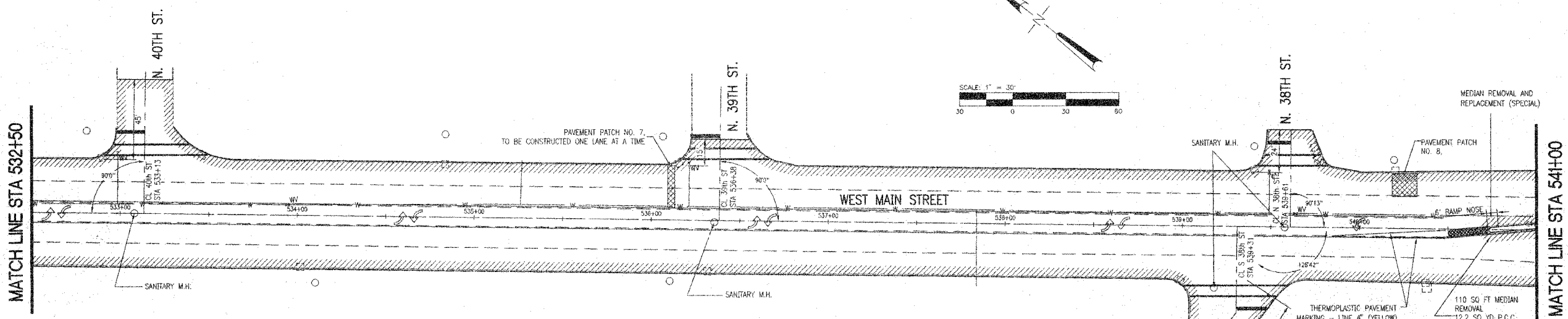

REVISIONS	
NAME	DATE

ILLINOIS DEPARTMENT OF TRANSPORTATION
PLAN SHEET
SHEET 4 OF 5
 F.A.U. 9182 (WEST MAIN ST.)
 SECTION 00-00176-01-RS - ST. CLAIR CO.
 SCALE: 1"=30'
 DATE: DECEMBER 28, 2004
 DRAWN BY: ORO
 CHECKED BY: RCY

LIMITS OF SURFACE COURSE REMOVAL AND BITUMINOUS CONCRETE SURFACE COURSE, SUPERPAVE