

F.A.U. RTE.	SECTION	COUNTY	TOTAL SHEETS	SHEET NO.
9182	00-00176-01-RS	ST. CLAIR	9	6
STA. 474 + 00	TO STA. 545 + 00			
FED. ROAD DIST. NO. 7	ILLINOIS	FED. AID URBAN		
CONTRACT NO. 97238				

DATE	BY	REVISION
SURVEYED, ALIGNED, CHECKED, AS BUILT, CADD FILE, NAME, NO.		
PLAN		
NOTE BOOK ALIGNMENT CHECKED, NO.		
CADD FILE, NAME, NO.		

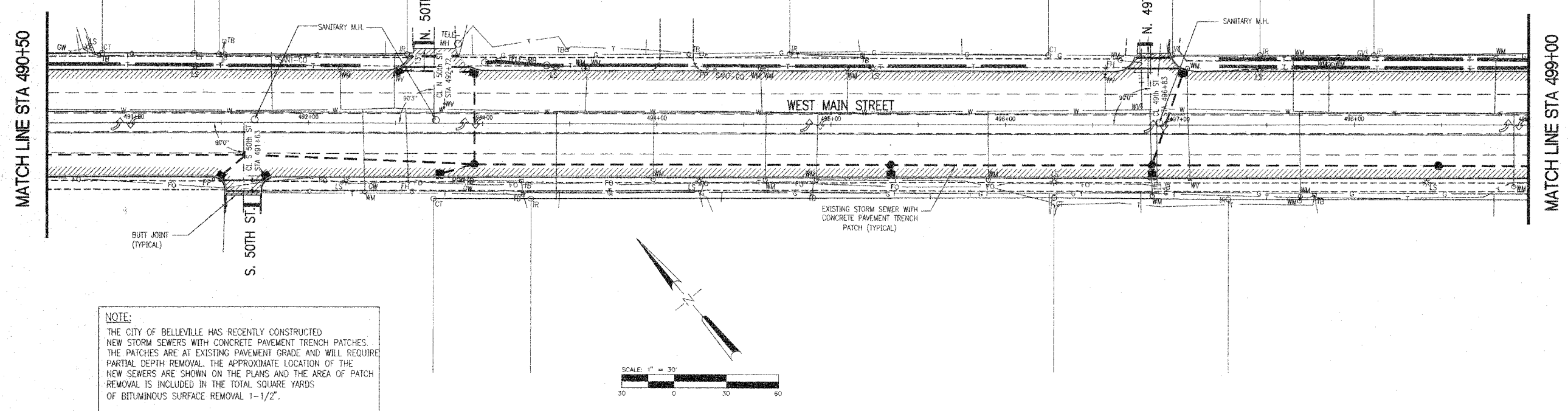

NOTE:
 THE CITY OF BELLEVILLE HAS RECENTLY CONSTRUCTED NEW STORM SEWERS WITH CONCRETE PAVEMENT TRENCH PATCHES. THE PATCHES ARE AT EXISTING PAVEMENT GRADE AND WILL REQUIRE PARTIAL DEPTH REMOVAL. THE APPROXIMATE LOCATION OF THE NEW SEWERS ARE SHOWN ON THE PLANS AND THE AREA OF PATCH REMOVAL IS INCLUDED IN THE TOTAL SQUARE YARDS OF BITUMINOUS SURFACE REMOVAL 1-1/2".

DATE	BY	REVISION
SURVEYED, ALIGNED, CHECKED, AS BUILT, CADD FILE, NAME, NO.		
PLAN		
NOTE BOOK ALIGNMENT CHECKED, NO.		
CADD FILE, NAME, NO.		

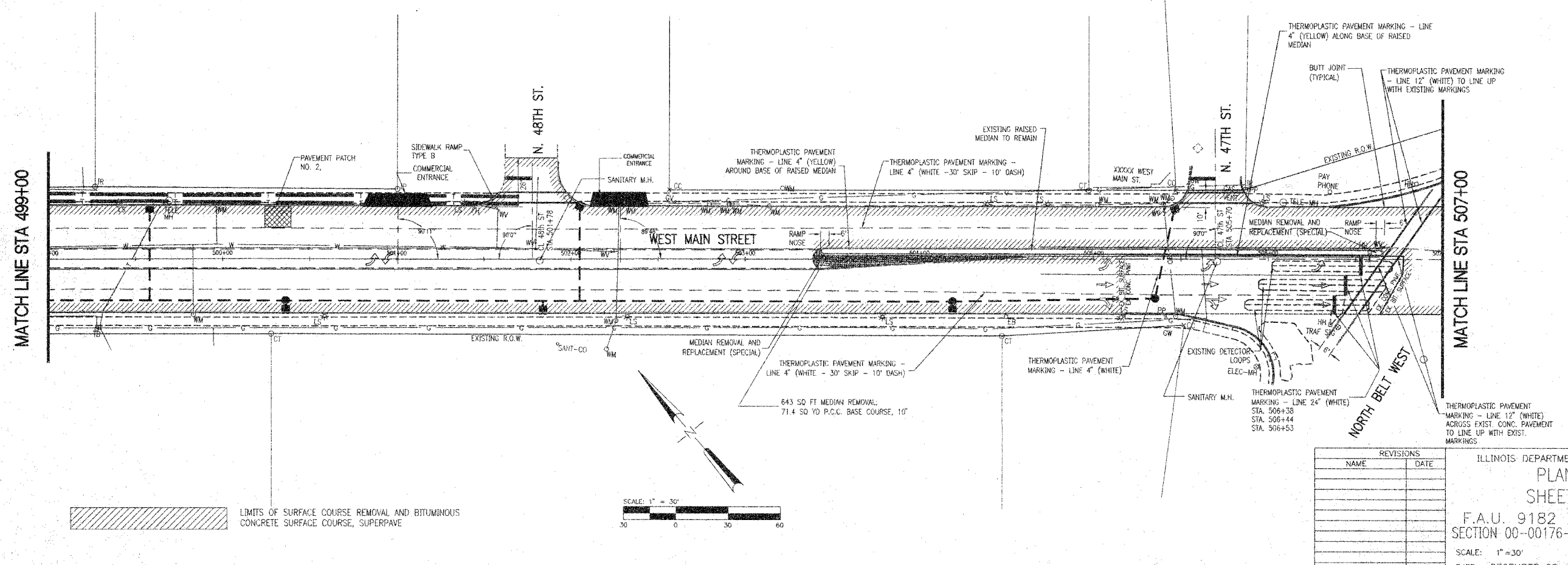

LIMITS OF SURFACE COURSE REMOVAL AND BITUMINOUS CONCRETE SURFACE COURSE, SUPERPAVE

REVISIONS	
NAME	DATE

ILLINOIS DEPARTMENT OF TRANSPORTATION
PLAN SHEET
SHEET 2 OF 5
 F.A.U. 9182 (WEST MAIN ST.)
 SECTION 00-00176-01-RS - ST. CLAIR CO.
 SCALE: 1"=30'
 DATE: DECEMBER 28, 2004
 DRAWN BY: CRO
 CHECKED BY: RCY