

ROUTE NO.	SECTION	COUNTY	TOTAL SHEETS	SHEET NO.
TR 447	*	Vermillion	16	12
FED. ROAD DIST. NO. 7		ILLINOIS FED. AID PROJECT		

#00-03128-00-BR

INTENDED SEQUENCE

1. PLACEMENT OF PERIMETER EROSION CONTROL BARRIER PRIOR TO COMMENCEMENT OF ANY WORK. SEE STANDARD 280001.
2. CONSTRUCTION OF NEW SUBSTRUCTURE.
3. REMOVAL OF THE EXISTING STRUCTURE.
4. CONSTRUCTION OF THE NEW SUPERSTRUCTURE.
5. THE PLACEMENT AND MAINTENANCE OF TEMPORARY EROSION CONTROLS.
6. FINAL GRADING AND SHAPING INCLUDING PLACEMENT OF AGGREGATE BASE COURSE & BITUMINOUS SURFACE.
7. REMOVAL AND PROPER CLEAN UP OF TEMPORARY EROSION CONTROLS.
8. PLACEMENT OF PERMANENT EROSION CONTROLS.

SW 1/4, SECTION 16, T 17 N, R 12 W, 2nd. P.M.

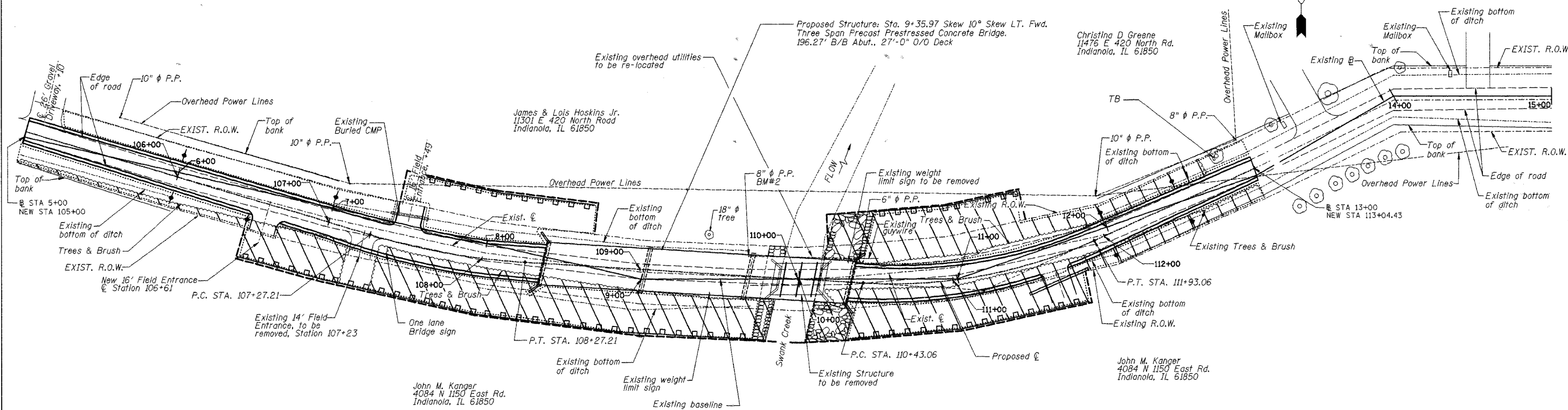
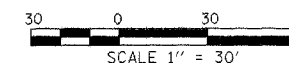

PERMANENT EROSION CONTROL



Grouted RipRap

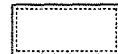

Seeding, Cl. 2 with Fertilizer and Mulch

TEMPORARY EROSION CONTROL



Temporary Ditch Check

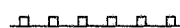

Perimeter Erosion Barrier

PERIMETER EROSION BARRIER

STA	OFFSET	TO	STA	OFFSET	LENGTH
106+50	80' RT		109+70	80' RT	320 FT
106+50	40' LT		108+70	40' LT	220 FT
107+40	80' LT		108+40	80' LT	100 FT
110+50	80' LT		111+50	80' LT	100 FT
110+30	80' RT		111+80	80' RT	150 FT
TOTAL = 890 FT					

TEMPORARY DITCH CHECKS

STA	OFFSET	QUANTITY
106+00	RT	1 EACH
106+00	LT	1 EACH
106+50	RT	1 EACH
107+00	LT	1 EACH
112+00	LT	1 EACH
112+00	RT	1 EACH
112+50	LT	1 EACH
112+50	RT	1 EACH
TOTAL		8 EACH

TEMPORARY EROSION CONTROL		
Bill of Materials		
Item	Unit	Quantity
Temporary Erosion Control Seeding	Pound	200
Temporary Ditch Checks	Each	8
Perimeter Erosion Barrier	Foot	890