

ROUTE NO.	SECTION	COUNTY	TOTAL SHEETS	SHEET NO.
C. H. 5	03-00027	TAZEWELL	24	19
FAS 467	-11-BR			
		ILLINOIS	PROJ. BRS-467(04)	

CONTRACT NO. 89361 Sheet 15 of 15

When cantilever forming brackets are used, the work shall be done according to Article 503.06, except as modified below and in the details shown on this sheet.

The finishing machine rails shall be placed on the top flange of the exterior beams.

The beams or girders, supporting cantilever forming brackets, shall be tied together at 4 foot intervals.

For Standard construction, or Stage Construction the Hardwood bracing materials shall be placed as shown between webs of beams in each bay.

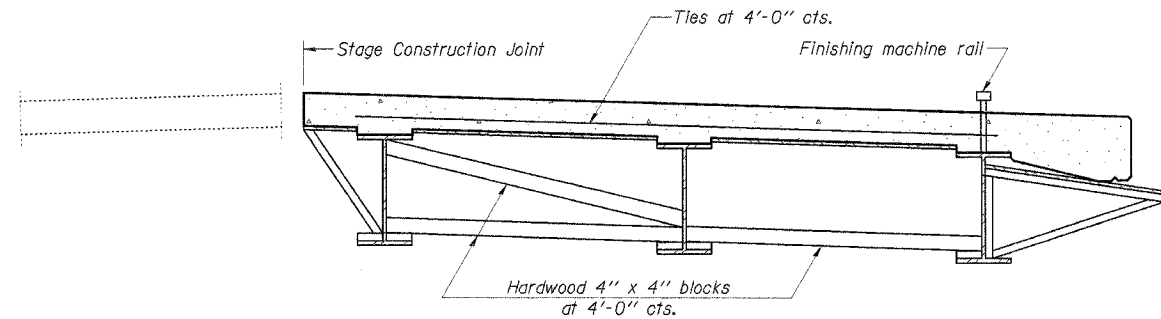

FORM BRACES FOR
STAGE CONSTRUCTION

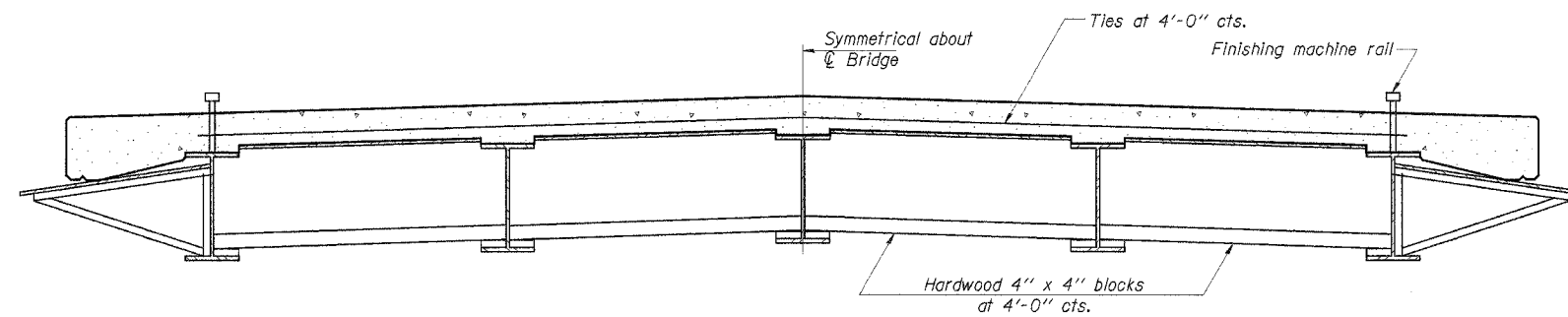

FORM BRACES FOR
STANDARD CONSTRUCTION

DESIGNED	S.F.M.
CHECKED	P.S.L. & F.J.S.
DRAWN	K.T.R., J.P.S. & S.A.P.
CHECKED	S.F.M.
SB-1	9-01-03

STANDARDS\GENERAL\BPLAN.DGN 1:1 7-17-98

CANTALIVER FORMING BRACKETS
SECTION 03-00027-11-BR
COUNTY HIGHWAY 5
TAZEWELL COUNTY
STA. 61+32

4440 ASH GROVE
SPRINGFIELD, IL 62711
(217) 793-6600
oasinc@amvid.com

OZYURT AND STONE, INC.
CONSULTING ENGINEERS

JOB NO.: 0313
FILE: CANTBRACK.DGN
DATE: 12/30/04