

F.A.U. RTE.	SECTION	COUNTY	TOTAL SHEETS	SHEET NO.
2585 00-00068-01-WR		COOK	145	56
STA. 274+70 TO STA. 302+00				
FED. ROAD DIST. NO.	ILLINOIS	FED. AID PROJECT		
CONTRACT NUMBER 83785				

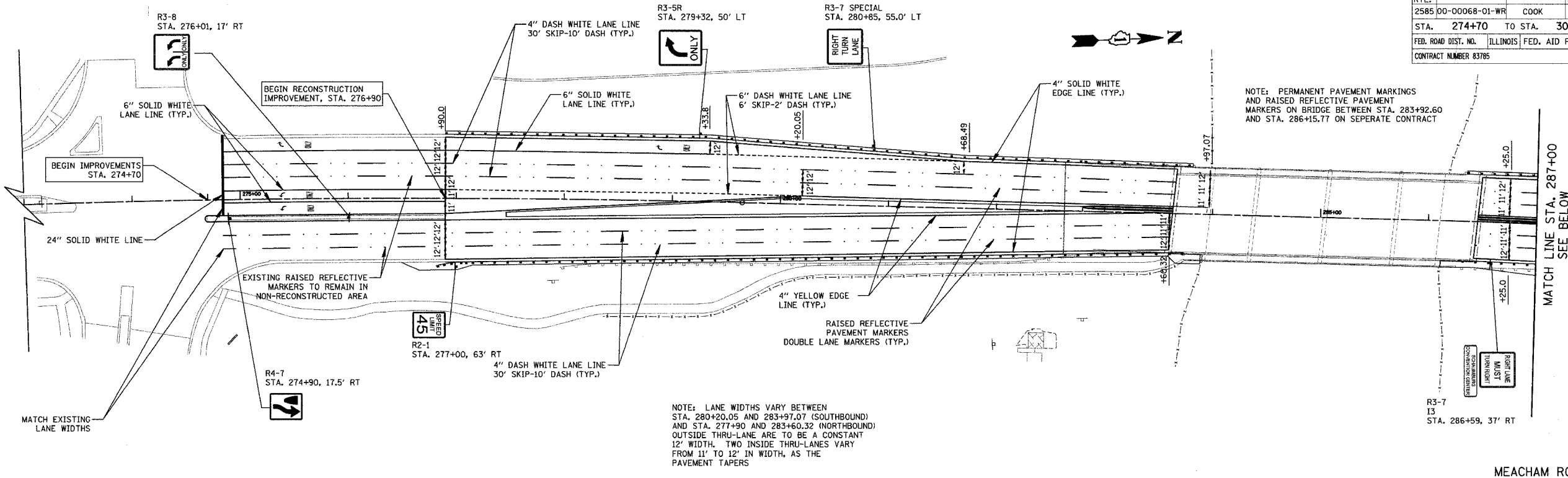

NOTE: PERMANENT PAVEMENT MARKINGS AND RAISED REFLECTIVE PAVEMENT MARKERS ON BRIDGE BETWEEN STA. 283+92.60 AND STA. 286+15.77 ON SEPERATE CONTRACT

NOTE: LANE WIDTHS VARY BETWEEN STA. 280+20.05 AND 283+97.07 (SOUTHBOUND) AND STA. 277+90 AND 283+60.32 (NORTHBOUND) OUTSIDE THRU-LANE ARE TO BE A CONSTANT 12' WIDTH. TWO INSIDE THRU-LANES VARY FROM 11' TO 12' IN WIDTH, AS THE PAVEMENT TAPERS

MEACHAM ROAD

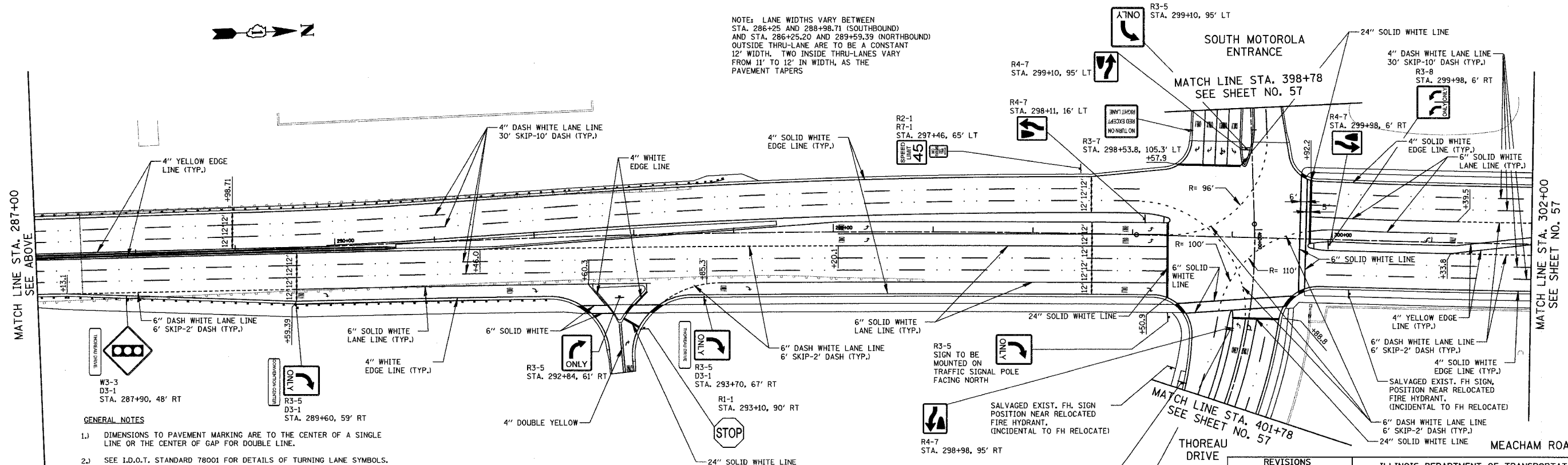

NOTE: LANE WIDTHS VARY BETWEEN STA. 286+25 AND 288+98.71 (SOUTHBOUND) AND STA. 286+25.20 AND 289+59.39 (NORTHBOUND) OUTSIDE THRU-LANE ARE TO BE A CONSTANT 12' WIDTH. TWO INSIDE THRU-LANES VARY FROM 11' TO 12' IN WIDTH, AS THE PAVEMENT TAPERS

MEACHAM ROAD

- GENERAL NOTES**
- 1.) DIMENSIONS TO PAVEMENT MARKING ARE TO THE CENTER OF A SINGLE LINE OR THE CENTER OF GAP FOR DOUBLE LINE.
 - 2.) SEE I.D.O.T. STANDARD 78001 FOR DETAILS OF TURNING LANE SYMBOLS.
 - 3.) CONSTRUCTION SIGNING AND TEMPORARY RELOCATION OF EXISTING TRAFFIC SIGNS WILL BE DONE BY THE CONTRACTOR.
 - 4.) ALL PERMANENT PAVEMENT MARKING SHALL BE PAINT ALL TEMPORARY PAVEMENT MARKING SHALL BE PAINT.
 - 5.) LOCATIONS AND DIMENSIONS SHOWN FOR PAVEMENT MARKING ARE APPROXIMATE. EXACT LOCATIONS AND DIMENSIONS SHALL BE DETERMINED BY THE ENGINEER.
 - 6.) RAISED REFLECTIVE MARKERS SHALL BE FIELD ADJUSTED TO BE LOCATED IN THE CENTER OF THE 30' GAP OF A 30'/10' SKIP/DASH LINE.

REVISIONS	
NAME	DATE

ILLINOIS DEPARTMENT OF TRANSPORTATION
**MEACHAM ROAD
 PAVEMENT MARKING AND SIGNING PLANS**
 STATION 276+90 TO STATION 302+00
 SCALE IN FEET
 DATE 12/20/04
 DESIGNED BY KRY
 CHECKED BY RRM