

FAP ROUTE	SECTION	COUNTY	TOTAL SHEETS	SHEET NO.
586	60R-2, 37R-1	MADISON	502	158
STA. 680+00		TO STA. 686+00		
CONTRACT NO.: 76301				

PLAN	SURVEYED	DATE
NO.	BY	

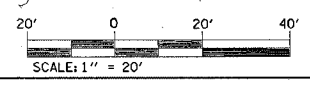
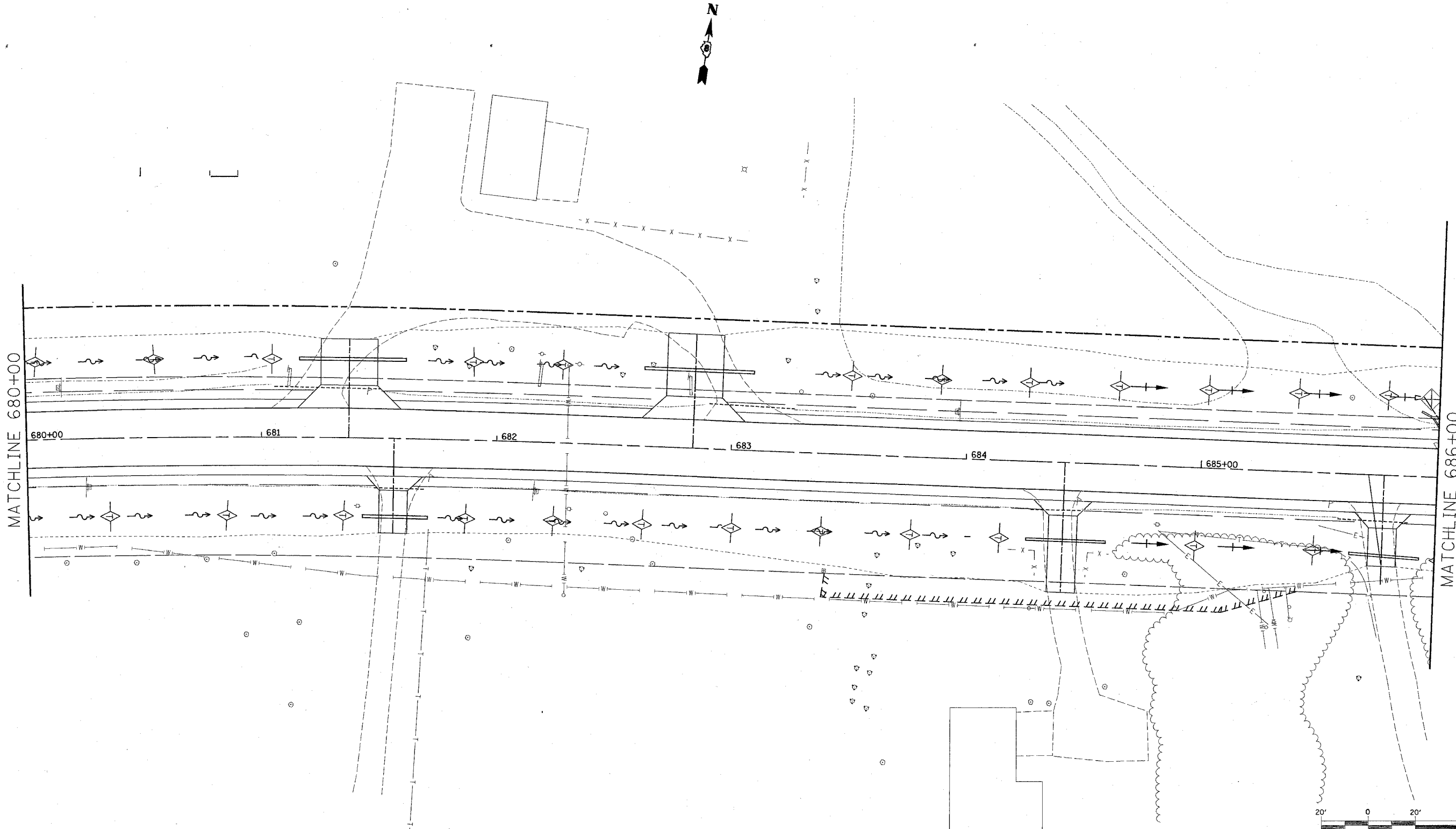

REVISIONS	
NAME	DATE

ILLINOIS DEPARTMENT OF TRANSPORTATION
 STORM WATER POLLUTION PREVENTION PLANS
 FAP 586
 SECTION 60R-2, 37R-1
 MADISON COUNTY
 DRAWN BY:

7/1/2004
 Thursday, July 01, 2004 @ 2:36:17 PM
 c:\projects\ed\5999a\plan\p248a.dgn LV1-63
 c:\projects\ed\5999a\plan\p248b.dgn LV1-63
 c:\projects\ed\5999a\plan\p248c.dgn LV1-63
 c:\projects\ed\5999a\plan\p248d.dgn LV1-63
 c:\projects\ed\5999a\plan\p248e.dgn LV1-63
 c:\projects\ed\5999a\plan\p248f.dgn LV1-63
 c:\projects\ed\5999a\plan\p248g.dgn LV1-63
 c:\projects\ed\5999a\plan\p248h.dgn LV1-63
 c:\projects\ed\5999a\plan\p248i.dgn LV1-63
 c:\projects\ed\5999a\plan\p248j.dgn LV1-63
 c:\projects\ed\5999a\plan\p248k.dgn LV1-63
 c:\projects\ed\5999a\plan\p248l.dgn LV1-63
 c:\projects\ed\5999a\plan\p248m.dgn LV1-63
 c:\projects\ed\5999a\plan\p248n.dgn LV1-63
 c:\projects\ed\5999a\plan\p248o.dgn LV1-63
 c:\projects\ed\5999a\plan\p248p.dgn LV1-63
 c:\projects\ed\5999a\plan\p248q.dgn LV1-63
 c:\projects\ed\5999a\plan\p248r.dgn LV1-63
 c:\projects\ed\5999a\plan\p248s.dgn LV1-63
 c:\projects\ed\5999a\plan\p248t.dgn LV1-63
 c:\projects\ed\5999a\plan\p248u.dgn LV1-63
 c:\projects\ed\5999a\plan\p248v.dgn LV1-63
 c:\projects\ed\5999a\plan\p248w.dgn LV1-63
 c:\projects\ed\5999a\plan\p248x.dgn LV1-63
 c:\projects\ed\5999a\plan\p248y.dgn LV1-63
 c:\projects\ed\5999a\plan\p248z.dgn LV1-63