

FAP ROUTE	SECTION	COUNTY	TOTAL SHEETS	SHEET NO.
586	60R-2, 37R-1	MADISON	502	138
STA. 542+00		TO STA. 548+00		
EXISTING CONDITIONS: 76301				

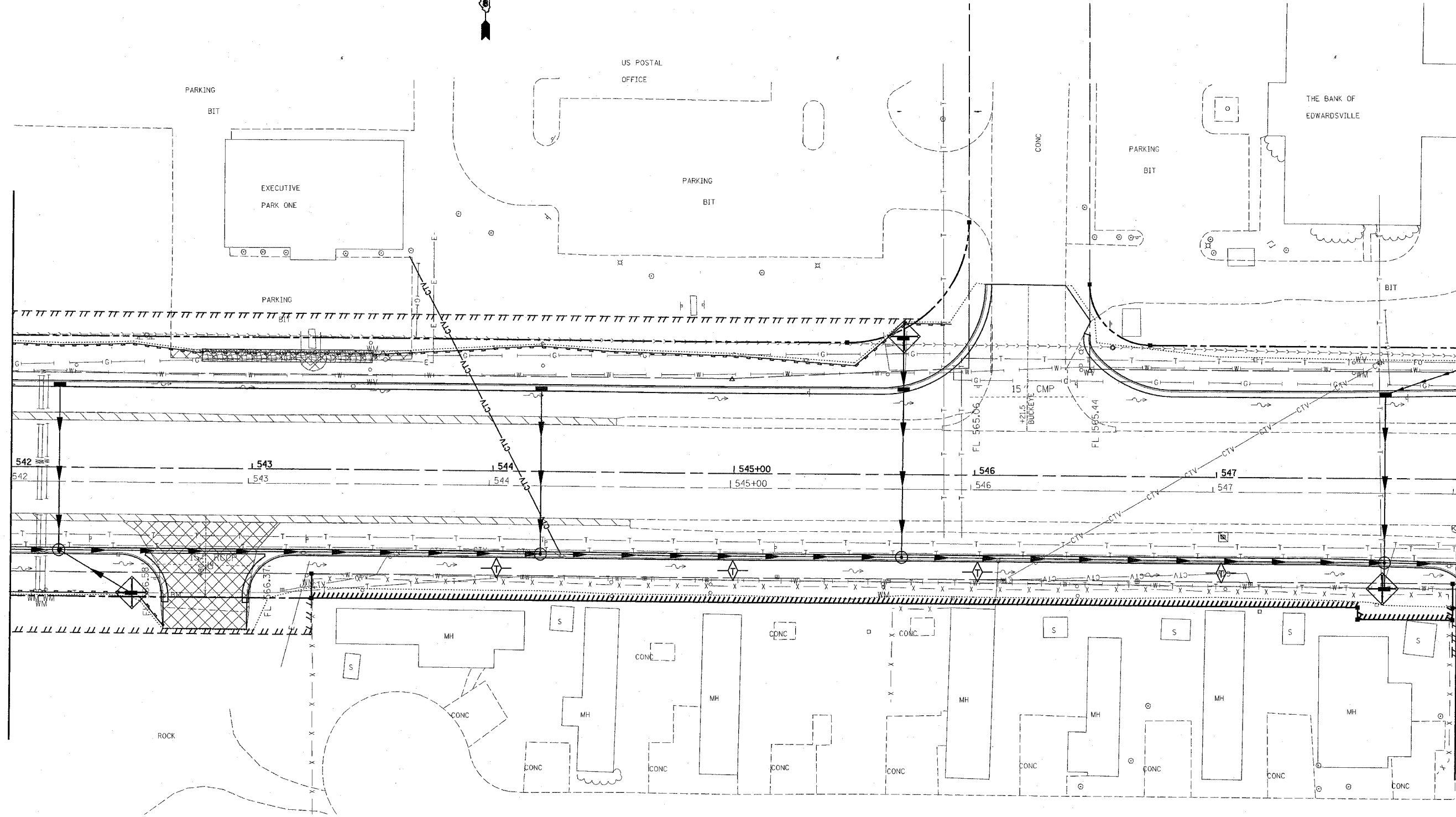

MATCHLINE STA. 542+00

MATCHLINE STA. 548+00



PLAN	DATE	BY

7/2/2004
 Friday July 02, 2004 @ 8:30:59 AM
 C:\projects\61699\plan\p1-065.dgn LV1-63
 C:\projects\61699\plan\p1-065.dgn LV2-63
 C:\projects\61699\plan\p1-065.dgn LV3-63
 C:\projects\61699\plan\p1-065.dgn LV4-63
 C:\projects\61699\plan\p1-065.dgn LV5-63
 C:\projects\61699\plan\p1-065.dgn LV6-63
 C:\projects\61699\plan\p1-065.dgn LV7-63
 C:\projects\61699\plan\p1-065.dgn LV8-63
 C:\projects\61699\plan\p1-065.dgn LV9-63
 C:\projects\61699\plan\p1-065.dgn LV10-63
 C:\projects\61699\plan\p1-065.dgn LV11-63
 C:\projects\61699\plan\p1-065.dgn LV12-63

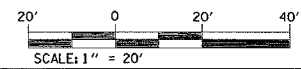

ILLINOIS DEPARTMENT OF TRANSPORTATION
STORM WATER POLLUTION PREVENTION PLAN
 FAP ROUTE 586
 SECTION 60R-2, 37R-1
 MADISON COUNTY

DRAWN BY:

REVISIONS	
NAME	DATE

PLOT DATE: Friday July 02, 2004 @ 8:30:59 AM