

FAP ROUTE	SECTION	COUNTY	TOTAL SHEETS	SHEET NO.
586	60R-2, 37R-1	MADISON	502	125
STA. _____ TO STA. _____		CONTRACT NO.: 76301		

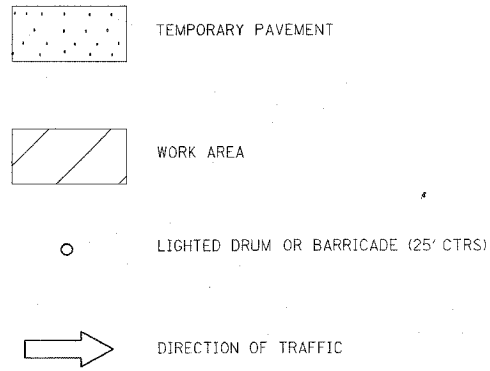

PLAN	DATE	BY
REVISION		
NO.		
DATE		
BY		
DATE		
BY		
DATE		

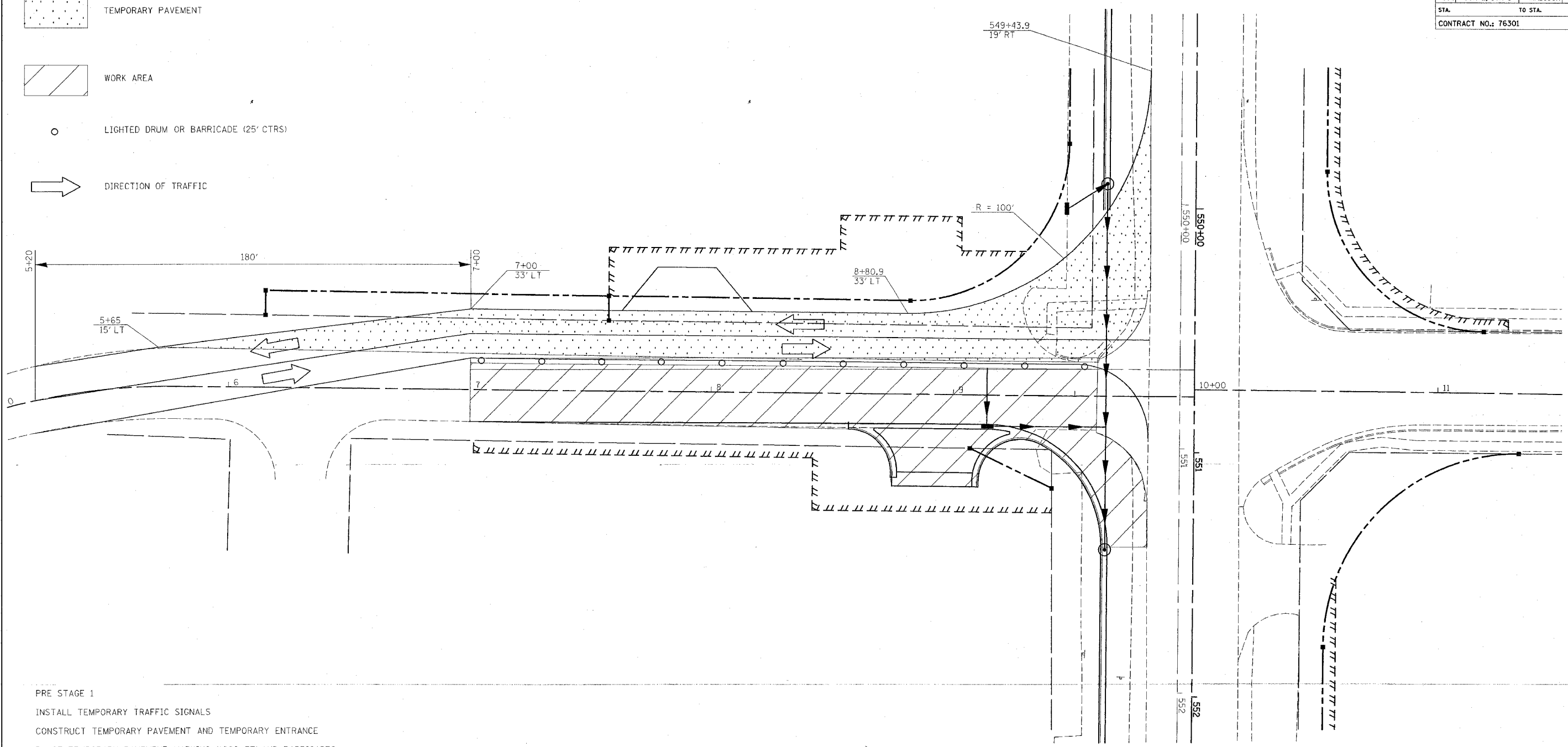

- PRE STAGE 1
- INSTALL TEMPORARY TRAFFIC SIGNALS
  - CONSTRUCT TEMPORARY PAVEMENT AND TEMPORARY ENTRANCE
  - PLACE TEMPORARY PAVEMENT MARKING (1020 FT) AND BARRICADES
  - SHIFT TRAFFIC

- STAGE 1
- REMOVE EXISTING PAVEMENT
  - INSTALL CURB & GUTTER, STORM SEWER, INLET AND ENTRANCE
  - PLACE PCC PAVEMENT
  - PLACE TEMPORARY PAVEMENT MARKING FOR STAGE 2 (595 FT)

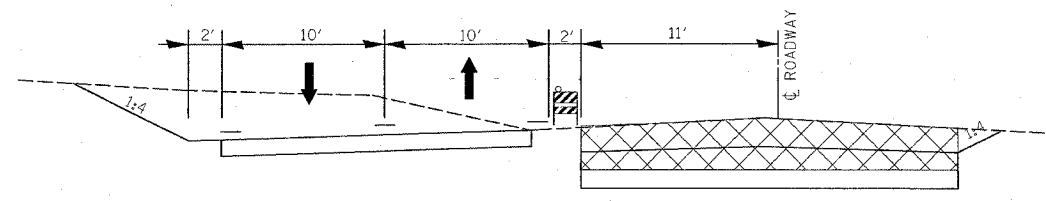

NOTE: CONTRACTOR SHALL MAINTAIN POSITIVE DRAINAGE AT THE PROPOSED INLETS WITH A METHOD APPROVED OF BY THE ENGINEER. COST TO BE INCLUDED IN 'TRAFFIC CONTROL AND PROTECTION (SPECIAL) LOCATION NO. 1'.

THE RAISED MEDIANS ON IL 162 SHALL NOT BE CONSTRUCTED UNTIL ALL PERMANENT ENTRANCES LOCATED ALONG RIGGINS RD ARE COMPLETED. ACCESS SHALL BE PROVIDED TO THE BANK AND THE PLUMBERS SUPPLY VIA THEIR ENTRANCES ON IL 162 FOR THE DURATION OF THE RIGGINS RD RECONSTRUCTION. COST OF COMPLYING WITH THIS NOTE SHALL NOT BE PAID FOR SEPARATELY, BUT WILL BE INCLUDED IN THE COST FOR 'TRAFFIC CONTROL AND PROTECTION (SPECIAL) LOCATION NO. 1'.

TEMPORARY PAVEMENT

BITUMINOUS CONCRETE SURFACE COURSE, SUPERPAVE, MIX 'C', N50 - 3" = 158 TON

AGGREGATE BASE COURSE TYPE B, 8" = 940 SQ YD

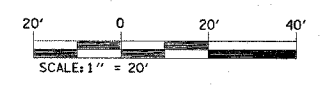

REVISIONS	
NAME	DATE

ILLINOIS DEPARTMENT OF TRANSPORTATION

**STAGE CONSTRUCTION**

**STAGE 1**

**RIGGINS RD.**

FAP ROUTE 586  
SECTION 60R-2, 37R-1  
MADISON COUNTY

DRAWN BY: \_\_\_\_\_