

FAP RTE.	SECTION	COUNTY	TOTAL SHEETS	SHEET NO.
586	60R-2, 37R-1	MADISON	502	118
STA. 680+00 TO STA. 686+00				
CONTRACT NO.: 76301				

PLAN	SURVEYED	DATE
	PLOTTED	
	REVISIONS	
	BY	
	NO.	

PROFILE	SURVEYED	DATE
	PLOTTED	
	REVISIONS	
	BY	
	NO.	

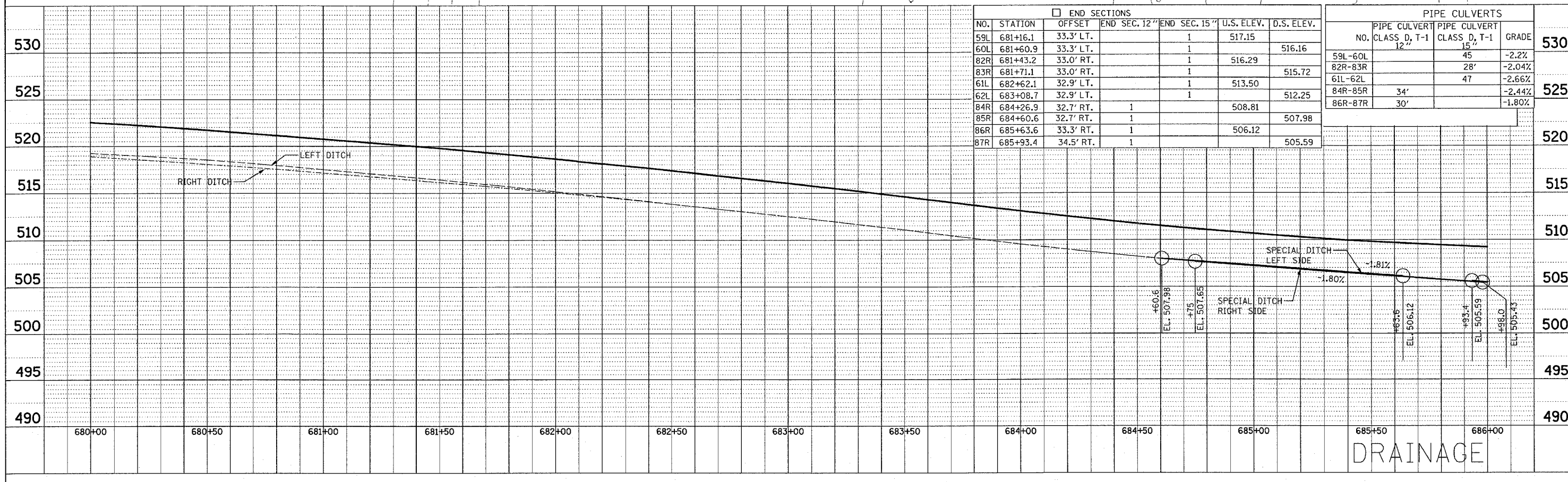
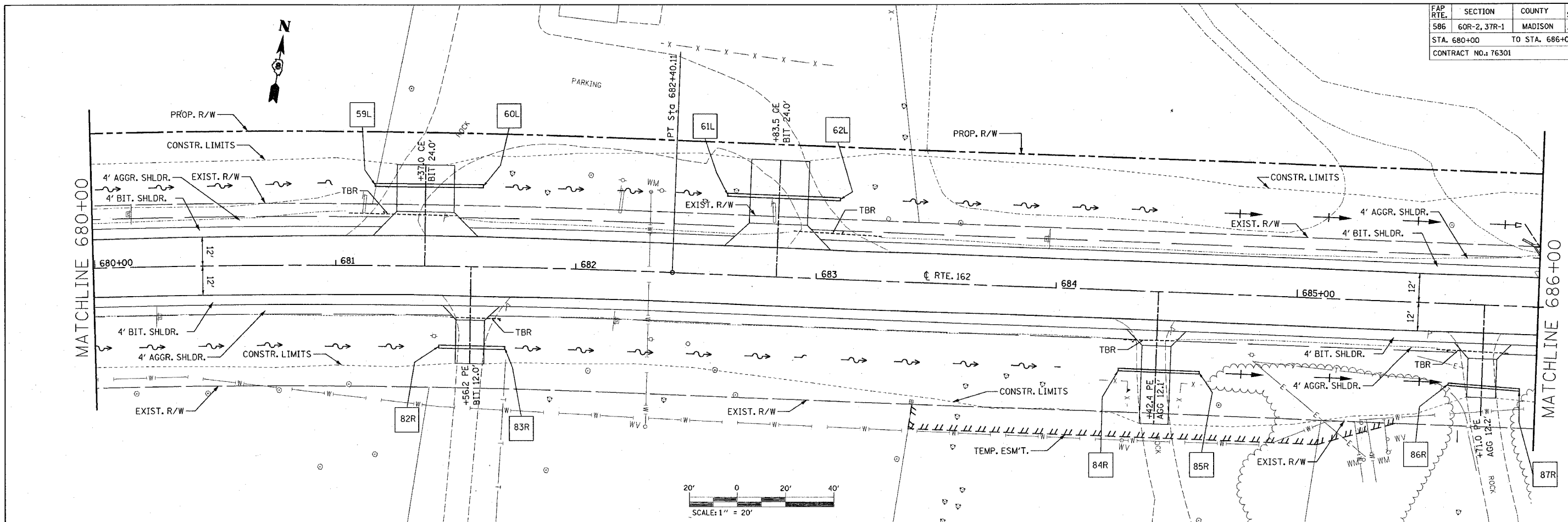

END SECTIONS					
NO.	STATION	OFFSET	END SEC. 12"	END SEC. 15"	U.S. ELEV. D.S. ELEV.
59L	681+16.1	33.3' LT.		1	517.15 516.16
60L	681+60.9	33.3' LT.		1	516.29 515.72
82R	681+43.2	33.0' RT.		1	513.50 512.25
83R	681+71.1	33.0' RT.		1	508.81 507.98
61L	682+62.1	32.9' LT.		1	506.12 505.59
62L	683+08.7	32.9' LT.		1	
84R	684+26.9	32.7' RT.		1	
85R	684+60.6	32.7' RT.		1	
86R	685+63.6	33.3' RT.		1	
87R	685+93.4	34.5' RT.		1	

PIPE CULVERTS				
NO.	CLASS D, T-1	PIPE CULVERT CLASS D, T-1	GRADE	
59L-60L	12"	45	-2.2%	530
82R-83R	28'	28'	-2.04%	
61L-62L	47	47	-2.66%	
84R-85R	34'	34'	-2.44%	525
86R-87R	30'	30'	-1.80%	

DRAINAGE