

FAP ROUTE	SECTION	COUNTY	TOTAL SHEETS	SHEET NO.
586	60R-2,37R-1	MADISON	502	87
STA. 506+00 TO STA. 512+00				
CONTRACT NO. 76301				

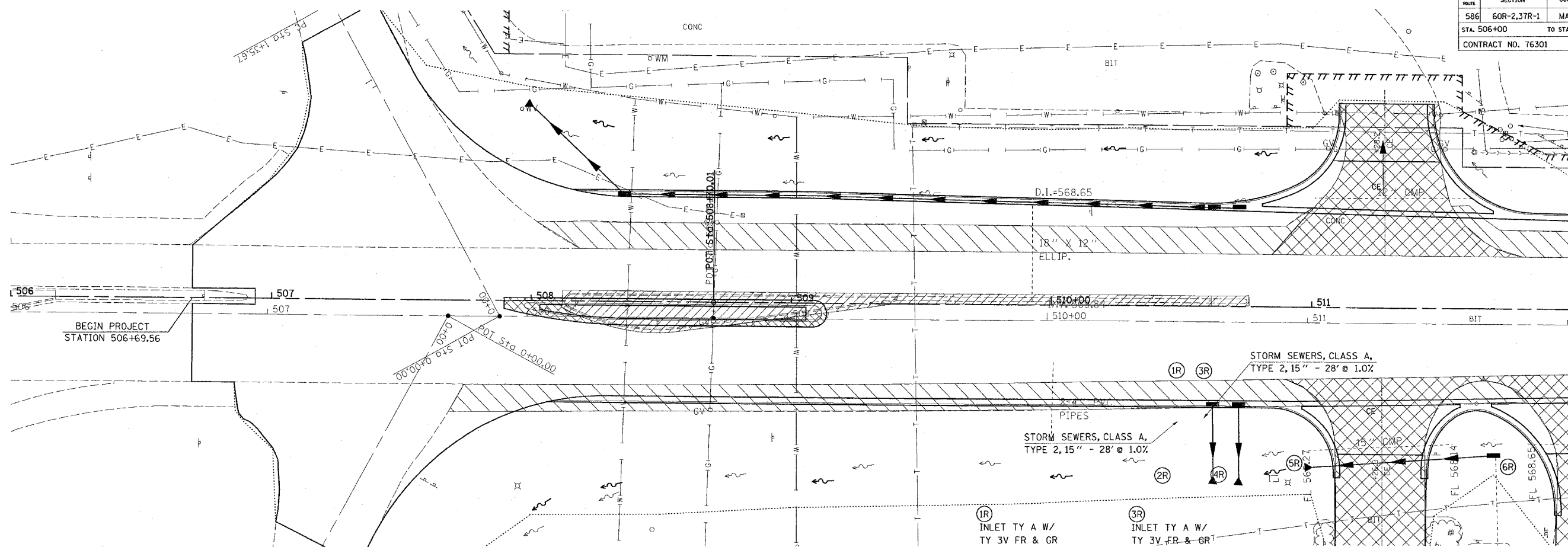

MATCHLINE STA. 512+00

R = RIGHT
L = LEFT
M = MEDIAN

GRADE PROPOSED DITCH TO MEET EXISTING DITCH

- 1R INLET TY A W/ TY 3V FR & GR STA. 510+62.11, 37.8' RT. GRATE ELEV. = 571.29 FL ELEV. = 568.17
- 2R END SECTION 15" STA. 510+48.7, 65' RT. FL ELEV. = 567.89
- 3R INLET TY A W/ TY 3V FR & GR STA. 510+77.11, 37.8' RT. GRATE ELEV. = 571.29 FL ELEV. = 568.25
- 4R END SECTION 15" STA. 510+58.7, 65' RT. FL ELEV. = 567.97
- 5R END SECTION, 15" STA. 511+00, 61' RT. FL ELEV. = 568.24
- 6R INLET TY A W/ TY 8 FR & GR STA. 511+71, 56' RT. GRATE ELEV. = 570.23 FL ELEV. = 568.82

PROPOSED DITCH PROFILE - RIGHT

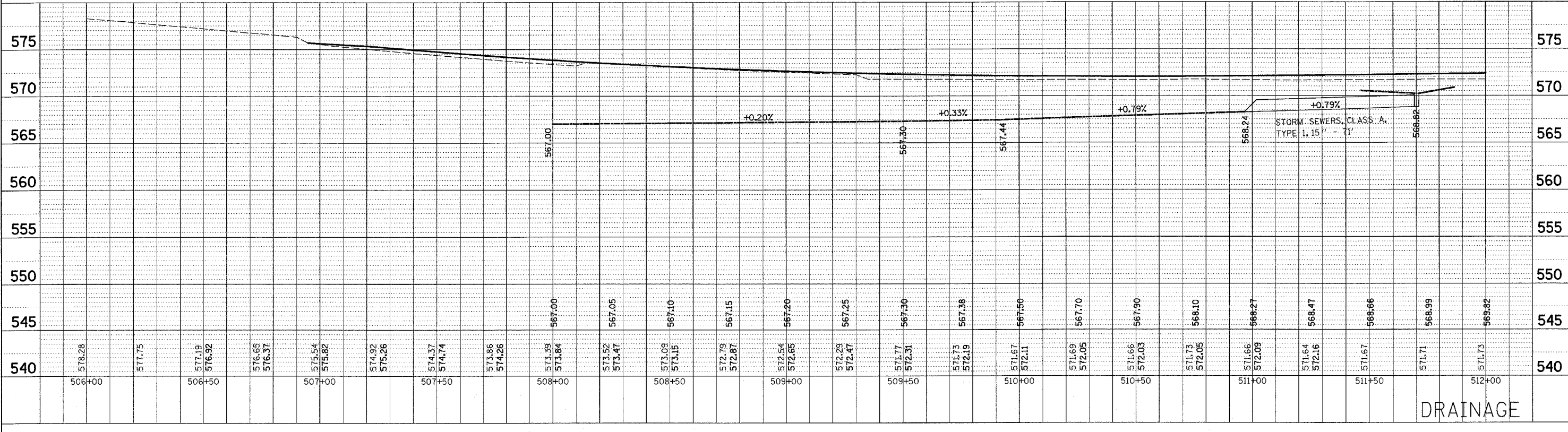
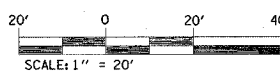

DRAINAGE

DATE	BY

NO.	DATE	BY	DESCRIPTION

NO.	DATE	BY	DESCRIPTION