

STATE OF ILLINOIS
DEPARTMENT OF TRANSPORTATION

ROUTE NO.	SECTION	COUNTY	SHEET NO.	SHEET NO.
F.A.P. 312	71BR	RANDOLPH	42	31 SHEETS
FED. ROAD DIST. NO. 7	ILLINOIS	FED. AID PROJECT		

Contract No. 76125

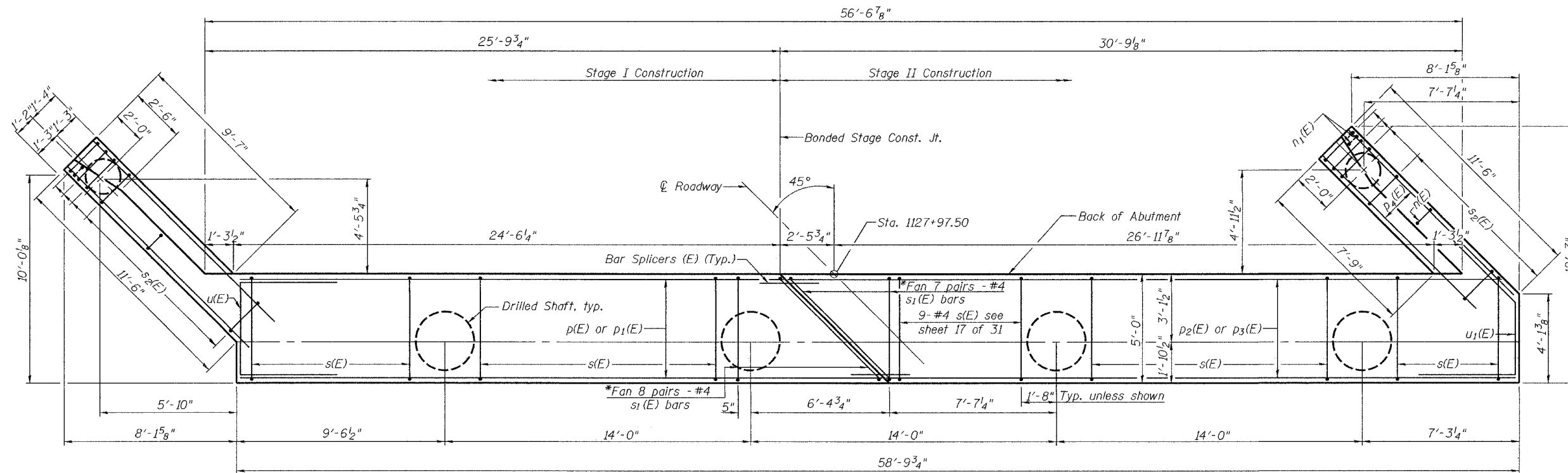

PLAN-PILE CAP

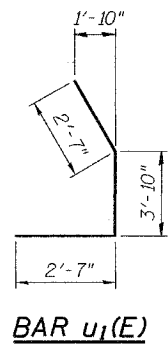
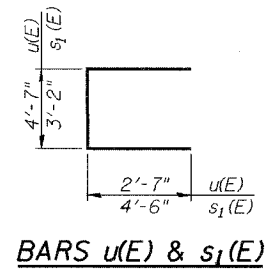
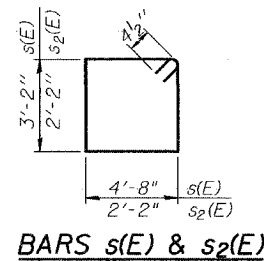
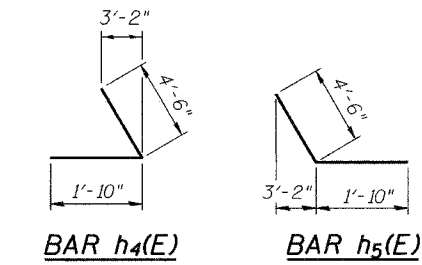

MIN. BAR LAP
#4 bar = 1'-8"

*Use 2 1/2" minimum clear distance between s₁(E) bars.

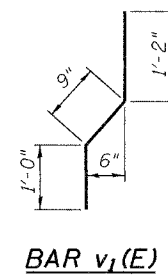
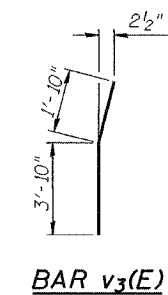
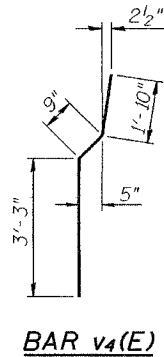
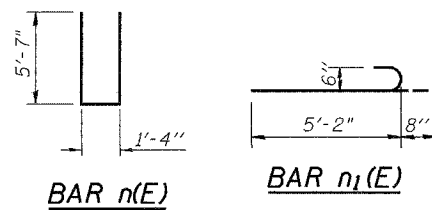

**SOUTH ABUTMENT
BILL OF MATERIAL**

Bar	No.	Size	Length	Shape
h(E)	4	#6	25'-5"	—
h ₁ (E)	6	#5	25'-5"	—
h ₂ (E)	4	#6	30'-6"	—
h ₃ (E)	6	#5	30'-6"	—
h ₄ (E)	10	#5	6'-4"	—
h ₅ (E)	10	#5	6'-4"	—
h ₆ (E)	20	#4	11'-2"	—
h ₇ (E)	12	#4	11'-2"	—
n(E)	18	#6	12'-6"	—
n ₁ (E)	12	#6	5'-10"	—
n ₂ (E)	44	#9	8'-9"	—
n ₃ (E)	12	#7	5'-8"	—
p(E)	9	#9	29'-7"	—
p ₁ (E)	8	#8	29'-7"	—
p ₂ (E)	9	#9	33'-6"	—
p ₃ (E)	8	#8	33'-6"	—
p ₄ (E)	12	#7	11'-2"	—
s(E)	64	#4	16'-5"	—
s ₁ (E)	30	#4	12'-2"	—
s ₂ (E)	24	#4	9'-5"	—
u(E)	4	#6	9'-9"	—
u ₁ (E)	4	#6	9'-0"	—
v(E)	114	#4	4'-7"	—
v ₁ (E)	57	#4	2'-11"	—
v ₂ (E)	57	#5	2'-3"	—
v ₃ (E)	6	#6	5'-8"	—
v ₄ (E)	18	#6	5'-10"	—
v ₅ (E)	24	#6	6'-0"	—
v ₆	12	#7	23'-7"	—
v ₇	44	#9	32'-1"	—
sp	4	#5	33'-10"	—
sp ₁	2	#5	24'-1"	—
Structure Excavation		Cu. Yd.	174.9	
Concrete Structures		Cu. Yd.	59.8	
Reinforcement Bars, Epoxy Coated		Pound	8730	
Reinforcement Bars		Pound	9510	
Drilled Shaft in Soil 24"		Foot	38.9	
Drilled Shaft in Soil 42"		Foot	77.8	
Drilled Shaft in Rock 18"		Foot	9.0	
Drilled Shaft in Rock 36"		Foot	52.0	

Reinforcement bars designated (E) shall be epoxy coated.
*Length is height of spiral.

DESIGNED	T.L. Kurtenbach
CHECKED	J.E. Kramer
DRAWN	A.M. Selber
CHECKED	JEK/TLK

EXAMINED	January 26, 2005	Thomas J. Domagalak
PASSED		Ralph E. Anderson

SOUTH ABUTMENT
F.A.P. RT. 312 - SEC. 71BR
RANDOLPH COUNTY
STATION 1128+90
STRUCTURE NO. 079-0048