

PROJECT ENGINEER: PATTI LEBEAU (618) 346-3179  
SQUAD CONTACT: ART MUEHLFELD (618) 346-3209

## INDEX OF SHEETS

- 1 COVER SHEET AND LIST OF STANDARDS
- 2 GENERAL NOTES, COMMITMENTS, AND MIXTURE CHART
- 3-4 SUMMARY OF QUANTITIES
- 5-7 TYPICAL SECTIONS
- 8-9 SCHEDULES
- 10-12 PLAN AND PROFILE SHEETS
- 13 WIDE LOAD SIGNING
- 14-22 STAGING PLANS
- 23-24 STORM WATER POLLUTION PREVENTION PLAN
- 25-55A. BRIDGE PLANS
- 56 SIDEROAD DETAIL
- 57 REMOVAL PLAN SHEETS
- 58-59 DETAILS
- 60 PAVEMENT MARKING
- 61-73 CROSS SECTIONS

## LIST OF STANDARDS

000001-04	635006-02	<del>000001-04</del>	720006
420401-05	635011-01	701301-02	720011
482011-01	701001-01	701306-01	729001
609006-02	701006-02	701311-02	780001-01
630001-05	701011-01	701321-08	781001-02
631011-02	701201-02	701326-02	
631031-05	701206-01	720001	

MICROFILMED \_\_\_\_\_  
REEL NUMBER \_\_\_\_\_  
AWARDED \_\_\_\_\_  
RESIDENT ENGINEER \_\_\_\_\_  
AS BUILT CHANGES WERE MADE  
ON THE FOLLOWING SHEETS

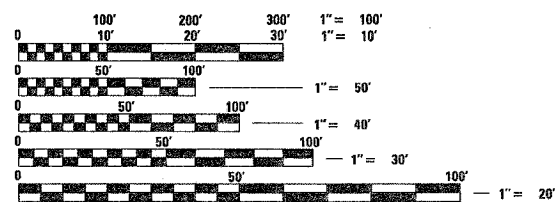

FULL SIZE PLANS HAVE BEEN PREPARED USING STANDARD  
ENGINEERING SCALES, REDUCED SIZED PLANS WILL NOT  
CONFORM TO STANDARD SCALES, IN MAKING MEASUREMENTS  
ON REDUCED PLANS, THE ABOVE SCALES MAY BE USED.

J.U.L.I.E.  
JOINT UTILITY LOCATION INFORMATION FOR EXCAVATION  
1-800-892-0123

CONTRACT NO. 76125

DESIGN DESIGNATION  
OTHER PRINCIPAL ARTERIAL



STATE OF ILLINOIS  
DEPARTMENT OF TRANSPORTATION  
DIVISION OF HIGHWAYS  
**PLANS FOR PROPOSED  
FEDERAL AID HIGHWAY**  
FAP ROUTE 312 (IL 003)  
SECTION 71BR  
PROJECT NUMBER: BRF-0312(028)  
BRIDGE REPLACEMENT OVER HORSE CREEK  
1.5 MI. NORTH OF RUMA  
RANDOLPH COUNTY

C-98-096-01

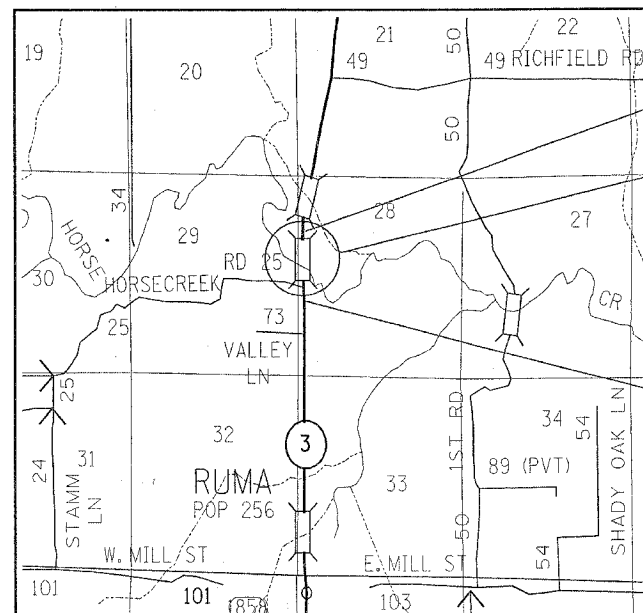

NOT TO SCALE

GROSS PROJECT LENGTH = 960 FT = .18 MILES  
NET PROJECT LENGTH = 960 FT = .18 MILES

BEGIN PROJECT  
STA. 1124 + 31.1

BRIDGE REPLACEMENT  
STA. 1128 + 90.00  
EXIST STRUCTURE NO. 079-0003  
PROP. STRUCTURE NO. 079-0048  
LATITUDE: 381570  
LONGITUDE: -89.99831

END PROJECT  
STA. 1133 + 90.9

GROSS LENGTH: 0.12 MILES (653.40 FT.)  
NET LENGTH: 0.12 MILES (653.40 FT.)

ADT	
2005	6100
2015	7000
2025	8200
S.U.	13.4%
M.U.	5.6%

FAP ROUTE	SECTION	COUNTY	TOTAL SHEETS	SHEET NO.
312	71BR	RANDOLPH	1	73

CONTRACT NO.: 76125

D-98-011-00

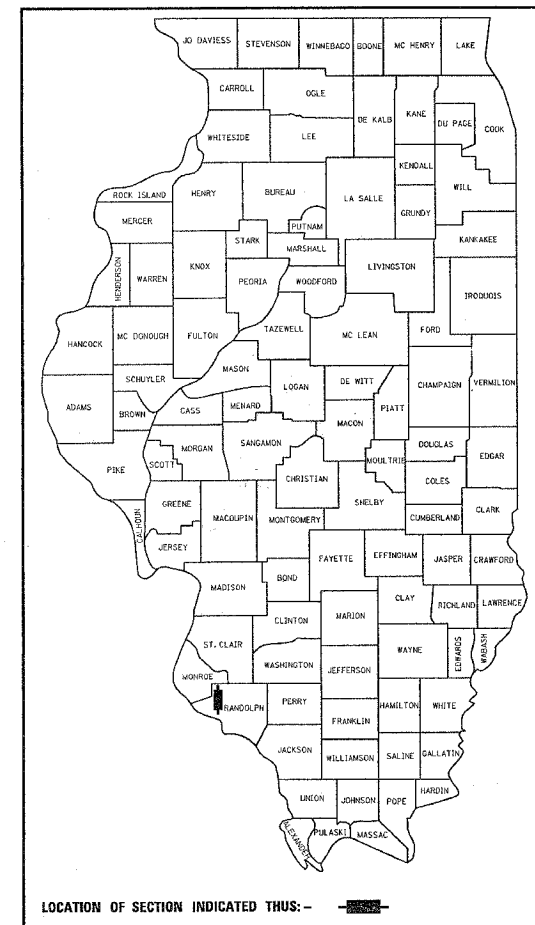

STATE OF ILLINOIS  
DEPARTMENT OF TRANSPORTATION  
DIVISION OF HIGHWAYS

SUBMITTED Dec 21 20 04  
Mary C. Lammie  
DEPUTY DIRECTOR OF HIGHWAYS  
REGION FIVE ENGINEER

February 4, 20 05  
Mike Vane  
ENGINEER OF DESIGN AND ENVIRONMENT

February 4, 20 05  
Victor M. Deery  
DIRECTOR, DIVISION OF HIGHWAYS

PRINTED BY THE AUTHORITY OF THE STATE OF ILLINOIS

Revised 2-24-05