

F.A.U. RTE.	SECTION	COUNTY	TOTAL SHEETS	SHEET NO.
6194	K 1091R, RS-4	KANKAKEE	82	23
STA.		TO STA.		
FED. ROAD DIST. NO.		ILLINOIS FED. AID PROJECT		

66402

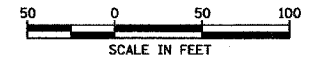

PLAN	SURVEYED	DATE
NOTE BOOK NO.	BY	
	CHECKED	
	DATE	

PROFILE	SURVEYED	DATE
NOTE BOOK NO.	BY	
	CHECKED	
	DATE	

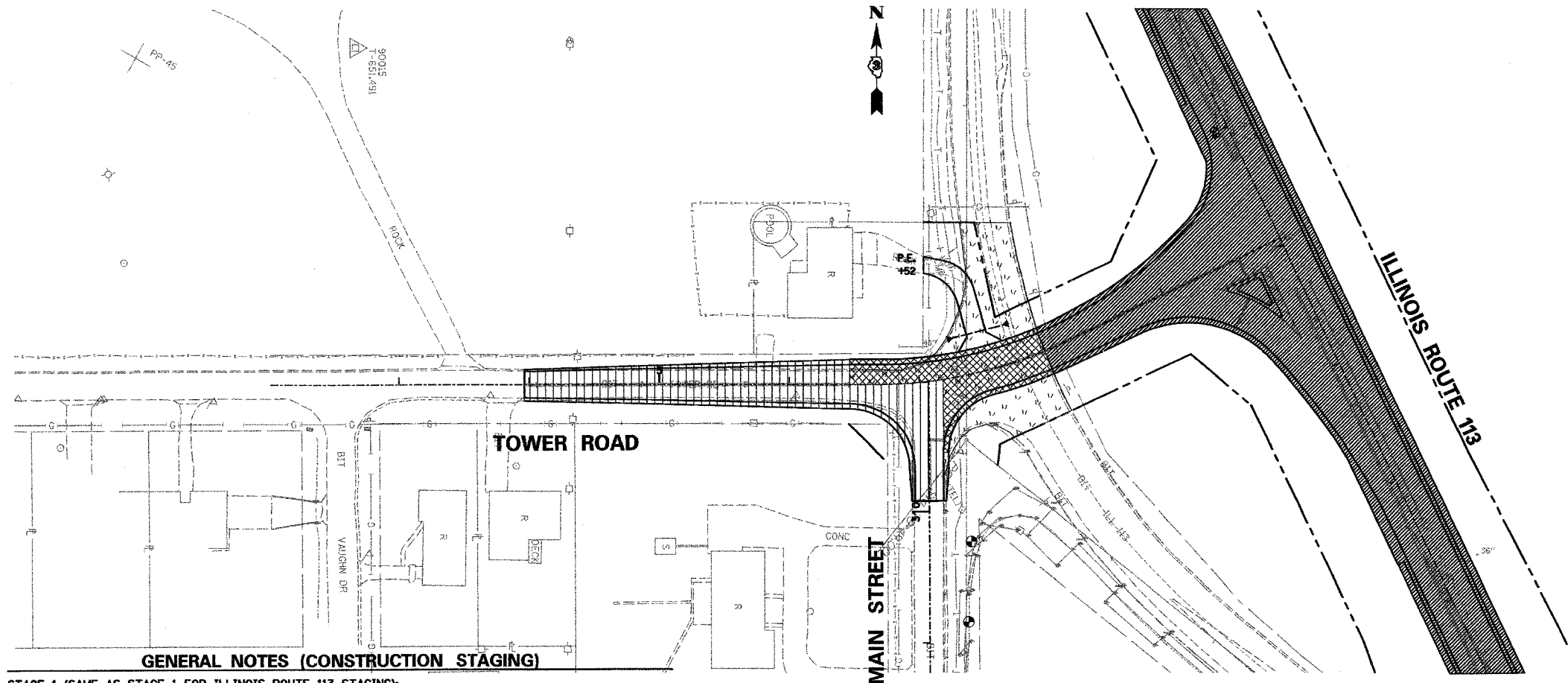

LEGEND (CONSTRUCTION STAGING)

- STAGE 1 CONSTRUCTION
- STAGE 2 CONSTRUCTION
- STAGE 2 REMOVAL
- STAGE 3 CONSTRUCTION

GENERAL NOTES (CONSTRUCTION STAGING)

- STAGE 1 (SAME AS STAGE 1 FOR ILLINOIS ROUTE 113 STAGING):**
1. CONSTRUCT RELOCATED SECTIONS OF ROUTE 113 AND TOWER ROAD.
 2. ALL LANES OF ROUTE 113 AND TOWER ROAD SHALL REMAIN OPEN TO TRAFFIC AT ALL TIMES.
 3. NO SURFACE COURSE SHALL BE PLACED DURING STAGE 1 OPERATIONS.
- STAGE 2 (SHALL NOT BEGIN UNTIL ILLINOIS ROUTE 113 TRAFFIC HAS BEEN SHIFTED ONTO NEW ALIGNMENT):**
1. CONSTRUCT PORTION OF TOWER ROAD TO BE RECONSTRUCTED THROUGH THE EXISTING INTERSECTION. WORK SHALL BE COMPLETED UNDER TRAFFIC WITH AT LEAST ONE LANE OPEN TO TRAFFIC AT ALL TIMES AND BOTH LANES OPEN AT NIGHT. REMOVAL OF EXISTING PAVEMENT SHALL TAKE PLACE ONE LANE AT A TIME. UPON REMOVAL OF ONE LANE OF PAVEMENT, TRAFFIC SHALL NOT BE ALLOWED BACK ON THAT LANE UNTIL ONE LIFT OF BITUMINOUS BINDER COURSE HAS BEEN PLACED OVER THE SUBBASE. BOTH LANES SHALL BE BUILT-UP AT THE SAME TIME. A SECOND LIFT OF BITUMINOUS SHALL NOT BE PLACED ON A PARTICULAR LANE WITHOUT THE OTHER LANE BROUGHT TO THE SAME GRADE. TEMPORARY RAMPS SHALL BE CONSTRUCTED AS NEEDED TO TRANSITION BACK TO EXISTING PAVEMENT OR RELOCATED TOWER ROAD. A BUMP SIGN SHALL BE PLACED 100' IN ADVANCE OF THE RAMPS IN EITHER DIRECTION.
 2. ADDITIONAL EXISTING PAVEMENT ADJACENT TO TOWER ROAD SHALL BE REMOVED AS INDICATED ON THE PLAN.
 3. IMPEDED ACCESS TO THE PRIVATE ENTRANCE AT STA. 7+52 LT SHALL BE LIMITED TO SHORT PERIODS OF TIME AS DIRECTED BY THE ENGINEER. THE PROPERTY OWNER SHALL BE NOTIFIED PRIOR TO INITIATING ANY ITEM OF WORK THAT MAY IMPEDE ACCESS.
 4. NO SURFACE COURSE SHALL BE PLACED DURING STAGE 2 OPERATIONS.
- STAGE 3:**
1. CONSTRUCT REMAINDER OF PROPOSED IMPROVEMENTS TO TOWER ROAD AND MAIN STREET. WORK SHALL BE COMPLETED UNDER TRAFFIC WITH AT LEAST ONE LANE OPEN TO TRAFFIC AT ALL TIMES AND BOTH LANES OPEN AT NIGHT. TEMPORARY RAMPS SHALL BE CONSTRUCTED AS NEEDED TO TRANSITION TRAFFIC ONTO ALREADY COMPLETED PORTION OF TOWER ROAD. A BUMP SIGN SHALL BE PLACED 100' IN ADVANCE OF THE RAMPS IN EITHER DIRECTION.
 2. NO SURFACE COURSE SHALL BE PLACED DURING STAGE 3 OPERATIONS.
- STAGE 4:**
1. PLACE SURFACE COURSE ON TOWER ROAD.
 2. PLACE SURFACE COURSE ON MAIN STREET.
 3. STAGE 4 SHALL TAKE PLACE ONLY AFTER SURFACE COURSE HAS BEEN PLACED ON ADJACENT SECTION OF ILLINOIS ROUTE 113.

ILLINOIS DEPARTMENT OF TRANSPORTATION
FAU 6194 (ILLINOIS ROUTE 113)
CONSTRUCTION STAGING /
MAINTENANCE OF TRAFFIC PLAN
(TOWER ROAD)

SCALE: VERT. _____
 HORIZ. _____
 DATE _____

DRAWN BY _____
 CHECKED BY _____

*****DATE*****