

F.A.P. RTE.	SECTION	COUNTY	TOTAL SHEETS	SHEET NO.
595	1-3-K	ROCK ISLAND	476	131
STA. 6+40		TO STA. 12+80		
FED. ROAD DIST. NO.		ILLINOIS	FED. AID PROJECT	

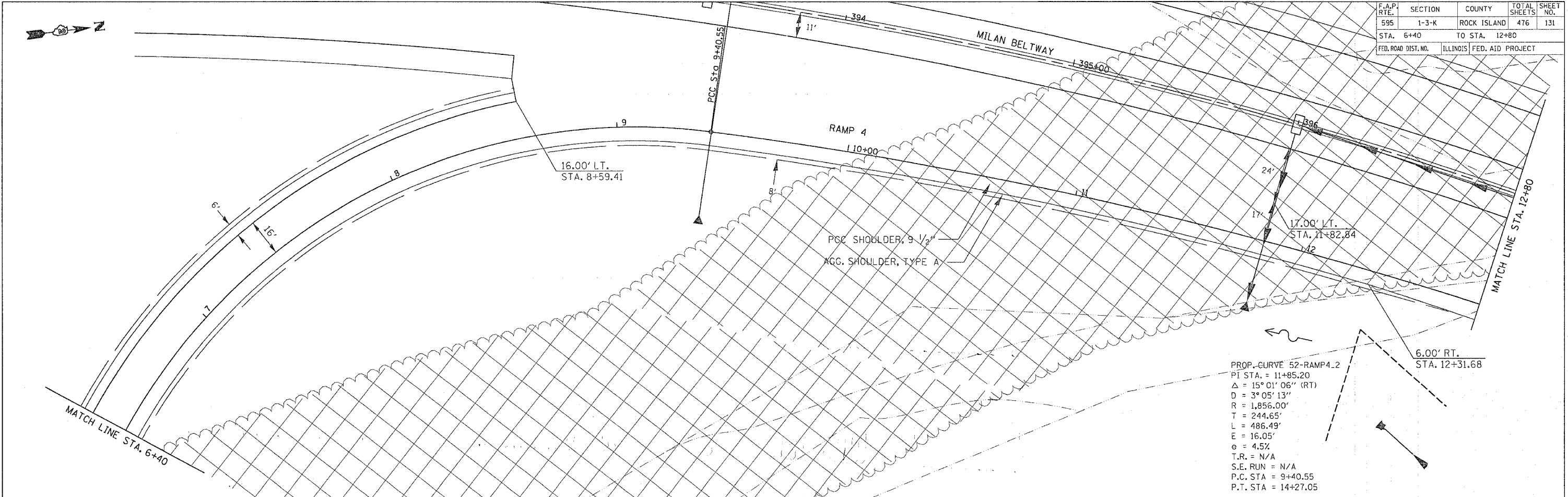

PROP. CURVE 52-RAMP4.2
 PI STA. = 11+85.20
 $\Delta = 15^{\circ}01'06''$ (RT)
 $D = 3^{\circ}05'13''$
 $R = 1,856.00'$
 $T = 244.65'$
 $L = 486.49'$
 $E = 16.05'$
 $e = 4.5\%$
 $T.R. = N/A$
 $S.E. RUN = N/A$
 $P.C. STA = 9+40.55$
 $P.T. STA = 14+27.05$

PLAN

DATE	BY

SURVEYED
 ALIGNED
 CHECKED
 NOTE BOOK
 RT. OF WAY CHECKED
 PAID FILE NAME

PROFILE

DATE	BY

SURVEYED
 GRADES CHECKED
 ELEVATIONS CHECKED
 NOTE BOOK
 STRUCTURE NOTATIONS CHECKED

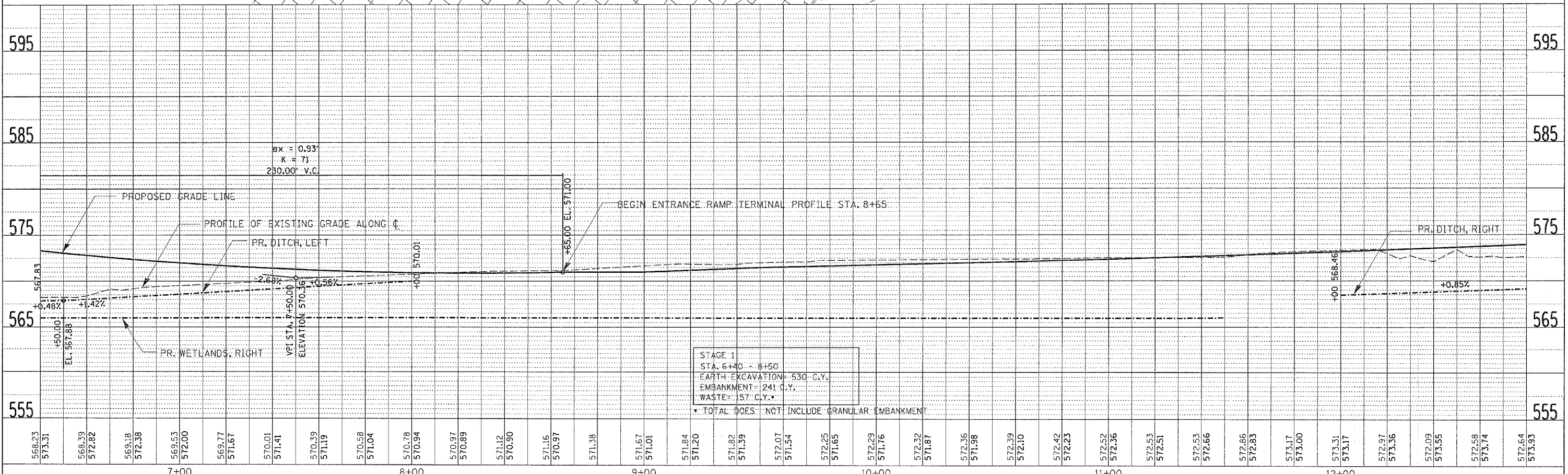

52ND AVENUE RAMP 4 - STA. 6+40 TO STA. 12+80