

F.A.I. RTE.	SECTION	COUNTY	TOTAL SHEETS	SHEET NO.
55	2002-022 K	WILL	172	09
STA. 10+00		TO STA. 22+96.05		
FED. ROAD DIST. NO.	ILLINOIS	FED. AID PROJECT		
CONTRACT # 62389				

DATE	BY	REVISION
		1. CHECKED
		2. ALIGNED
		3. PLOTTED
		4. FILED
		5. NO. _____

DATE	BY	REVISION
		1. CHECKED
		2. ALIGNED
		3. PLOTTED
		4. FILED
		5. NO. _____

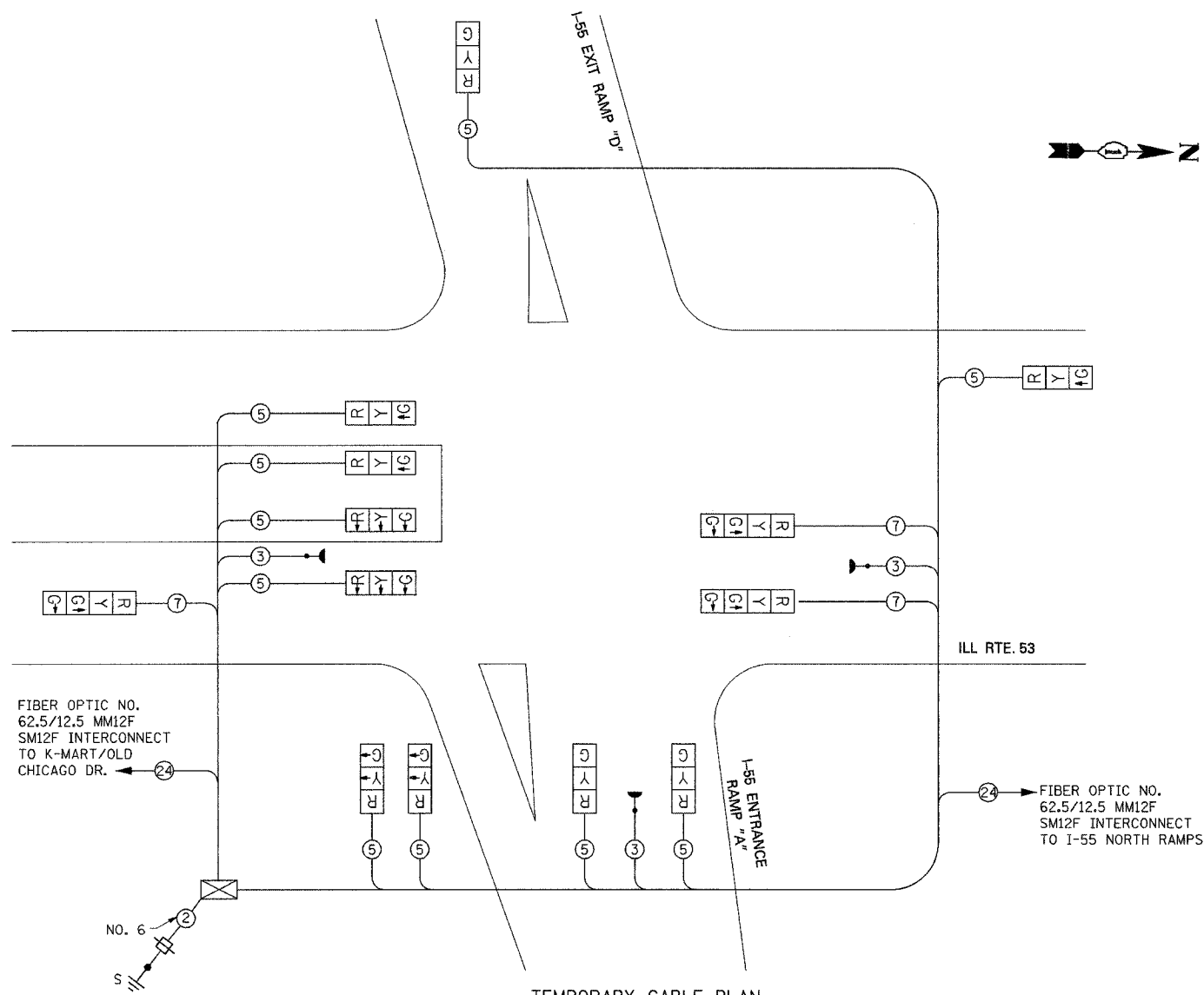

TEMPORARY CABLE DIAGRAM LEGEND:

-
-
-
-
-
-
-
-
-
-
-
-
-
-

NOTES FOR TEMPORARY TRAFFIC SIGNALS

- ALL CONTROL EQUIPMENT INCLUDING EMERGENCY PRE-EMPTION AND COMMUNICATION DEVICES FOR THE TEMPORARY TRAFFIC SIGNAL(S) SHALL BE FURNISHED BY THE CONTRACTOR
- ONLY CONTROLLERS SUPPLIED BY ONE OF THE DISTRICT APPROVED CLOSED LOOP EQUIPMENT MANUFACTURERS WILL BE APPROVED FOR USE AT TEMPORARY SIGNAL LOCATIONS. ALL CONTROLLERS USED FOR TEMPORARY TRAFFIC SIGNALS SHALL BE FULLY ACTUATED NEMA MICROPROCESSOR BASED WITH RS232 DATA ENTRY PORTS COMPATIBLE WITH EXISTING MONITORING SOFTWARE APPROVED BY IDOT DISTRICT 1, INSTALLED IN A NEMA TSI OF TS2 CABINET. ONLY ONE BRAND OF CONTROLLER WILL BE ACCEPTED FOR ANY ONE CONTRACT.
- ALL TRAFFIC SIGNAL SECTIONS AND PEDESTRIAN SIGNAL SECTIONS SHALL BE 12" (300 mm). HEADS SHALL BE PLACED AS INDICATED ON THE TEMPORARY TRAFFIC SIGNAL PLAN OR AS DIRECTED BY THE ENGINEER. THE CONTRACTOR SHALL FURNISH ENOUGH CABLE SLACK TO RELOCATE HEADS TO ANY POSITION ON THE SPAN WIRE OR AT LOCATIONS ILLUSTRATED ON THE PLANS FOR CONSTRUCTION STAGING. THE TEMPORARY TRAFFIC SIGNAL SHALL REMAIN IN OPERATION DURING ALL SIGNAL HEAD RELOCATIONS. EACH TEMPORARY TRAFFIC SIGNAL HEAD SHALL HAVE ITS OWN CABLE FROM THE CONTROLLER CABINET TO THE SIGNAL HEAD.
- ALL EXISTING STREET NAME AND INTERSECTION REGULATORY SIGNS SHALL BE REMOVED FROM EXISTING POLES, RELOCATED AND SECURELY FASTENED TO THE SIGNAL SPAN WIRE OR WOOD POLE AS DIRECTED BY THE ENGINEER.
- ANY TEMPORARY SIGNAL WITHIN AN EXISTING CLOSED LOOP TRAFFIC SIGNAL SYSTEM SHALL BE INTERCONNECTED TO THAT SYSTEM USING SIMILAR BRAND CONTROL EQUIPMENT.
- THE TEMPORARY TRAFFIC SIGNAL SHALL HAVE THE SIGNAL HEAD DISPLAYS, SIGNAL HEAD PLACEMENTS AND CONTROLLER PHASING MATCH THE EXISTING TRAFFIC SIGNAL, AT THE TIME OF THE TURN ON, IF NO TRAFFIC STAGING IS IN PLACE OR WILL NOT BE STAGED ON THE DAY OF THE TURN ON.

THE TRAFFIC SIGNAL CONTROL EQUIPMENT FOR THIS PROJECT SHALL BE "ECONOLITE" TO MATCH THE EXISTING ADJACENT SYSTEM.

TEMPORARY CABLE PLAN
NOT TO SCALE

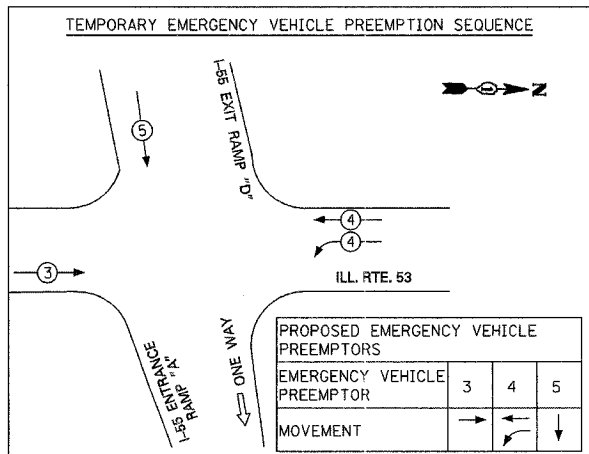
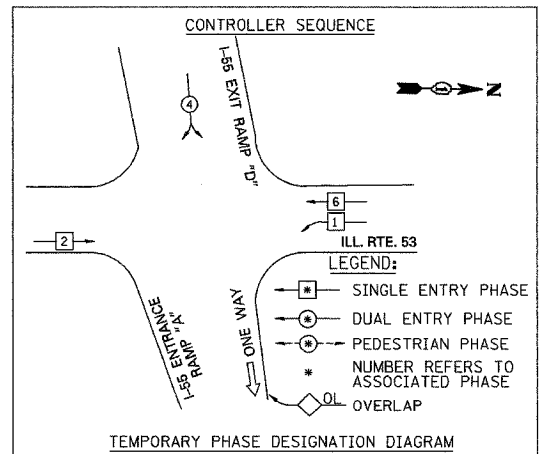

I.D.O.T. TRAFFIC SIGNAL INSTALLATION ELECTRICAL SERVICE REQUIREMENTS					
TYPE	NO. LAMPS	WATTAGE	% OPERATION	TOTAL WATTAGE	
SIGNAL (RED)	13	135	17	0.50	877.5
(YELLOW)	13	135	25	0.25	438.75
(GREEN)	16	135	15	0.25	540
ARROW	135	12	0.10		
PED. SIGNAL	90	25	1.00		
CONTROLLER	1	100	1.00		100
ILLUM. SIGN		84	35	0.05	
FLASHER		135	25	0.50	
TOTAL =					1956.25

FOUNDATION (DEPTH) (FT.) (m)	CABLE SLACK (FT.) (m)	CABLE SLACK (FT.) (m)	CABLE SLACK (FT.) (m)
TYPE A - POST	4 (1.2)	HANDHOLE	6.5 (2.0)
D - CONTROLLER	4 (1.2)	DOUBLE HANDHOLE	13 (4.0)
E - M. ARM POLE		SIGNAL POST	2 (1.0)
24" (600mm)	10 (3.0)	CONTROLLER CAB.	1 (0.5)
30" (750mm)	15 (4.6)	FIBER OPTIC	13 (4.0)
		ELECTRIC SERVICE	1 (0.5)
		GROUND CABLE	1 (0.5)
		POST MOUNTED	6 (1.8)

ENERGY COST TO: Illinois Department of Transportation
Division of Highways / District 1
201 W Center Court/Schaumburg, Illinois 60196-1096
ENERGY SUPPLY: CONTACT: Mr. Dale Bollinger
PHONE: 815-724-5717
COMPANY: ComEd (1910 South Briggs St., Joliet, IL 60433)



REVISIONS	
NAME	DATE

ILLINOIS DEPARTMENT OF TRANSPORTATION
TEMPORARY CABLE PLAN, PHASE DESIGNATION
DIAGRAM AND EMERGENCY
VEHICLE PREEMPTION SEQUENCE
ILL. RTE. 53 AT I-55 SOUTH RAMPS

SCALE: NONE
DATE: DECEMBER, 2004

DRAWN BY: RV
DESIGNED BY: AZ
CHECKED BY: AZ