

F.A.I. RTE.	SECTION	COUNTY	TOTAL SHEETS	SHEET NO.
55	2002-022 K	WILL	172	70
STA.		TO STA.		
FED. ROAD DIST. NO.	ILLINOIS	FED. AID PROJECT		
CONTRACT # 62389				

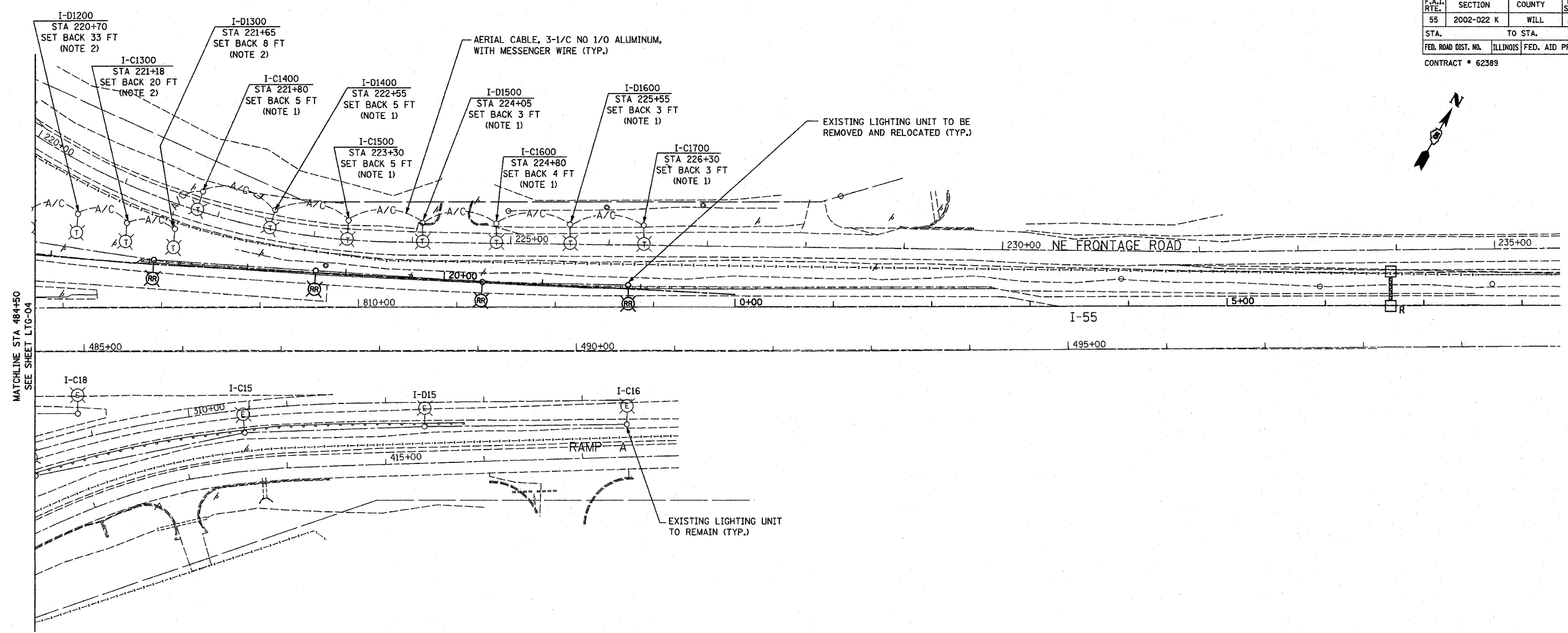

NOTES

1. TEMPORARY WOOD POLE 90 FT CLASS 4 WITH 15 MAST ARM, 80 FT M.H. 750W HPS M-C-III-LUMINAIRE.
2. TEMPORARY WOOD POLE 90 FT CLASS 4 WITH 15 FT MAST ARM, 80 FT M.H. 400 W HPS-M-C-III LUMINAIRE.

PLAN	SURVEYED	DATE
	NOTED	
	CHECKED	
	BY	
	NO. OF WAYS CHECKED	
	CADD FILE NAME	

PROFILE	SURVEYED	DATE
	NOTED	
	CHECKED	
	BY	
	NO. OF WAYS CHECKED	
	STRUCTURE NOTATIONS CRD	

LTG-05

REVISIONS	
NAME	DATE

ILLINOIS DEPARTMENT OF TRANSPORTATION

TEMPORARY LIGHTING AND REMOVAL PLAN

SCALE: 1"=50'

DATE: OCTOBER 25, 2004

DRAWN BY: SM
DESIGNED BY: SM
CHECKED BY: SM

