

F.A.I. RTE.	SECTION	COUNTY	TOTAL SHEETS	SHEET NO.
55	2002-022 K	WILL	172	57
STA. 10+00		TO STA. 22+96.05		
FED. ROAD DIST. NO.		ILLINOIS FED. AID PROJECT		
CONTRACT NO. 62389				

I-55 SB ENTRANCE RAMP C STA. 613+37.46 =
ILLINOIS ROUTE 53 STA. 1462+72.73

I-55 SB EXIT RAMP B STA. 10+00.00 =
ILLINOIS ROUTE 53 STA. 1463+03.14

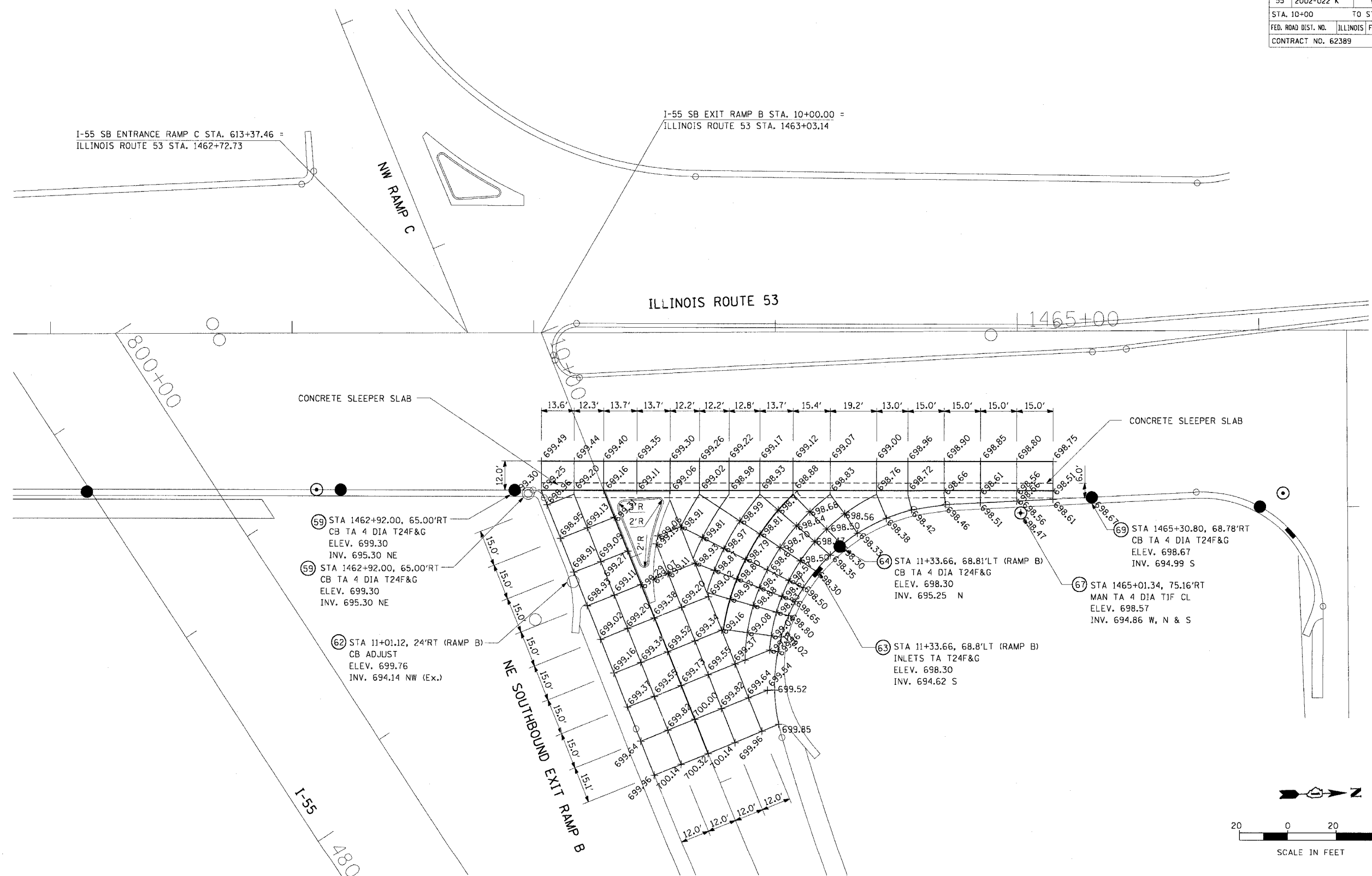

- 59 STA 1462+92.00, 65.00'RT
CB TA 4 DIA T24F&G
ELEV. 699.30
INV. 695.30 NE
- 59 STA 1462+92.00, 65.00'RT
CB TA 4 DIA T24F&G
ELEV. 699.30
INV. 695.30 NE

- 62 STA 11+01.12, 24'RT (RAMP B)
CB ADJUST
ELEV. 699.76
INV. 694.14 NW (Ex.)

- 64 STA 11+33.66, 68.81'LT (RAMP B)
CB TA 4 DIA T24F&G
ELEV. 698.30
INV. 695.25 N

- 67 STA 1465+01.34, 75.16'RT
MAN TA 4 DIA T1F CL
ELEV. 698.57
INV. 694.86 W, N & S

- 63 STA 11+33.66, 68.8'LT (RAMP B)
INLETS TA T24F&G
ELEV. 698.30
INV. 694.62 S

- LEGEND:**
- SAWED CONSTRUCTION JOINT
 - LONGITUDINAL CONSTRUCTION JOINT
 - - - - SLEEPER SLAB

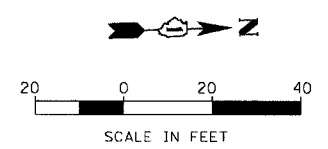

PLAN	SURVEYED	DATE
NOTE BOOK	BY	
NO.		

PROFILE	SURVEYED	DATE
NOTE BOOK	BY	
NO.		

REVISIONS	
NAME	DATE

DMJM HARRIS
303 East Wacker Drive, Suite 600
Chicago, Illinois, 60601 Phone: 312.321.6101 Fax: 312.396.2392

ILLINOIS DEPARTMENT OF TRANSPORTATION
PAVEMENT JOINTING/ELEVATIONS
THRU INTERSECTION
RAMP B AT ILLINOIS ROUTE 53
SCALE: 1"=20'
DATE: 11/8/2004
DRAWN BY: CC
CHECKED BY: RI