

F.A.T. RTE.	SECTION	COUNTY	TOTAL SHEETS	SHEET NO.
55	2002-022 K	WILL	172	46
STA. 10+00		TO STA. 22+96.05		
FED. ROAD DIST. NO.		ILLINOIS FED. AID PROJECT		
CONTRACT NO. 62389				

PLAN	DATE
BY	
REVISIONS	
NO.	
DESCRIPTION	

PROFILE	DATE
BY	
REVISIONS	
NO.	
DESCRIPTION	

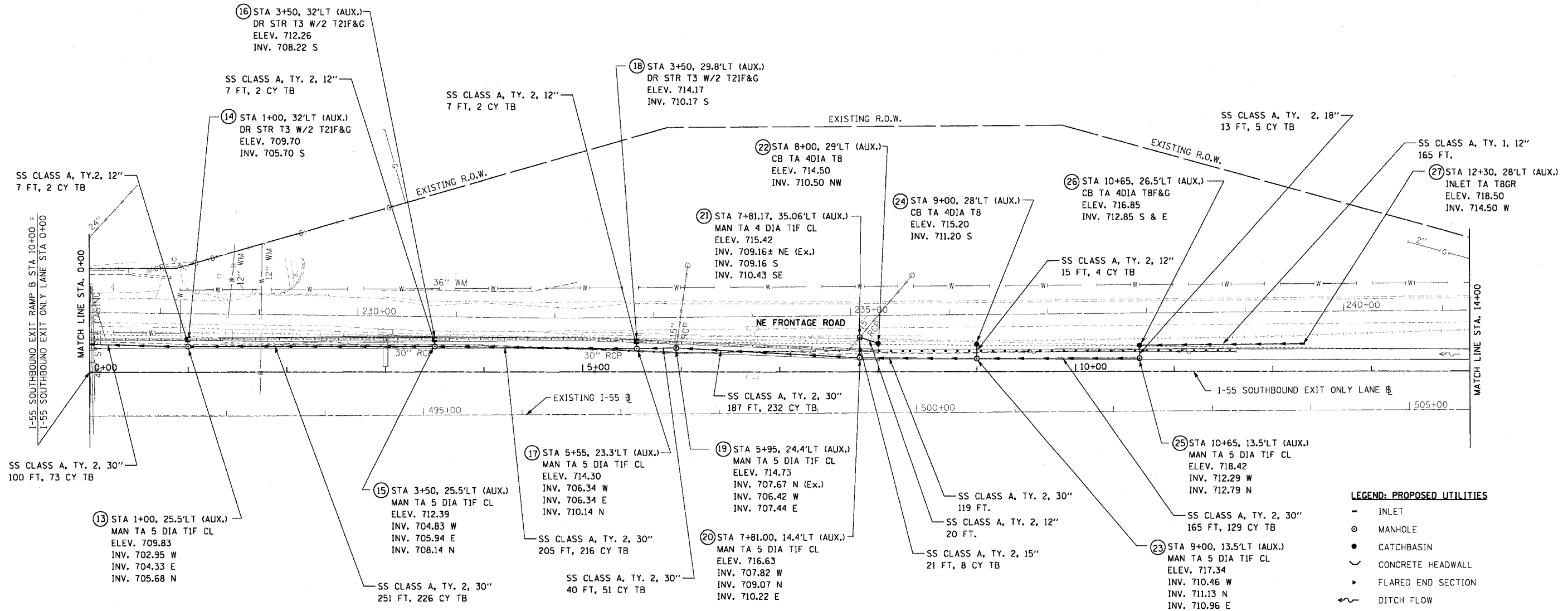

LEGEND: PROPOSED UTILITIES

- INLET
- MANHOLE
- CATCHBASIN
- CONCRETE HEADWALL
- ▶ FLARED END SECTION
- ~ DITCH FLOW
- ◆ DITCH CHECK
- ↔ SUMMIT
- ➔ DIRECTION OF WATER
- ⦿ FIRE HYDRANT
- SWALE
- - - - SANITARY SEWER LINE
- STORM SEWER LINE
- CULVERT

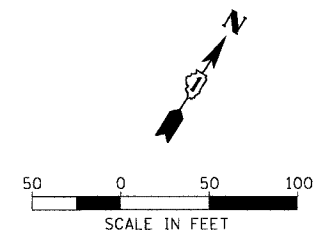

DMJM HARRIS
 303 East Wacker Drive, Suite 600
 Chicago, Illinois, 60601 Phone: 312.321.6101 Fax: 312.396.2392

REVISIONS	
NAME	DATE

ILLINOIS DEPARTMENT OF TRANSPORTATION

PROPOSED DRAINAGE PLAN
 I-55 SOUTHBOUND EXIT ONLY LANE
 STA 0+00 TO STA 14+00

SCALE: 1"=50'
 DATE: 12/23/2004
 DRAWN BY: CC
 CHECKED BY: RI