

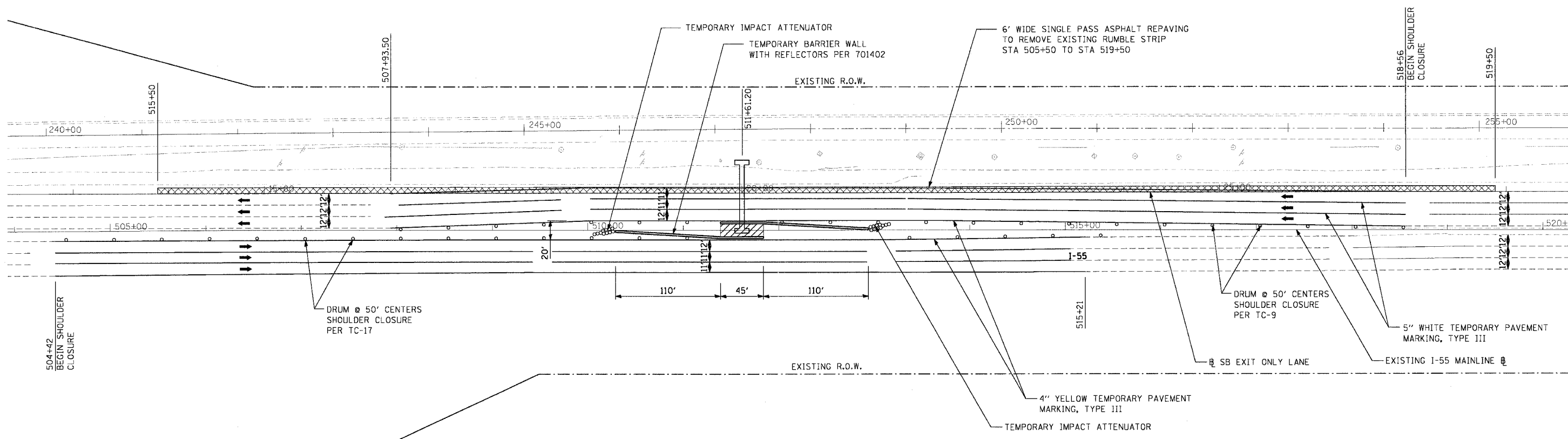







F.A.I. RTL:	SECTION	COUNTY	TOTAL SHEETS	SHEET NO.
55	2002-022 K	WILL	172	23
STA. 0+00		TO STA. 23+00		
FED. ROAD DIST. NO.	ILLINOIS FED. AID PROJECT			
CONTRACT NO. 62389				

PLAN	SURVEYED	BY	DATE
	NOTE BOOK		
	ALIGNED		
	CHECKED		
	NO.		
	FILE NAME		

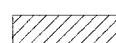
PROFILE	SURVEYED	BY	DATE
	GRADES		
	CHECKED		
	NO.		
	STRUCTURE		
	NOTATION		

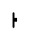

LEGEND:

-  ARROWBOARD
-  WORK AREA
-  TEMPORARY PAVEMENT
-  SIGN ON PORTABLE OR PERMANENT SUPPORT
-  FLAGGER WITH CONTROL SIGN
-  DRUM WITH MONO DIRECTIONAL STEADY BURNING LIGHT
-  CONES 700 (28") IN HEIGHT
-  DIRECTION OF TRAFFIC

NOTES:

SUBSTAGE 1A - REMOVAL OF BARRIER WALL AND SHOULDER FOR PLACEMENT OF NEW SIGN STRUCTURE BASE. CONSTRUCT SIGN FOUNDATION, BARRIER WALL, AND MEDIAN AND REMOVE MEDIAN TRAFFIC CONTROL BEFORE STAGE 1 TRAFFIC CONTROL PLACED.

NO ACCESS TO WORK AREA WITHOUT LANE CLOSURE.

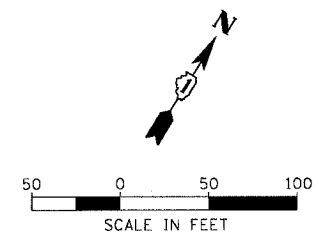

DMJM HARRIS
 303 East Wacker Drive, Suite 600
 Chicago, Illinois, 60601 Phone: 312.321.6101 Fax: 312.396.2392

REVISIONS	
NAME	DATE

ILLINOIS DEPARTMENT OF TRANSPORTATION
 SUGGESTED CONSTRUCTION STAGING
 I-55 SOUTHBOUND EXIT ONLY LANE
 STA 511+50 STAGE 1A

SCALE: 1"=50'
 DATE: 11/8/2004
 DRAWN BY: CC
 CHECKED BY: RI