

IMAGE FILES: S:\aop\p.jit

CA001

K:\Springfield\0403510\Draw\Sheets\1105\
FILE: 10_PROPIMPV.dwg
LAYOUT: Layout1
UPDATE BY: cgroth
SURVEY BOOK #
DATE: Fri 1/27/06 4:52pm
XREF DWG: C:\info.dwg
Uts98.dwg
Seq\odBase.DWG
CaptionBase.dwg

REVISIONS		
NUMBER	BY	DATE

0 1 2
THIS BAR IS EQUAL TO 2"
AT FULL SCALE (34X22).

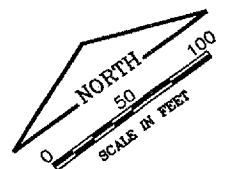
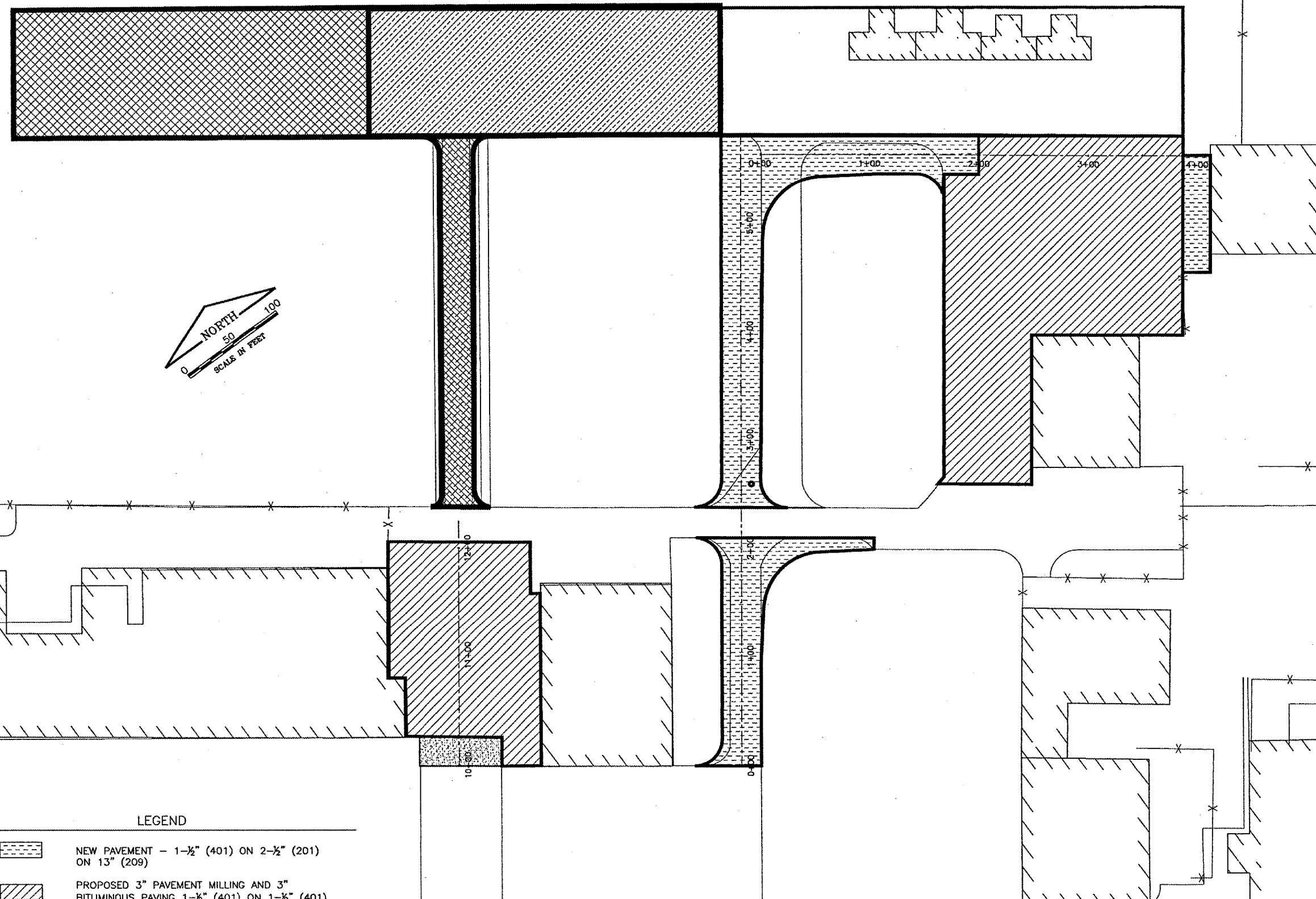

LEGEND

- NEW PAVEMENT - 1-1/2" (401) ON 2-1/2" (201) ON 13" (209)
- PROPOSED 3" PAVEMENT MILLING AND 3" BITUMINOUS PAVING 1-1/2" (401) ON 1-1/2" (401)
- ADDITIVE ALTERNATE #1 - PAVEMENT REMOVAL
- ADDITIVE ALTERNATE #2 - PAVEMENT REMOVAL
- ADDITIVE ALTERNATE #3 - PAVEMENT REMOVAL
- TAR EMULSION SEAL COAT

SPRINGFIELD AIRPORT AUTHORITY
ABRAHAM LINCOLN CAPITAL AIRPORT
SPRINGFIELD, ILLINOIS

REHABILITATE SOUTHEAST QUADRANT HANGAR PAVEMENTS

PROPOSED IMPROVEMENTS

CMT
 CRAWFORD, MURPHY & TILLY, INC.
 CONSULTING ENGINEERS
 License No. 84-000613

DESIGN BY: CBG
 DRAWN BY: CMT
 CHECKED BY: *CSL*
 APPROVED BY: *RW*
 DATE: 01/27/2006

JOB No: 04035-10-00
 ILLINOIS PROJECT SPI-3346
 SHEET 10 OF 20 SHEETS