

F.A.U. RTE.	SECTION	COUNTY	TOTAL SHEETS	SHEET NO.
8873	00-00012-00-PK	MADISON	18	8
FED. ROAD DIST. NO.	ILLINOIS	FED. AID PROJECT		

CONTRACT NO. 97270

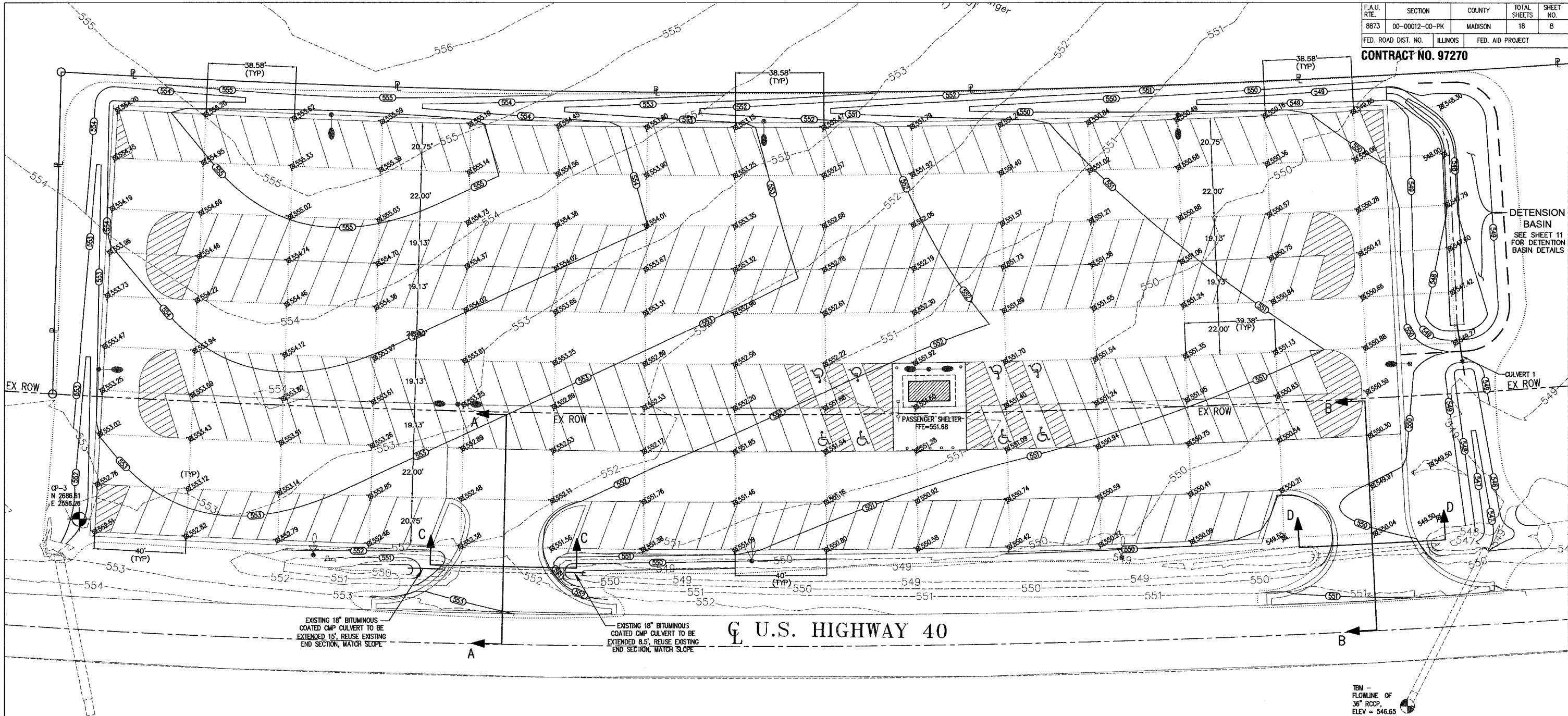

#### NOTE:

THE GRADING GRID INDICATED ON THE PLAN IS BASED ON THE RADIUS OF THE PARKING LOT. GRADING GRID IS 40' WIDE AT THE SOUTH LINE AND SHORTENS TO 38.58' ON THE NORTH END, WHILE THE LONGITUDINAL GRADING GRID LINES VARY AS SHOWN ON THE PLANS.

#### EARTHWORK SCHEDULE

LOCATION	EARTH EXCAVATION	UNSUITABLE OR UNSTABLE MATERIAL	EXCAVATION TO BE USED IN EMBANKMENT ADJUSTED FOR SHRINKAGE	EMBANKMENT	EARTHWORK BALANCE WASTE (+) OR SHORTAGE (-)
	CUBIC YARD	CUBIC YARD	CUBIC YARD	CUBIC YARD	CUBIC YARD
STA. 791+50 TO 798+50	226	2432	170	1863	-1693

SHRINKAGE FACTOR = 25%

SEE DETAILS 8 AND 9 ON SHEET 12 FOR ENTRANCE PROFILES AND CROSS-SECTIONS

CULVERT 1  
22LF - PIPE CULVERTS, CLASS A, TYPE 1 8"  
USFL=547.25  
N=3054.16  
E=3040.72  
DSFL=547.14  
N=3036.82  
E=3054.16

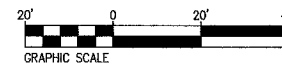

Juneau Associates, Inc. P.C.  
CONSULTING ENGINEERS AND LAND SURVEYORS  
2900 State Street, P.O. Box 1325  
Champaign, Illinois 61824-4725  
Phone: (815) 977-1400 / (815) 452-5535  
Fax: (815) 452-5041

GRADING AND DRAINAGE PLAN  
HIGHLAND PARK-RIDE IMPROVEMENTS  
MADISON COUNTY TRANSIT  
HIGHLAND, ILLINOIS  
SECTION No. 00-00012-00-PK

REVISIONS			
NO.	DATE	BY	REMARKS

SCALE:			
DSN. BY:	RGL/AJW	DATE:	12/20/05
DWN. BY:	RGL/AJW	DATE:	12/20/05
CHK'D:	RAK	DATE:	12/20/05
JOB NO.	E054401	DWG NAME:	OF 18 SHEETS