

PAV ROUTE	SECTION	COUNTY	TOTAL SHEETS	SHEET NO
9397	01-00022-00-RP	MADISON	72	24
STA. 15+00		TO STA. 20+00		

TEMPORARY EROSION CONTROL

CONTRACT NO. 97269

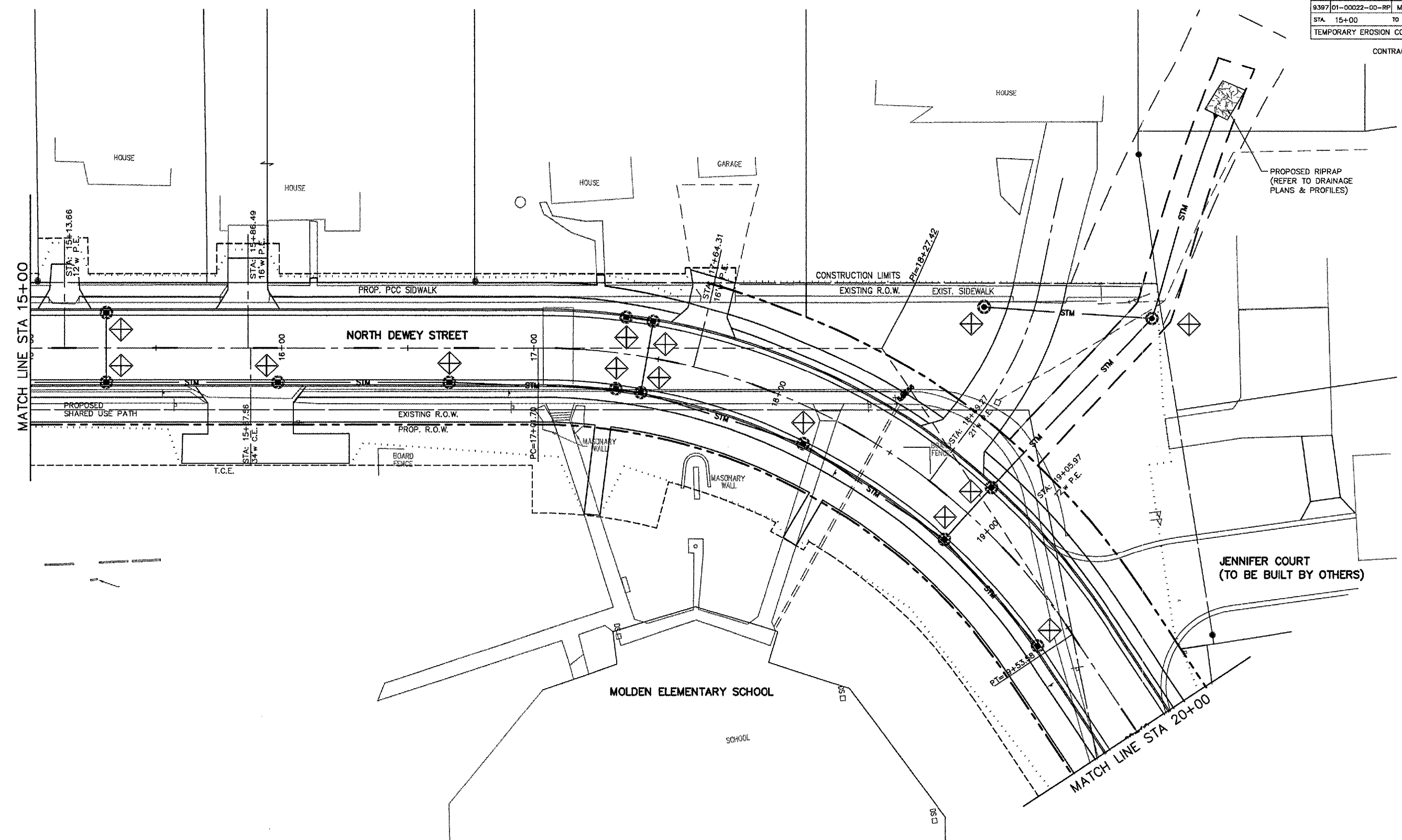

TEMPORARY EROSION CONTROL ITEMS

- ① TEMPORARY DITCH CHECK
- ② INLET & PIPE PROTECTION
- ③ PERIMETER EROSION BARRIER

