

F.A.P. RTE.	SECTION	COUNTY	TOTAL SHEETS	SHEET NO.
777	10(B-1, BR-2)	MONTGOMERY	104	32
STA.		TO STA.		
FED. ROAD DIST. NO.		ILLINOIS FED. AID PROJECT		

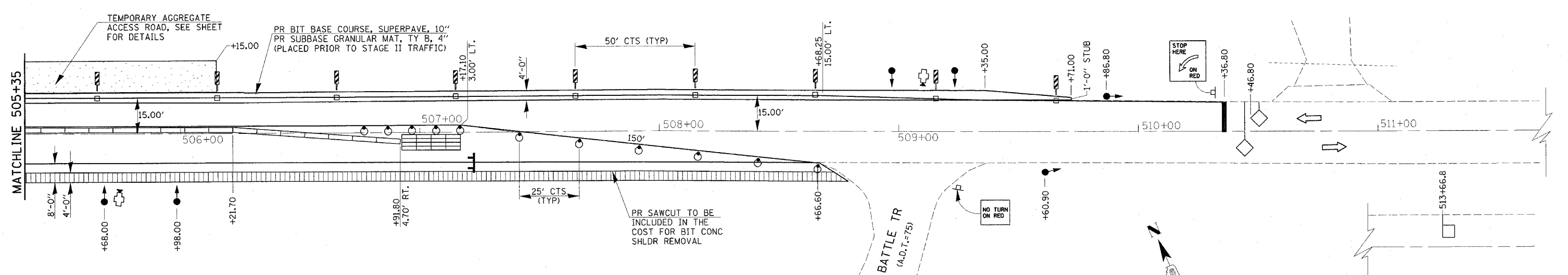
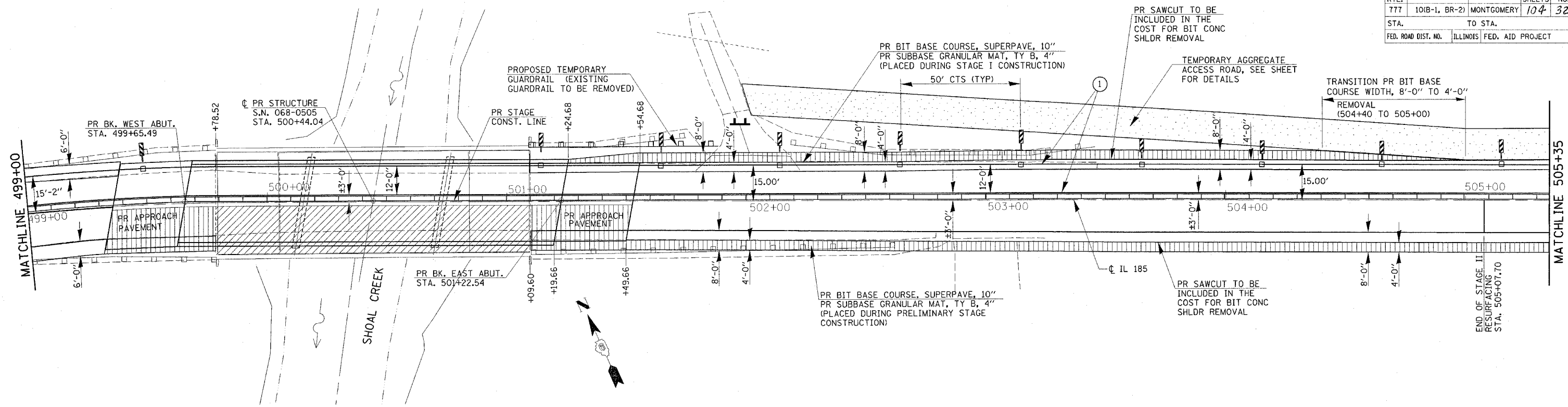

LEGEND

	BITUMINOUS WEARING SURFACE REMOVAL		MICROWAVE DETECTOR SYSTEM
	STRUCTURE REMOVAL		DIRECTION OF TRAFFIC
	PAVEMENT OR BIT. BASE COURSE REMOVAL		TEMPORARY TRAFFIC SIGNAL
	EXISTING BITUMINOUS SHOULDER REMOVAL		INDUCTION LOOP DETECTOR
	TEMPORARY CONCRETE BARRIER		TEMP. IMPACT ATTENUATOR (NON REDIRECT) TL 3
	DOUBLE VERTICAL PANEL		TYPE III BARRICADE
	WHITE BI-DIRECTIONAL TEMP. PAVEMENT MARKER		TEMPORARY PAVEMENT MARKING - LINE 5"
	DRUM WITH STEADY BURN LIGHT		TEMPORARY PAVEMENT MARKING - LINE 24"
			TEMP. IMPACT ATTENUATOR (FULLY REDIRECT NARROW) TL 3

REVISIONS	
NAME	DATE

ILLINOIS DEPARTMENT OF TRANSPORTATION
MAINTENANCE OF TRAFFIC & STAGING PLANS
STAGE II
 FAP 777 (IL RTE. 185)
 SECTION 10(B-1, BR-2)
 MONTGOMERY COUNTY

SCALE: VERT. _____
 HORIZ. _____
 DATE _____

DRAWN BY RTS
 CHECKED BY _____

PLT DATE = 1/23/2006
 PLOT SCALE = 20/0000' / IN.
 USER NAME = alegier