

| | | | | |
|-----------------------|----------------|----------------------|-------------|--------------|
| PROJECT NO. | SECTION | COUNTY | SHEETS | TOTAL SHEETS |
| 245 | 98-20101-00-BR | BUREAU | 65 | 15 |
| FED. ROAD DIST. NO. 7 | ILLINOIS | FED. AID PROJECT NO. | BROS-011621 | |

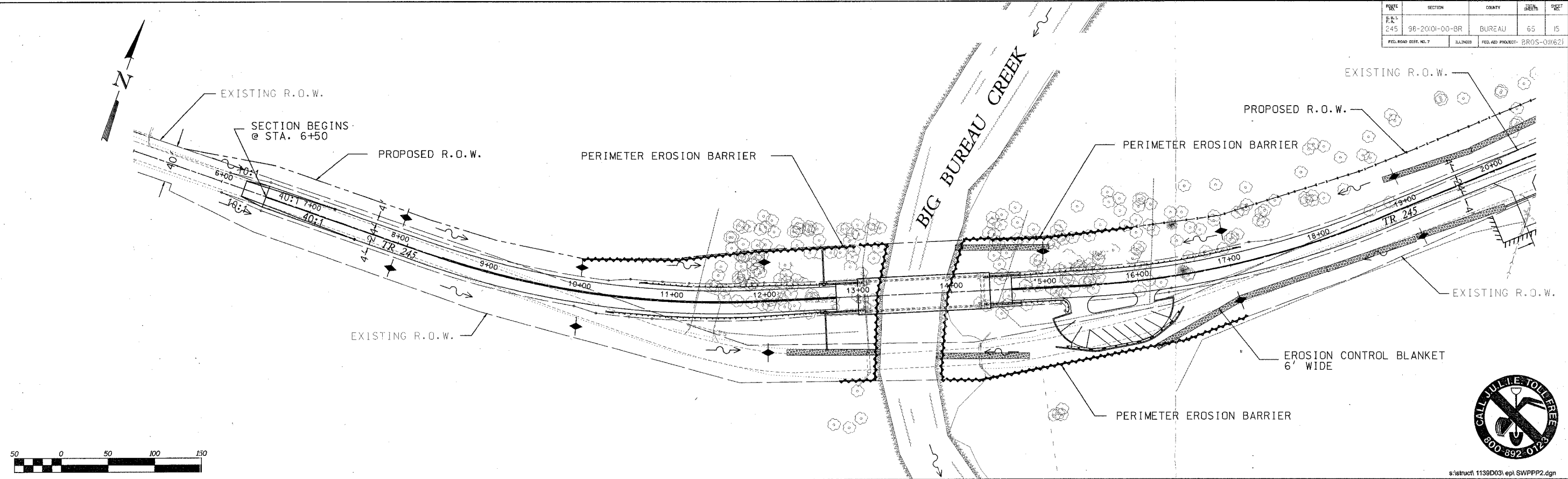

s:\structl. 1139D031 epl SWPPP2.dgn

STORM WATER POLLUTION PREVENTION PLAN

THE FOLLOWING PLAN IS ESTABLISHED AND INCORPORATED IN THE PROJECT TO DIRECT THE CONTRACTOR IN THE PLACEMENT OF TEMPORARY EROSION CONTROL SYSTEMS AND TO PROVIDE A STORM SEWER WATER POLLUTION PREVENTION PLAN FOR COMPLIANCE UNDER NPDES.

THE PURPOSE OF THIS PLAN IS TO MINIMIZE EROSION WITHIN THE CONSTRUCTION SITE AND TO LIMIT SEDIMENTS FROM LEAVING THE CONSTRUCTION SITE BY UTILIZING PROPER TEMPORARY EROSION CONTROL SYSTEMS AND PROVIDING GROUND COVER WITHIN A REASONABLE AMOUNT OF TIME.

CERTAIN EROSION CONTROL FACILITIES SHALL BE INSTALLED BY THE CONTRACTOR AT THE BEGINNING OF CONSTRUCTION. OTHER ITEMS SHALL BE INSTALLED BY THE CONTRACTOR AS DIRECTED BY THE ENGINEER ON A CASE BY CASE SITUATION DEPENDING ON THE CONTRACTOR'S SEQUENCE OF ACTIVITIES, TIME OF YEAR, AND EXPECTED WEATHER CONDITIONS.

THE CONTRACTOR SHALL INSTALL PERMANENT EROSION CONTROL SYSTEMS AND SEEDING WITHIN A TIME FRAME SPECIFIED HEREIN AND AS DIRECTED BY THE ENGINEER, THEREFORE MINIMIZING THE AMOUNT OF AREA SUSCEPTIBLE TO EROSION AND REDUCING THE AMOUNT OF TEMPORARY SEEDING. THE ENGINEER WILL DETERMINE IF ANY TEMPORARY EROSION CONTROL SYSTEMS SHOWN IN THE PLAN CAN BE DELETED AND IF ANY ADDITIONAL TEMPORARY EROSION CONTROL SYSTEMS, WHICH ARE NOT INCLUDED IN THIS PLAN, SHALL BE ADDED. THE CONTRACTOR SHALL PERFORM ALL WORK AS DIRECTED BY THE ENGINEER AND AS SHOWN IN STANDARD 280001 OF THE PLANS.

SECTION 280, TEMPORARY EROSION CONTROL, OF THE STANDARD SPECIFICATIONS ADDITIONALLY SUPPLEMENTS THIS PLAN.

SITE DESCRIPTION

DESCRIPTION OF CONSTRUCTION ACTIVITY:

1. THE PROJECT CONSISTS OF TOTAL RECONSTRUCTION OF TR 245 AND EPPERSON ROAD, AND REPLACEMENT OF A BRIDGE OVER BIG BUREAU CREEK.
2. CONSTRUCTION INCLUDES EARTH EXCAVATION, DRIVEWAYS, PIPE CULVERTS, VARIOUS PAVEMENT ITEMS, WOOD STRUCTURED BRIDGE AND OTHER MISCELLANEOUS ITEMS OF CONSTRUCTION.

DESCRIPTION OF INTENDED SEQUENCE FOR MAJOR CONSTRUCTION ACTIVITIES WHICH WILL DISTURB SOILS FOR MAJOR PORTIONS OF THE CONSTRUCTION SITE:

1. INSTALL PERIMETER EROSION BARRIER AS DIRECTED BY THE ENGINEER.
2. EARTH EXCAVATION
3. CULVERT AND STORM SEWER INSTALLATION
4. AGGREGATE BASE, PCC SURFACE, BRIDGE, AND RELATED APPURTENANCES
5. PLACEMENT OF PERMANENT EROSION CONTROL IN DITCHES AND AROUND CULVERTS INCLUDING SEEDING, EROSION CONTROL MULCH, DITCH CHECKS, ETC.

AREA OF CONSTRUCTION SITE:

THE TOTAL AREA OF THE CONSTRUCTION IS ESTIMATED TO BE 7.21 ACRES OF WHICH 7.21 ACRES WILL BE DISTURBED BY EXCAVATION, GRADING, AND OTHER ACTIVITIES.

OTHER REPORTS, STUDIES AND PLANS WHICH AID IN THE DEVELOPMENT OF THE STORM SEWER POLLUTION PREVENTION PLAN AS REFERENCED DOCUMENTS:

1. INFORMATION OF THE SOILS AND TERRAIN WITHIN THE SITE WAS OBTAINED FROM TOPOGRAPHIC SURVEYS AND SOIL BORINGS THAT WERE UTILIZED FOR THE DEVELOPMENT OF THE PROPOSED TEMPORARY EROSION CONTROL SYSTEMS.
2. PROJECT PLANS, DOCUMENTS, SPECIFICATIONS AND SPECIAL PROVISIONS, AND PLAN DRAWINGS INDICATING DRAINAGE PATTERNS AND APPROXIMATE SLOPES ANTICIPATED AFTER GRADING ACTIVITIES WERE UTILIZED FOR THE PROPOSED PLACEMENT OF THE TEMPORARY EROSION CONTROL SYSTEMS.

DRAINAGE TRIBUTARIES AND SENSITIVE AREAS RECEIVING RUNOFF FROM THIS CONSTRUCTION SITE:

1. DITCH OUTLETS AND CULVERT FLOWS INTO THE BIG BUREAU CREEK AND EPPERSON RUN

LEGEND



- TEMPORARY DITCH CHECK
- EROSION CONTROL BLANKET
- PERIMETER EROSION BARRIER - SILT FILTER FENCE OR OTHER AS APPROVED BY THE ENGINEER

NOTE: ALL ITEMS SHALL BE CONSTRUCTED AS SHOWN ON STANDARD 280001 AND AS DIRECTED BY THE ENGINEER. MAINTENANCE AND CLEANING OF THE EROSION CONTROL ITEMS SHALL BE INCLUDED IN THE RESPECTIVE EROSION CONTROL PAY ITEM.

STORM WATER POLLUTION PREVENTION PLAN
TR 245

