

F.A.U. NO.	SECTION	COUNTY	TOTAL SHEETS	SHEET NO.
2582	03-00084-00-BT	COOK	29	7
STA. 15+50	TO STA. 21+00			
FED. ROAD DIST. NO. 1 [ILLINOIS] FED. AID PROJECT				

CONTRACT NO. 83831

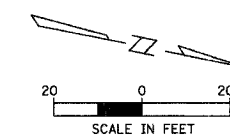

PI	AN	SUBMITTED	DATE
NO.	NO.	NO.	NO.
NO.	NO.	NO.	NO.

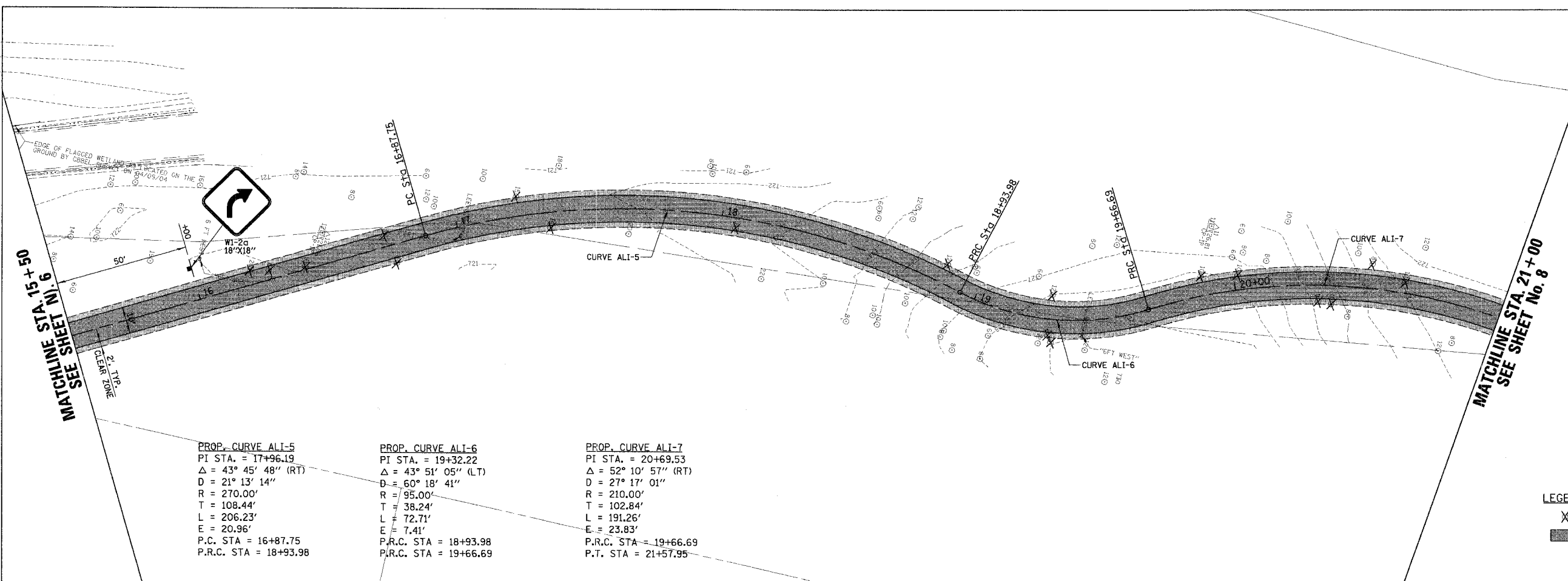

PROP. CURVE ALI-5  
 PI STA. = 17+96.19  
 $\Delta = 43^\circ 45' 48''$  (RT)  
 $D = 21^\circ 13' 14''$   
 $R = 270.00'$   
 $T = 108.44'$   
 $L = 206.23'$   
 $E = 20.96'$   
 P.C. STA = 16+87.75  
 P.R.C. STA = 18+93.98

PROP. CURVE ALI-6  
 PI STA. = 19+32.22  
 $\Delta = 43^\circ 51' 05''$  (LT)  
 $D = 60^\circ 18' 41''$   
 $R = 95.00'$   
 $T = 38.24'$   
 $L = 72.71'$   
 $E = 7.41'$   
 P.R.C. STA = 18+93.98  
 P.T. STA = 19+66.69

PROP. CURVE ALI-7  
 PI STA. = 20+69.53  
 $\Delta = 52^\circ 10' 57''$  (RT)  
 $D = 27^\circ 17' 01''$   
 $R = 210.00'$   
 $T = 102.84'$   
 $L = 191.26'$   
 $E = 23.83'$   
 P.R.C. STA = 19+66.69  
 P.T. STA = 21+57.95

- LEGEND:
- X TREE REMOVAL
  - BITUMINOUS BIKE PATH
  - BITUMINOUS CONCRETE SURFACE COURSE, SUPERPAVE, MIX C, N50 (NON OC/OA), 3"
  - AGGREGATE BASE COURSE, TYPE B, 8"

PROF	FILE	DATE
NO.	NO.	NO.
NO.	NO.	NO.

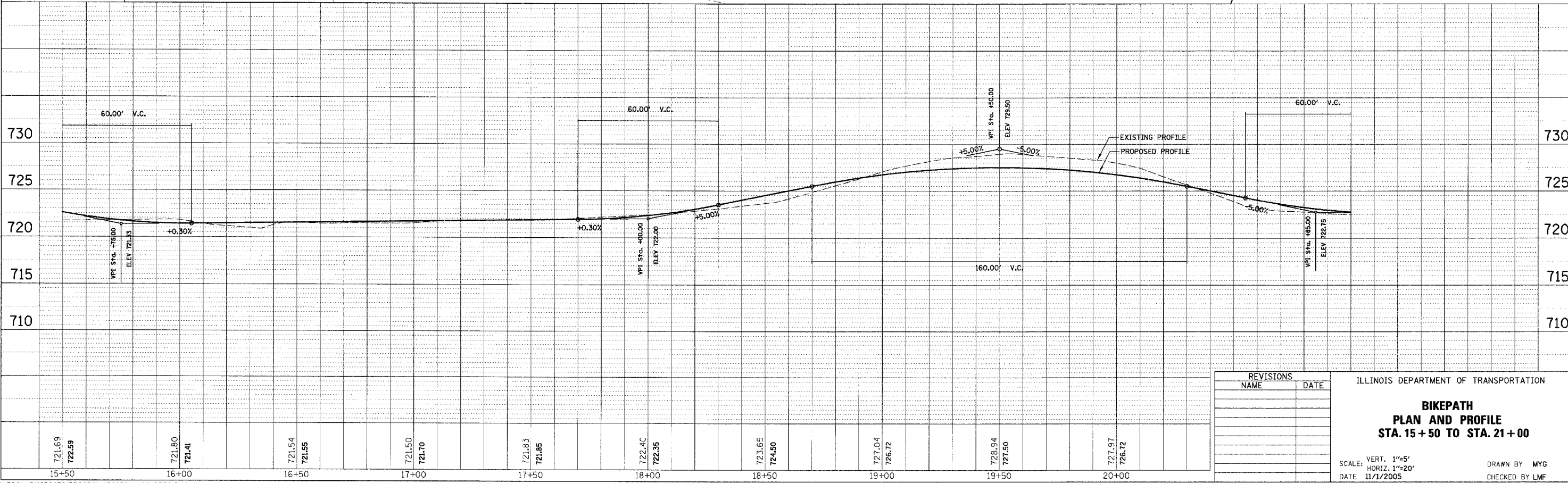

REVISIONS	NAME	DATE

ILLINOIS DEPARTMENT OF TRANSPORTATION

**BIKEPATH  
 PLAN AND PROFILE  
 STA. 15 + 50 TO STA. 21 + 00**

SCALE: VERT. 1"=5'  
 HORIZ. 1"=20'

DATE 11/1/2005

DRAWN BY MYG  
 CHECKED BY LMF