

F.A.U. RTE.	SECTION	COUNTY	TOTAL SHEETS	SHEET NO.
6659		PEORIA	40	33
STA. 381+50.00		TO STA. 381+75.00		
FED. ROAD DIST. NO.		ILLINOIS FED. AID PROJECT		
40' BOX CULVERT EXT 2006				

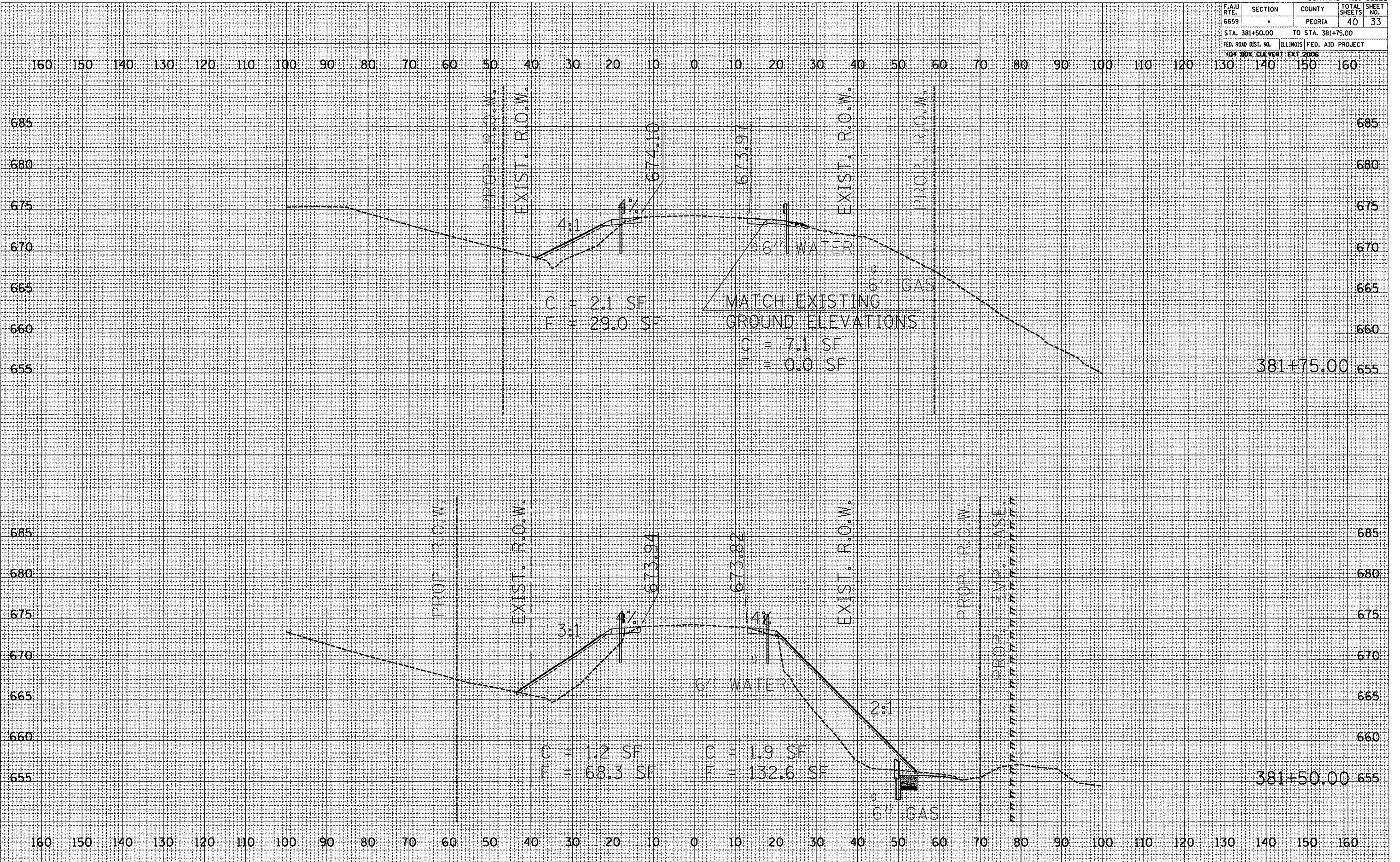

FINAL SURVEY BY DATE
 SURVEYED BY DATE
 TEMPLATE AREAS CHECKED
 NOTE BOOK AREAS CHECKED
 NO.

ORIGINAL SURVEY BY DATE
 SURVEYED BY DATE
 TEMPLATE AREAS CHECKED
 NOTE BOOK AREAS CHECKED
 NO.

PLOT DATE: 12/19/2005
 FILE NAME: e:\projects\form\asest\asest\plot\33.dwg
 PLOT SCALE: 2.65072 / IN.
 REFERENCE: SHEETS