

F.A.I. RTE.	SECTION	COUNTY	TOTAL SHEETS	SHEET NO.
180	06-3.78-1(BM-1)		15	8
STA.		TO STA.		
FED. ROAD DIST. NO.		ILLINOIS FED. AID PROJECT		
•• Putnam Counties				

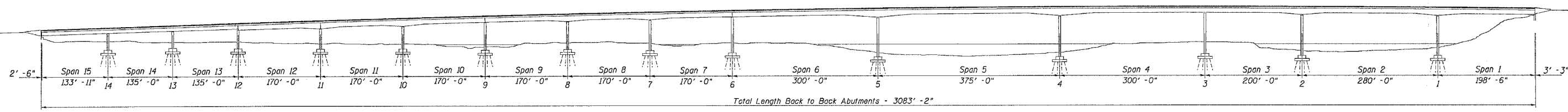

Elevation

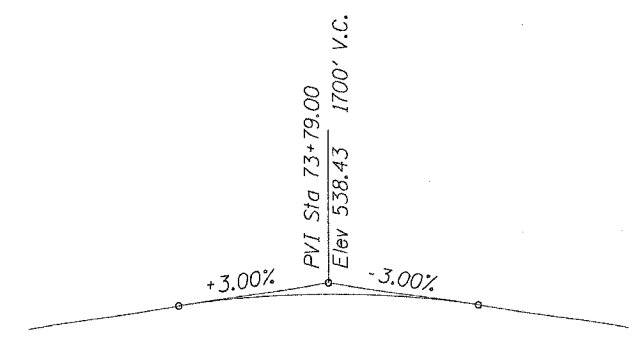

Grade Profile

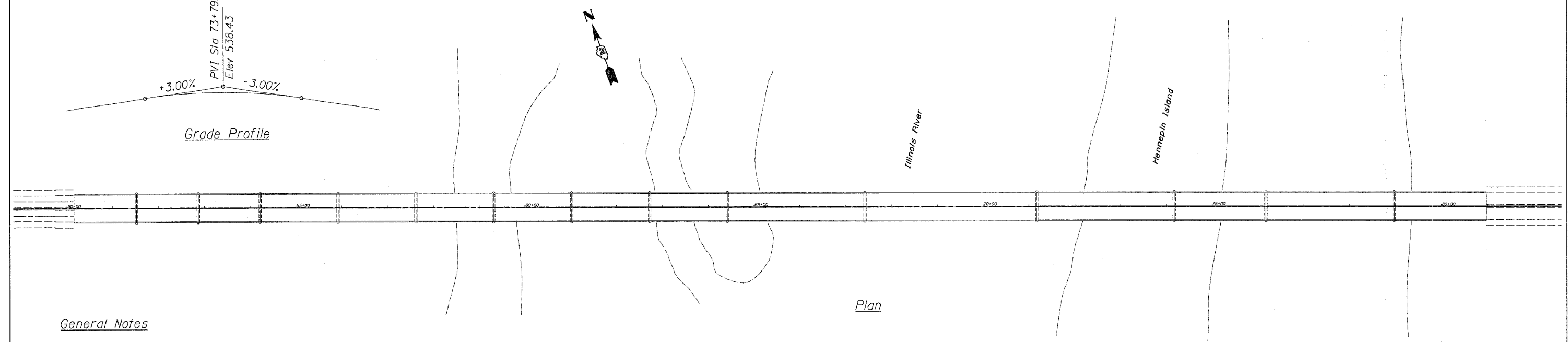

Plan

General Notes

Field welding of construction accessories will not be permitted to beams or girders.

Reinforcement bars shall conform to the requirements of AASHTO M31 or M322 Grade 60.

Plan dimensions and details relative to existing structure have been taken from existing plans and are subject to nominal construction variations. It shall be the Contractor's responsibility to verify such dimensions and details in the field and make necessary approved adjustments prior to construction or ordering of materials. Such variations shall not be cause for additional compensation for a change in the scope of the work, however, the Contractor will be paid for the quantity actually furnished at the unit price for the work.

The existing structural steel coating contains lead. The Contractor shall take appropriate precautions to deal with the presence of lead on this project.

All structural steel shall conform to AASHTO Classification M-270 Gr. 50, unless otherwise noted.

All structural steel shall be shop painted with the inorganic zinc rich primer per AASHTO M300, Type 1. Cost included with Furnishing and Erecting Structural Steel

Total Bill of Material

Item	Unit	Quantity
Bituminous Concrete Removal (Deck)	Sq. Yd.	19935
Sheet Waterproofing Membrane System	Sq. Yd.	19935
POLYMERIZED BITUMINOUS CONCRETE SURFACE COURSE, SUPERPAVE, MIX "D", N70	Ton	2671
Deck Slab Repair (Partial)	Sq. Yd.	300
Deck Slab Repair (Full Depth - Type I)	Sq. Yd.	100
Deck Slab Repair (Full Depth - Type II)	Sq. Yd.	100
Fabric Reinforced Elastomeric Trough	Lin. Ft.	276
Silicone Joint Sealer, 1"	Lin. Ft.	260
Furnishing and Erecting Structural Steel	Pound	5700

General Plan & Elevation
 FAI 180 (I-180)
 Section (06-3.78-1)BM-1
 Bureau & Putnam Counties
 Structure No. 078-0001

PLOT DATE = Mon, Dec 19, 13:13:46, 2005
 FILE NAME = D:\SRV\plans\0780001\0780001.dgn
 PLOT SCALE = 50.00000 / IN.
 REFERENCE = REF#