

STATE OF ILLINOIS
DEPARTMENT OF TRANSPORTATION

4 - #16 h bars (equally spaced in seat)

6 - #16 h bars in back wall as shown. Refer to Concrete Seat Detail.

Re-Construct Stone Abutment Wingwall On The Northeast Quadrant Of Structure To Match Opposite Side. See "Abutment Wingwall Repair Detail."

Timber Blocking At Midspan And 508mm From Both Ends Of Timber Stringers, See "Timber Blocking Detail"

150mmx150mm Treated Timber Rail Post (Typ.)

Galvanized Steel Angle Attached To Treated Timber Stringer Refer to "Bridge Details" Sheet.

150mmx150mm Treated Timber Spacer Post

Timber Approach Handrail, See "General Notes Bridge" Sheet and "Bridge Details" Sheet

M20x15mm Anchor Bolts (1 Per Angle) Typical.

Timber Bridge Railing. See Plan View on Sheet 102 for Rail Post Spacing. See "Bridge Details" Sheet 105 for Rail Attachment.

Elev. 244.025

Elev. 243.391

Path

100mmx305mm Transverse Timber Decking

150mmx150mm Treated Timber Curb

Back Of Conc. Abutment
Face Of Conc. Seat

Existing Stone Abutment (Typ.)

**3.700m Out-to-Out of Deck

3.600m Clear

1.800m

L 150mmx200mmx19mm Galvanized Angle (150mm Long) Located On Timber Stringers (10 Req'd.), See "Bridge Details" Sheet

562mm 533mm 533mm 533mm 533mm 562mm

100mm Transverse Timber Decking, 3.70m

*** Attach Each Transverse Timber Decking to the Center and Outer Treated Timber Stringers. Alternate Sides of Center Stringer. See "Bridge Details" Sheet for Timber Deck Angle Detail.

150mmx406mm Treated Timber Stringer

150mmx150mm Treated Timber Spacer Post 406mm Long With Beveled End

50mmx200mm Timber Blocking, See "Timber Blocking Detail"

Anchor Bolt

5.334m Out-to-Out of Concrete

Drill And Grout To Existing Stone Abutment, 230mm Min. Embedment Length (Typical). Grout To Be Installed Per Section 584 of the Standard Specifications. See Special Provisions.

Existing Stone Abutment

SECTION THRU DECK NOT TO SCALE

** Note: Dimensional lumber may vary in furnished size. Clear width of the deck shall be 3.600m minimum.

* The Concrete Abutment back wall above the Existing Stone Abutment shall be cast after the Timber Stringers have been set in place. Field verify dimension to match Top of Timber Deck Elevation.

Note: Space reinforcement to avoid anchor bolts.

5.334m Out-to-Out of Concrete

2.667m

18 - #13 v bars at ±305mm cts. (back face)
18 - #13 v bars at ±305mm cts. (front face)

50mm cl.

50mm cl.

100mm (Min.)

18 - #13 h₁ bars at ±305mm cts.

305mm

1080mm

775mm

2.286m

3.836m

4.446m

Offset Blocking At Midspan To Avoid Timber Post Bolt Holes

150mmx406mmx3.810m Treated Timber Stringers (7)

Front Face of Concrete Abutment

PLAN NOT TO SCALE

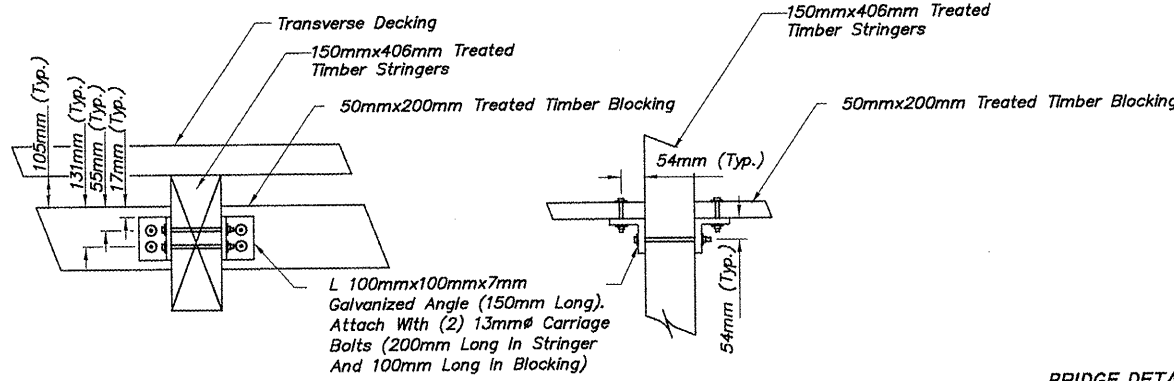

ELEVATION VIEW PLAN VIEW

TIMBER BLOCKING DETAIL NOT TO SCALE

BRIDGE DETAILS
BRIDGE 130
OVER A MINOR DITCH
TRIBUTARY TO THE S KENT CREEK
WINNEBAGO COUNTY
SECTION NO. 94-00267-00-BT
STATION 46+724.37

SHEET 2 OF 3

SHEET REVIEW	
AGENCY	DATE

REVISIONS		
NO.	ITEM	DATE

SCALE:	N/A
DRAWN BY:	REK
CHECKED BY:	JWH
DATE:	DECEMBER 12, 2011

7282 Arroyo Drive Rockford, Illinois 61107-6837 (815) 398-2332	McClure Engineering Associates, Inc. Rockford, Illinois 61107-6837 FAX (815) 398-2495 Design Firm License: Illinois 184-000816 Copyright 2011 By McClure Engineering Associates, Inc.
--	---

BRIDGE NO. 130 DETAILS I	
PECATONICA PRAIRIE PATH	
WINNEBAGO COUNTY HIGHWAY DEPARTMENT	SECTION 94-00267-00-BT
FILE:H:\10-042 WINN CO PEC PATH\DESIGN\DRAWINGS\BRIDGES\10-042 B129-130.DWG	JOB:04-30-10-042

SHEET NO.	103
OF	107