

NOTE: STATIONING SHOWN FOR THE 3' SAFETY SHOULDERS WAS TAKEN FROM THE SURVEY DONE IN THIS LOCATION ONLY.

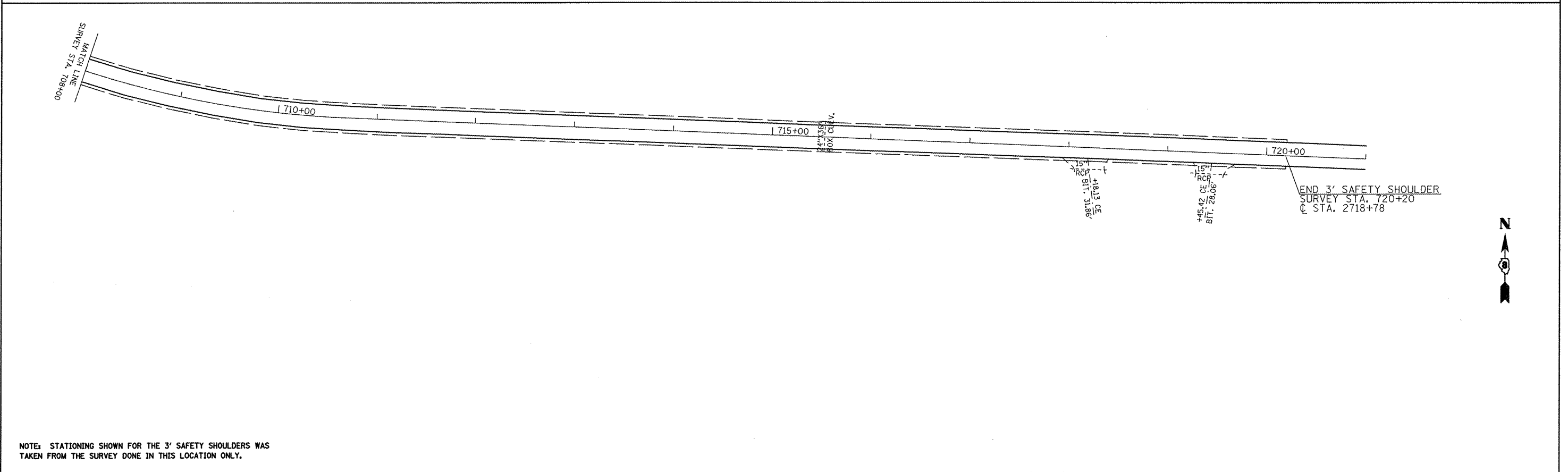

NOTE: STATIONING SHOWN FOR THE 3' SAFETY SHOULDERS WAS TAKEN FROM THE SURVEY DONE IN THIS LOCATION ONLY.

FILE NAME =	USER NAME = conoverp.j	DESIGNED -	REVISED -
c:\pwork\pwork\conoverp\ad212697\d0652-sht-pl.dgn		DRAWN -	REVISED -
PLOT SCALE = 100.0000' / 1 in.		CHECKED -	REVISED -
PLOT DATE = 1/9/2012		DATE -	REVISED -

**STATE OF ILLINOIS  
DEPARTMENT OF TRANSPORTATION**

SAFETY SHOULDER LOCATIONS	
SCALE:	SHEET NO. 1 OF 1 SHEETS
STA.	TO STA.

F.A.P. RTE.	SECTION	COUNTY	TOTAL SHEETS	SHEET NO.
* 322/821	(10-1,11)RS-3	WASHINGTON	18	18
FED. ROAD DIST. NO.		ILLINOIS FED. AID PROJECT		

CONTRACT NO. 76E52