

EAST EDGE OF SHOULDER

Location	Station	Offset	Theoretical Grade Elevations
N. End North Appr. Slab	152+56.43	-18.00	684.34
A1	152+66.43	-18.00	684.37
A2	152+76.43	-18.00	684.40
S. End North Appr. Slab	152+86.43	-18.00	684.43

EAST EDGE OF PAVEMENT

Location	Station	Offset	Theoretical Grade Elevations
N. End North Appr. Slab	152+62.43	-12.00	684.48
A1	152+72.43	-12.00	684.51
A2	152+82.43	-12.00	684.54
S. End North Appr. Slab	152+92.43	-12.00	684.57

☉ ROADWAY & PROFILE GRADE

Location	Station	Offset	Theoretical Grade Elevations
N. End North Appr. Slab	152+74.43	0.00	684.71
A1	152+84.43	0.00	684.74
A2	152+94.43	0.00	684.77
S. End North Appr. Slab	153+04.43	0.00	684.79

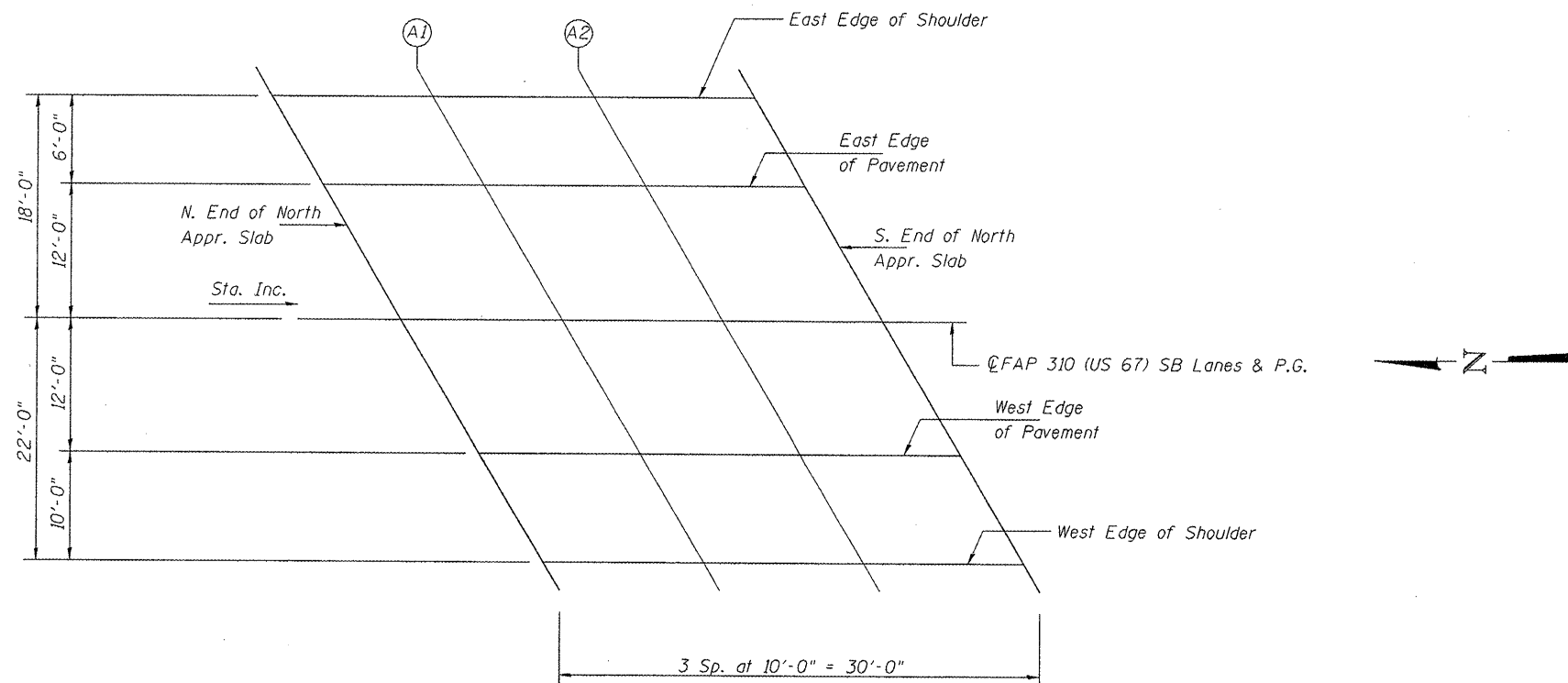

PLAN

North Approach (S.B.)

WEST EDGE OF PAVEMENT

Location	Station	Offset	Theoretical Grade Elevations
N. End North Appr. Slab	152+86.43	12.00	684.55
A1	152+96.43	12.00	684.58
A2	153+06.43	12.00	684.62
S. End North Appr. Slab	153+16.43	12.00	684.65

WEST EDGE OF SHOULDER

Location	Station	Offset	Theoretical Grade Elevations
N. End North Appr. Slab	152+96.43	22.00	684.38
A1	153+06.43	22.00	684.41
A2	153+16.43	22.00	684.44
S. End North Appr. Slab	153+26.43	22.00	684.47

Offsets are measured from ☉ SB lanes.

FILE NAME =	USER NAME = seb	DESIGNED - KTH	REVISED -
P:\07\files\070286\Phase2\Bridg Plans\10_Top_N-ApproachSlabElev.dgn		CHECKED - ADL	REVISED -
	PLOT SCALE = 0:2.0000" = 1" IN.	DRAWN - BGJ	REVISED -
	PLOT DATE = 12/7/2011	CHECKED - RJP	REVISED -

**STATE OF ILLINOIS
DEPARTMENT OF TRANSPORTATION**

**TOP OF NORTH APPROACH SLAB ELEVATIONS
S.N. 055-0081 (SB)**

F.A.P. RTE.	SECTION	COUNTY	TOTAL SHEETS	SHEET NO.
310	(38B-2)BR	MCDONOUGH	130	67
CONTRACT NO. 68691			ILLINOIS FED. AID PROJECT	

SHEET NO. 10 OF 35 SHEETS

Klinaner & Associates P.C.