

2.14' 25 on N wing of S Abut. Bridge  
Sta. 153+20 Elev. 679.07  
Existing Structure to be removed  
by Bridge Contractors  
No Salvage  
Exist. Struct. R.C. Deck Girder, R.C. Closed Abuts.  
20 ft. Spacing.

STATE OF ILLINOIS  
DEPARTMENT OF PUBLIC WORKS & BUILDINGS  
DIVISION OF HIGHWAYS

Sheet No. 1	6 Sheets
-------------	----------

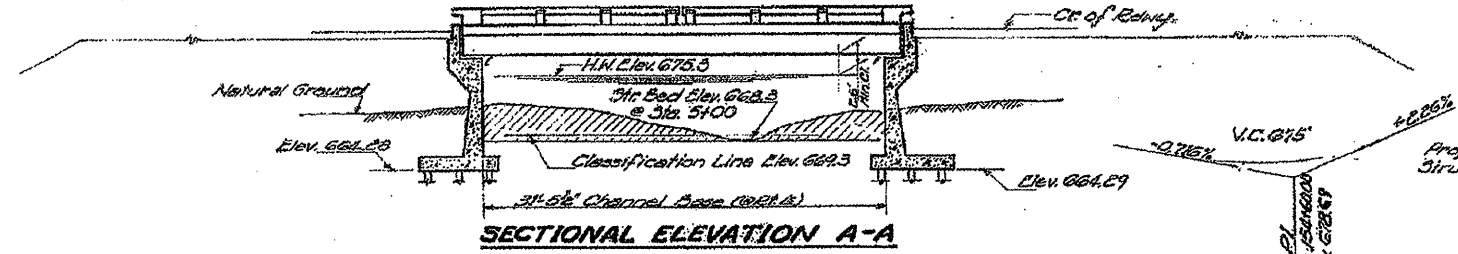

SECTIONAL ELEVATION A-A

PROFILE S.B.I. RT. 3

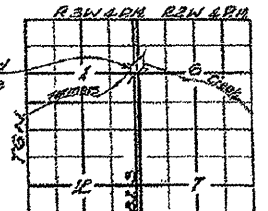

LOCATION PLAN

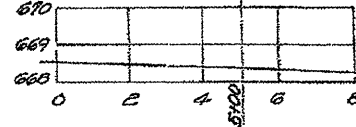

PROFILE OF STREAMBED

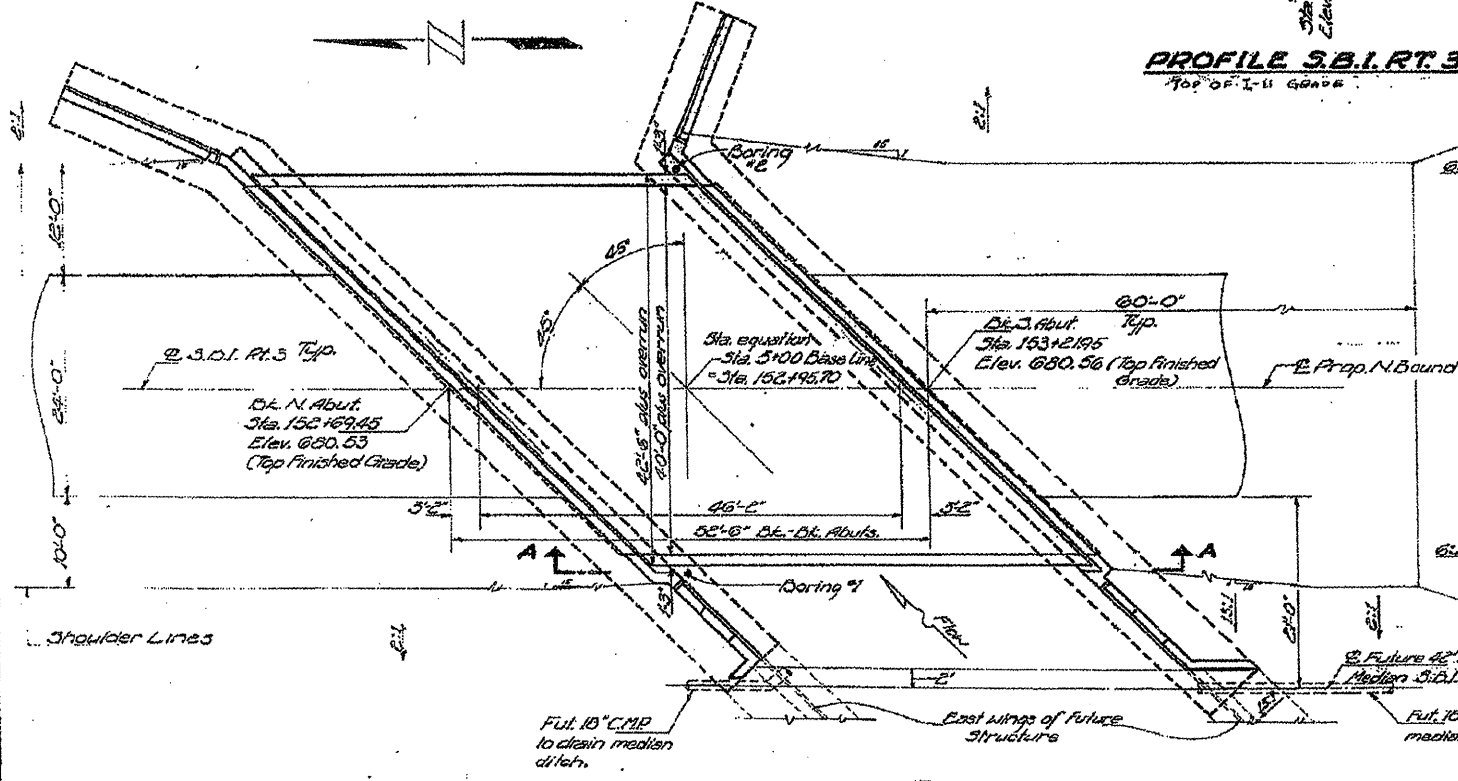

PLAN

**DESIGN STRESSES**  
PRECAST PRESTRESSED UNITS  
 $f'_c = 5000$  psi  
 $f_{ci} = 4000$  psi  
 $f_s = 240,000$  psi (Cable Steel)  
 $f_{si} = 175,000$  psi

**FIELD UNITS**  
 $f_c = 1400$  psi Super  
 $f_c = 1000$  psi Sub. & Allinqualis  
 $v_c = 25$  psi Flex.  
 $f_s = 20000$  psi. Reinf.  
 $n = 10$

LOADING H20-S16-44

**WATERWAY INFORMATION**

Drainage Area - 2546 Acres  
 Channel - Rolling, deep, cultivated  
 Reg'd. Opening - 220 Sq. Ft.  
 Present Opening - 180 Sq. Ft.  
 Proposed Opening - 220 Sq. Ft.  
 Ordinary Water Elev. 668.8

**GENERAL NOTES**

For Item Precast Prestressed Concrete Bridge Deck see Supplemental Specifications, effective March 2, 1964.  
 Strand used as prestressing element shall be non-galvanized high strength, stress relieved wire strand. The nominal diameter of the strand shall not exceed  $\frac{1}{8}$  and the nominal cross-sectional area shall be 0.1059 sq. in. (1/8).  
 Packets that receive transverse tie rod on exterior beams shall be filled with grout after transverse tie assembly is in place.  
 The 1<sup>st</sup> rods in the transverse tie assembly shall be tightened to a snug fit and the threads set.  
 Class X Concrete shall be used throughout except as noted.  
 The handrail concrete in the rail post and railing shall be poured in separate operations.  
 All reinforcement bars shall be lapped 20 diameters unless otherwise shown.  
 The exposed surfaces of the expansion guard shall be given two shop coats of red lead paint. The contact surfaces shall be given one coat of red lead paint. Anchor studs shall not be painted.  
 The Contractor shall drive two (2) test piles, one (1) timber pile at N. Abut. and one (1) timber pile at S. Abut. in permanent location as directed by the Engineer before ordering the remaining piles.  
 The following surfaces shall be water proofed, the back of the abutments and wingwalls from the top of the footing to the top of the earth fill.

**TOTAL BILL OF MATERIAL**

Item	Super	Sub	Total
Aluminous Concrete			
Surf. Course Sub-Class F1(14) Item 1B			18
Removal of Existing Struct. Co.			1
Class 1 <sup>st</sup> Excavation	cu. Yds.		190
Class 1 <sup>st</sup> Excavation	cu. Yds.		450
Structural Steel	lbs.		3040
Precast Prestressed Concrete Bridge Deck	Sq. Ft.	2016	2016
Handrail Concrete	cu. Yds.	3.0	3.0
Class X Concrete	cu. Yds.	42	2771
Reinforcement Bars	Lbs.	2700	19250
Untreated Piles	lin. Ft.		2575
Test Piles (Timber)	cu. Yds.	2	2
Name Plate	ea.		1
Bridge Deck Sealant	Sq. Yds.	215	215
Protective Coat	Sq. Yds.		50
Bridge Joint Sealant	Lump Sum		1

\* Applied at Abutments.

**PROJ. F-92 (10)**  
**GENERAL PLAN AND ELEVATION**  
**FARMERS CREEK**  
**S.B.I. RT. 3 SEC. 38BR**  
**MCDONOUGH COUNTY**  
**STA. 152+95.70**

DESIGNED K.L. Figg  
 CHECKED J. Sander  
 DRAWN J. Sander  
 EXAMINED W.D. Bauman  
 PASSED J.P. Smith  
 APPROVED J.P. Smith

STATION 152+95.70  
 BUILT 196 BY  
 STATE OF ILLINOIS  
 S.B.I. RT. 3 SEC. 38BR  
 F.A. PROJ. - F-92 (10)  
 LOADING H20-S16  
**NAME PLATE**  
 See Std. 2113-1

FILE NAME =	USER NAME = eob	DESIGNED -	REVISED -	STATE OF ILLINOIS	EXISTING BRIDGE PLANS	F.A.P. RTE. 310	SECTION (38B-21BR)	COUNTY MCDONOUGH	TOTAL SHEETS 130	SHEET NO. 52
PA:\07\files\078286\Phase2\CADD Sheets\08691-shr-exbridge.dgn		DRAWN -	REVISED -	DEPARTMENT OF TRANSPORTATION	SCALE: none	SHEET NO. 1 OF 6 SHEETS	STA. TO STA.	CONTRACT NO. 68691	ILLINOIS FED. AID PROJECT	
		CHECKED -	REVISED -							
		DATE -	REVISED -							