

A PIPE CULVERTS, CLASS D, TYPE I 18" (TEMPORARY)
 STA 141+50.0, 33.3' RT; US ELEV. = 686.90
 STA 146+70.0, 33.3' RT; DS ELEV. = 682.40
 LENGTH = 520'; SLOPE = 0.87%

REMOVE EXISTING GUARDRAIL TERMINAL SECTION
 INSTALL TEMPORARY SPBGR TYPE A, 62.5'
 TEMPORARY TAFFIC BARRIER TERMINAL, TYPE 1 SPECIAL (FLARED)

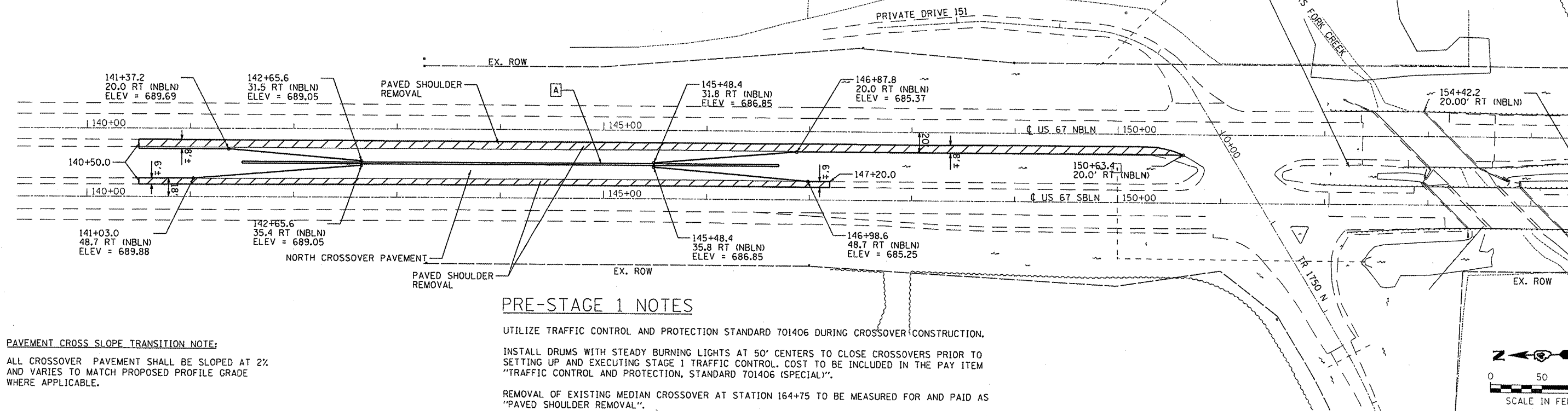

PRE-STAGE 1 NOTES

UTILIZE TRAFFIC CONTROL AND PROTECTION STANDARD 701406 DURING CROSSOVER CONSTRUCTION.
 INSTALL DRUMS WITH STEADY BURNING LIGHTS AT 50' CENTERS TO CLOSE CROSSOVERS PRIOR TO SETTING UP AND EXECUTING STAGE 1 TRAFFIC CONTROL. COST TO BE INCLUDED IN THE PAY ITEM "TRAFFIC CONTROL AND PROTECTION, STANDARD 701406 (SPECIAL)".
 REMOVAL OF EXISTING MEDIAN CROSSOVER AT STATION 164+75 TO BE MEASURED FOR AND PAID AS "PAVED SHOULDER REMOVAL".
 ALL COMMERCIAL, PRIVATE, AND FIELD ENTRANCES SHALL HAVE SUITABLE ACCESS, AS DETERMINED BY THE ENGINEER, AT ALL TIMES.

PAVEMENT CROSS SLOPE TRANSITION NOTE:
 ALL CROSSOVER PAVEMENT SHALL BE SLOPED AT 2% AND VARIES TO MATCH PROPOSED PROFILE GRADE WHERE APPLICABLE.

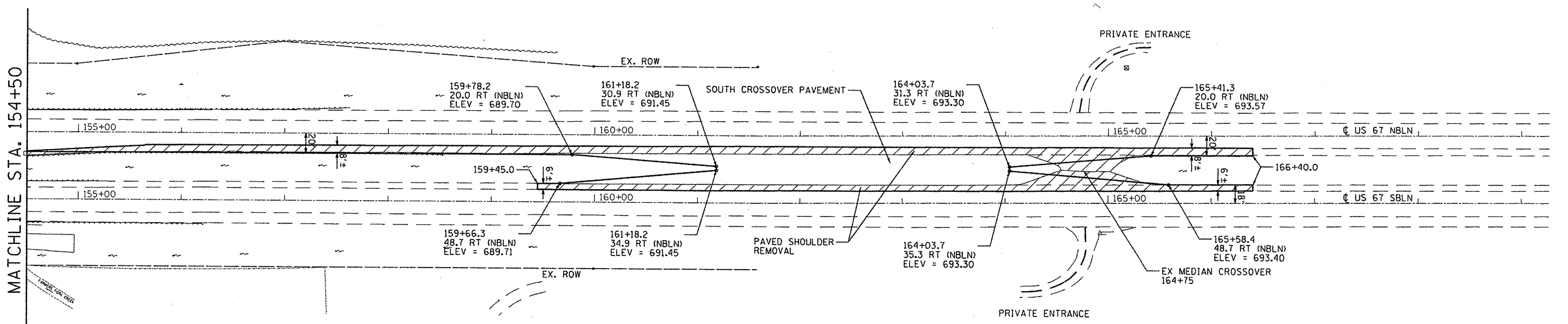

PAVEMENT CROSS SLOPE TRANSITION NOTE:
 ALL CROSSOVER PAVEMENT SHALL BE SLOPED AT 2% AND VARIES TO MATCH PROPOSED PROFILE GRADE WHERE APPLICABLE.

FILE NAME =	USER NAME = seb	DESIGNED -	REVISED -
pi:\07\files\070286\phase2\cadd sheets\068691-sht-staging1.dgn		DRAWN -	REVISED -
		CHECKED -	REVISED -
		DATE -	REVISED -

**STATE OF ILLINOIS
 DEPARTMENT OF TRANSPORTATION**

**MAINTENANCE OF TRAFFIC
 PRE-STAGE 1 CONSTRUCTION PLAN**

SCALE: 1"=50' SHEET NO. 3 OF 18 SHEETS STA. 140+00 TO STA. 169+00

F.A.P. RTE.	SECTION	COUNTY	TOTAL SHEETS	SHEET NO.
310	(388-2)BR	MCDONOUGH	130	29
CONTRACT NO. 68691				
ILLINOIS FED. AID PROJECT				