

TRAFFIC SIGNAL CONSTRUCTION SUMMARY

1. Detector loops on Illinois 17 are existing and will be removed by the milling operation. Replace the detector loops as shown.
2. Existing detector loop lead-in cable shall be tested prior to splicing onto the new detector loop. Existing detector loop lead-in testing good shall be reused. Testing of the existing detector loop and lead-in cable shall be included in the price for Detector Loop Type I.
3. The contractor shall perform detector testing on the existing loops remaining at this intersection to confirm they remain intact. Damaged loops may be replaced at the direction of the resident.
4. The northbound and southbound detector loops are new.
5. Install inductive loop detectors, harnesses, and necessary parts to place the new inductive loop detectors in operation.
6. Southeast quadrant: Remove sidewalk as necessary. Drill existing handhole to insert two 1-1/2" conduits for the tails of the new detectors.
7. Northwest quadrant: Remove sidewalk as necessary. Drill existing handhole to insert one 1-1/2" conduits for the tail of the new detectors.

SCHEDULE OF QUANTITIES			
CONDUIT IN TRENCH, 1 1/2" DIA., PVC	FOOT	12	
ELECTRIC CABLE IN TRENCH, LEAD-IN, NO. 14 1 PAIR	FOOT	230	
DRILL EXISTING HANDHOLE	EACH	3	
INDUCTIVE LOOP DETECTOR (SPECIAL)	EACH	2	
DETECTOR LOOP, TYPE I	FOOT	703	
PORTLAND CEMENT CONCRETE SIDEWALK 4 INCH	SQ FT	72	
SIDEWALK REMOVAL	SQ FT	72	
TRENCH BACKFILL FOR ELECTRICAL WORK	FOOT	8	

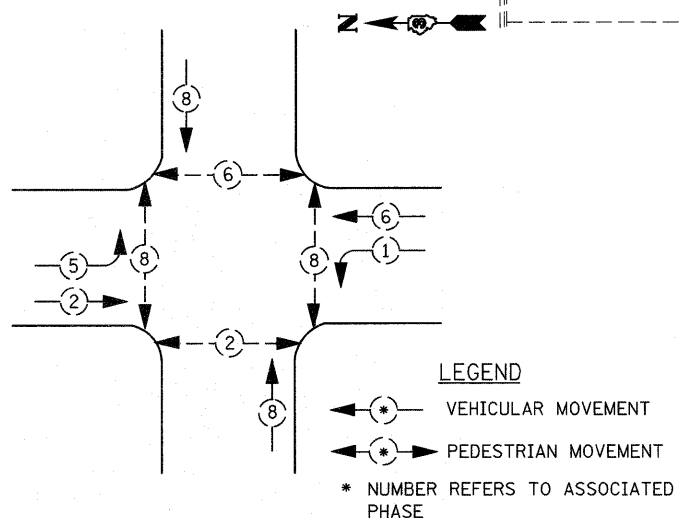
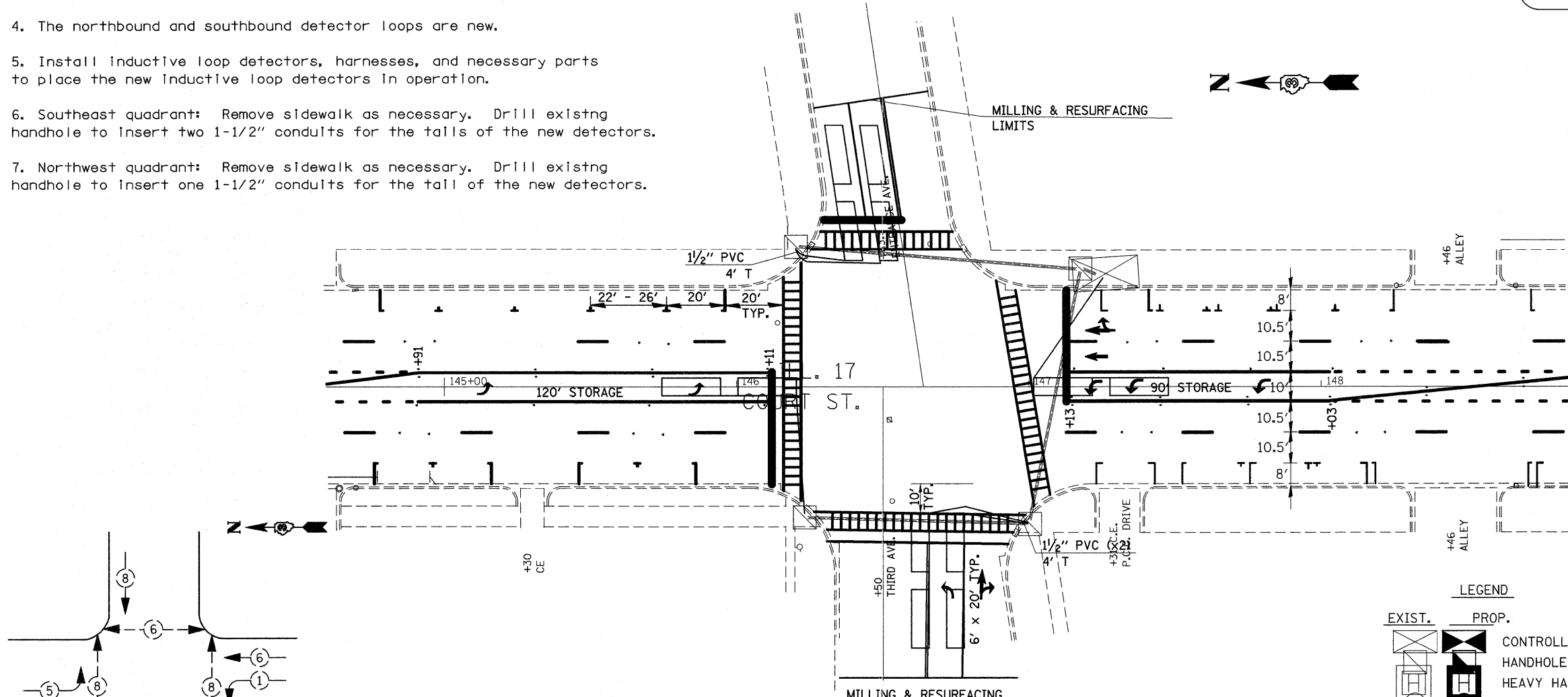
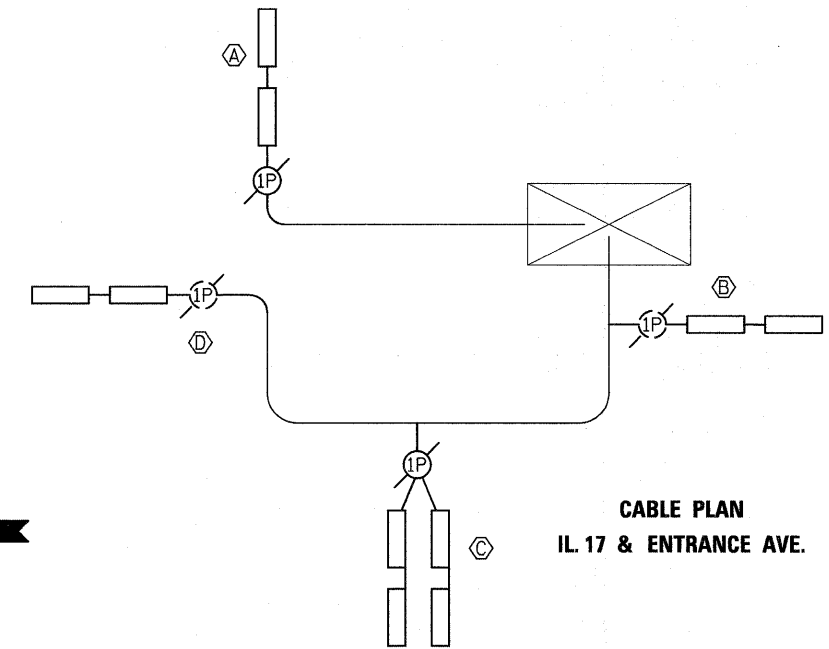

EXISTING PHASE DESIGNATION DIAGRAM
IL 17 & ENTRANCE AVENUE

DETECTOR LOOP INDUCTANCE CHART IL ROUTE 17 & ENTRANCE AVE				
LOOP SYSTEM	LABEL	NO. OF TURNS	INDUCTANCE (uH)	FREQUENCY (Hertz)
A	SB	3	341	33049
B	WBLT	3	324	33902
C	NB	3	660	23759
D	EBLT	3	365	31926

LEGEND		
EXIST.	PROP.	
[Symbol]	[Symbol]	CONTROLLER
[Symbol]	[Symbol]	HANDHOLE
[Symbol]	[Symbol]	HEAVY HANDHOLE
[Symbol]	[Symbol]	SIGNAL POST
[Symbol]	[Symbol]	SIGNAL HEAD
[Symbol]	[Symbol]	SIGNAL HEAD W/ BACKPLATE
[Symbol]	[Symbol]	PEDESTRIAN SIGNAL HEAD
[Symbol]	[Symbol]	PEDESTRIAN PUSHBUTTON DETECTOR
[Symbol]	[Symbol]	WOOD POLE
[Symbol]	[Symbol]	GALV. STEEL CONDUIT
[Symbol]	[Symbol]	JUNCTION BOX
[Symbol]	[Symbol]	DETECTOR LOOP
[Symbol]	[Symbol]	MICROWAVE DETECTOR
[Symbol]	[Symbol]	CABLE NUMBER

FOR INFORMATION ONLY