

Note:  
See Sheet 8 of 17 for Sections C-C and D-D.  
See Sheet 9 of 17 for SM Railing and connections.

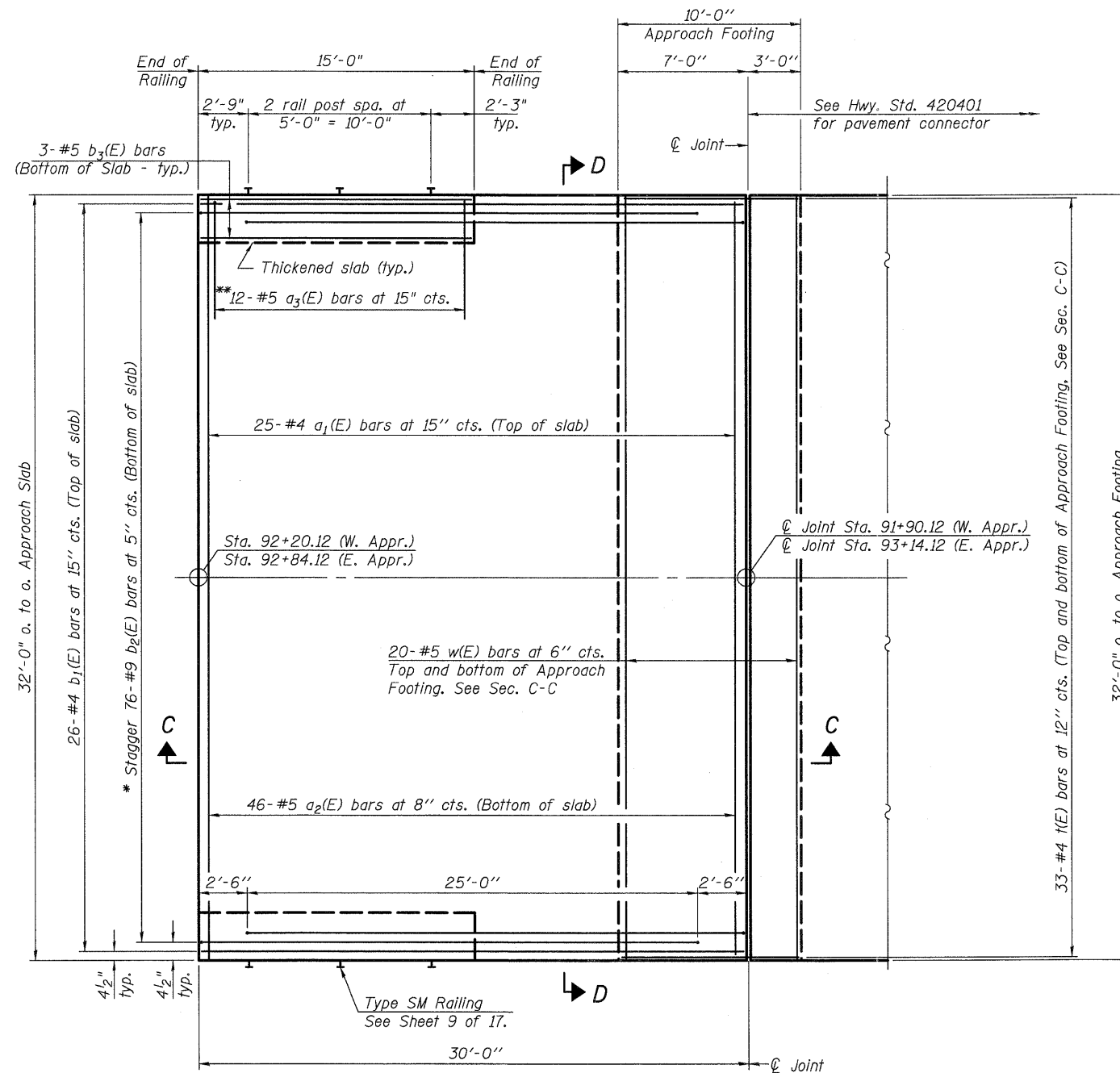

**PLAN**

\*Tilt #9 b<sub>2</sub>(E) bars as required to maintain clearance.  
\*\*Space between a<sub>1</sub>(E) bars.

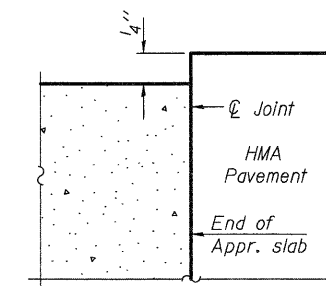

**FLEXIBLE PAVEMENT**

**DETAIL E**

(Sheet 1 of 2)

FILE NAME = P:\DBBEL WEST Projects\2009\UG-0073\Hopsa\PHI\Structural\Drawings\Bridges\Approach Slab\Drawings\01.dgn



USER NAME = nporris	DESIGNED - DLS	REVISED -
PLOT SCALE =	CHECKED - AEU	REVISED -
PLOT DATE = 12/16/2011	DRAWN - DLS	REVISED -
	CHECKED - AEU	REVISED -

**STATE OF ILLINOIS  
DEPARTMENT OF TRANSPORTATION**

**BRIDGE APPROACH SLAB DETAILS  
STRUCTURE NO. 045-3180**

T.R. RTE.	SECTION	COUNTY	TOTAL SHEETS	SHEET NO.
2442	04-08107-00-BR	KANE	80	41
FED. ROAD DIST. NO.			ILLINOIS FED. AID PROJECT	
			CONTRACT NO. 63644	

SHEET NO. 7 OF 17 SHEETS