

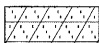

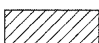

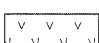

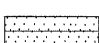

LEGEND

-  SEEDING CL 2A AND EROSION CONTROL BLANKET
-  SEEDING CL 4 AND EROSION CONTROL BLANKET
-  SEEDING CL 1A AND EROSION CONTROL BLANKET
-  SEEDING CL 4B AND EROSION CONTROL BLANKET
-  SEEDING CL 5B AND EROSION CONTROL BLANKET
-  SEEDING CL 4A AND HD EROSION CONTROL BLANKET

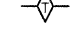
-  PERIMETER EROSION BARRIER (TEMPORARY)
-  TEMPORARY PIPE AND INLET PROTECTION
-  TEMPORARY TREE PROTECTION
-  TEMPORARY DITCH CHECK
-  TURBIDITY BARRIER (TEMPORARY)

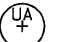
-  TREE, CELTIS OCCIDENTALIS (COMMON HACKBERRY), 3" CALIPER, BALLED AND BURLAPPED
 -  TREE, ULMUS AMERICANA (AMERICAN ELM), 2" CALIPER, BALLED AND BURLAPPED
 -  TREE, CERCIS CANADENSIS (EASTERN REDBUD), 7" HEIGHT, CLUMP FORM, BALLED AND BURLAPPED
- TREES SHALL BE LAID OUT IN THE FIELD AND THE LOCATION FIELD ADJUSTED AS NECESSARY TO AVOID CONFLICTS WITH UTILITIES. THE LOCATION SHALL BE APPROVED BY THE RESIDENT ENGINEER PRIOR TO INSTALLATION.

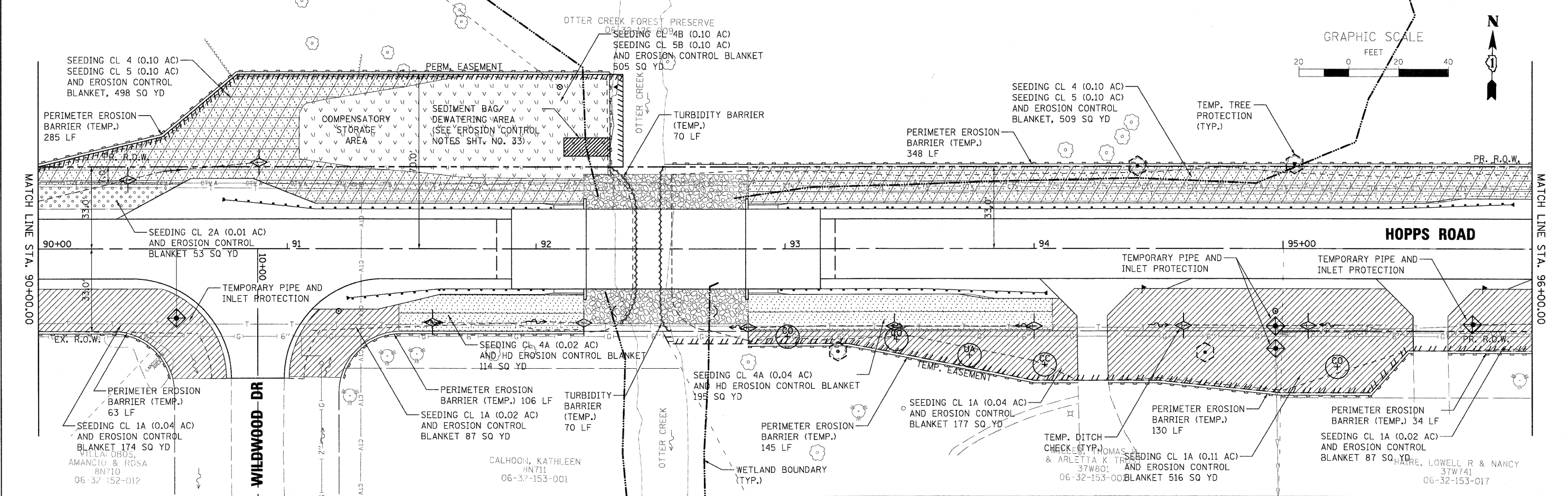
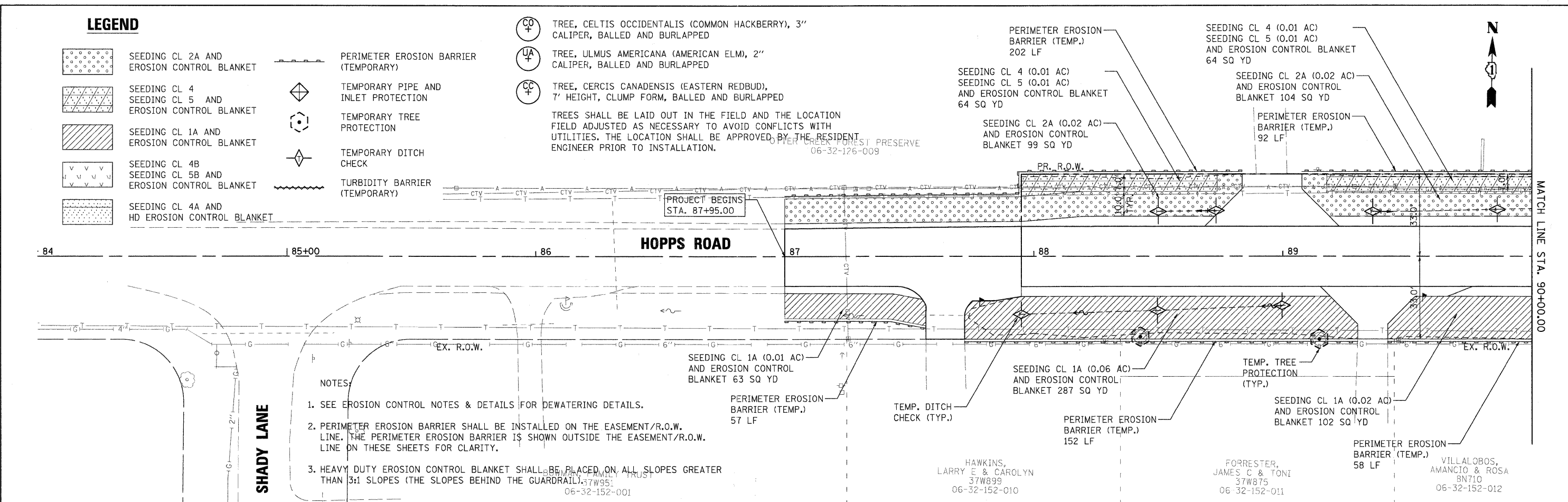

FILE NAME = P:\CIBEL\WEST - Projects\22089\06-2013\Hopps\Plan\Drawn\Sheet\EROS-1.dgn

WILLS BURKE KELSEY ASSOCIATES LTD.
116 West Main Street, Suite 201
St. Charles, Illinois 60174

USER NAME = nparis	DESIGNED - KMA	REVISED -
PLOT SCALE = AS SHOWN	DRAWN - NDP	REVISED -
PLOT DATE = 12/16/2011	CHECKED - RPD	REVISED -
	DATE - 12/19/11	REVISED -

**STATE OF ILLINOIS
DEPARTMENT OF TRANSPORTATION**

**EROSION CONTROL
& RESTORATION PLAN**

SCALE: AS SHOWN SHEET NO. 31 OF 80 SHEETS STA. TO STA.

T.R. RTE.	SECTION	COUNTY	TOTAL SHEETS	SHEET NO.
2442	04-08107-00-BR	KANE	80	31
CONTRACT NO. 63644				
FED. ROAD DIST. NO. ILLINOIS FED. AID PROJECT				