

GENERAL NOTES:

1. THE CONTRACTOR SHALL CONSTRUCT AND MAINTAIN AGGREGATE SURFACE COURSE FOR TEMPORARY ACCESS TO PRIVATE ENTRANCES AND FIELD ENTRANCES. THE TEMPORARY CLOSURE OF DRIVEWAYS WILL BE LIMITED TO THE DURATION OF THE CONSTRUCTION DIRECTLY IN FRONT OF THE DRIVEWAYS. IN ALL CASES, THE ENTRANCES SHALL BE OPEN AT THE END OF THE WORK DAY. THE CONTRACTOR SHALL COORDINATE CLOSURES WITH THE RESIDENT ENGINEER AND PROPERTY OWNER A MINIMUM OF FORTY EIGHT (48) HOURS IN ADVANCE OF THE CLOSURE.

TEMPORARY DETOUR DURATION

THE CONTRACT DOCUMENTS WILL ALLOW THE ROADWAY CLOSURE AND TEMPORARY DETOUR DETAILED ON THIS SHEET TO REMAIN IN PLACE UNTIL AUGUST 24, 2012. THE CONTRACTOR WILL BE EXPECTED TO COMPLETE ALL THE PROPOSED WORK RELATED TO THE CONSTRUCTION OF THE PROPOSED BRIDGE AND ROADWAY DURING THIS CLOSURE. THE ROADWAY MUST HAVE THE HMA SURFACE COURSE PLACED AND THE GUARDRAIL INSTALLED BEFORE THE ROADWAY IS OPENED TO TRAFFIC. IF THE SURFACE COURSE AND GUARD RAIL ARE NOT COMPLETE IN THE ALLOWED TIME, ADDITIONAL TRAFFIC CONTROL DEVICES REQUIRED FOR THE COMPLETION OF REMAINING CONSTRUCTION OPERATIONS WILL BE AT THE CONTRACTOR COSTS.

CHANGEABLE MESSAGE SIGN

THE CONTRACTOR SHALL PLACE ELECTRONIC CHANGEABLE MESSAGE SIGNS ON THE EAST AND WEST SIDE OF THE BRIDGE TO WARN THE PUBLIC OF THE PENDING CLOSURE. THE MESSAGE BOARDS WILL NEED TO BE PLACED AND SET OUT FOR SEVEN (7) DAYS IN ADVANCE OF THE ANTICIPATED FIRST DAY OF CONSTRUCTION. THE SIGNS SHALL REMAIN IN PLACE FOR THE SPECIFIED CONTRACT TIME. THE CONTRACTOR WILL COORDINATE WITH THE RESIDENT ENGINEER ON THE EXACT PLACEMENT OF THE MESSAGE BOARDS AND THE MESSAGE THAT IS TO BE DISPLAYED. THE MESSAGE MAY PERIODICALLY BE CHANGED BY THE TOWNSHIP. THERE WILL BE NO ADDITIONAL COMPENSATION FOR CHANGING OF THE MESSAGE(S). THE MESSAGE BOARDS WILL BE PAID FOR AS CHANGEABLE MESSAGE SIGN, PER CALENDAR MONTH FOR EACH MESSAGE SIGN UTILIZED.

TEMPORARY INFORMATION SIGN

THE CONTRACTOR SHALL ERECT ON THE EAST AND WEST SIDE OF THE BRIDGE TO INFORM THE PUBLIC OF THE CONSTRUCTION DURATION. THE CONTRACTOR WILL COORDINATE WITH THE RESIDENT ENGINEER ON THE EXACT PLACEMENT OF THE SIGN. THE SIGN SHALL BE IN PLACE FOR THE ENTIRE DURATION OF THE CONTRACT OR AS DIRECTED BY THE RESIDENT ENGINEER. THE TEMPORARY SIGN WILL BE AS DIMENSIONED ON STD. TC22 EXCEPT THE MESSAGE SHALL BE AS DETAILED ON THE DETOUR PLAN. THE SIGNING, WHICH INCLUDES POST AND MOUNTING, WILL BE PAID AS TEMPORARY INFORMATION SIGNING, PER EACH SIGN ERECTED.

CONTACTS

THE CONTRACTOR WILL BE REQUIRED TO COORDINATE ALL MAINTENANCE OF TRAFFIC OPERATIONS WITH ALL MUNICIPALITIES, TOWNSHIP, AND COUNTY ENTITIES WITHIN THE PROJECT LIMITS. THE FOLLOWING IS THE APPLICABLE LIST OF CONTACTS:

ELGIN TOWNSHIP HIGHWAY DEPARTMENT	RICHARD C. BURNIDGE	847-741-4637
CITY OF ELGIN	JOSEPH EVERS	847-931-5958
KANE COUNTY DIVISION OF TRANSPORTATION	DAVE BOESCH	630-845-7875
SOUTH ELGIN FIRE PROTECTION DISTRICT	JOE CLUCHEY	847-741-2141
KANE COUNTY SHERIFF	PATRICK PEREZ	630-232-6840
KANE COUNTY OFFICE OF EMERGENCY MANAGEMENT	DONALD BRYANT	630-232-5985

LIMITATIONS OF CONSTRUCTION

THE CONTRACTOR SHALL COORDINATE THE ITEMS OF WORK IN ORDER TO KEEP HAZARDS AND TRAFFIC INCONVENIENCES TO A MINIMUM, AS SPECIFIED BELOW:

1. DURING THE CONSTRUCTION WHEN THE ROADWAY IS NOT CLOSED, CONSTRUCTION OPERATIONS WILL BE CONDUCTED SO ONE LANE IN EACH DIRECTION ON HOPPS ROAD REMAINS OPEN.
2. THE CONTRACTOR SHALL PROVIDE, ERECT, AND MAINTAIN ALL THE NECESSARY SIGNS, BARRICADES, CONES, DRUMS, AND LIGHTS FOR THE WARNING AND PROTECTION OF TRAFFIC, AS REQUIRED BY SECTIONS 107 AND 701 THROUGH 703 OF THE STANDARD SPECIFICATIONS, AND AS MODIFIED.
3. THE CONTRACTOR SHALL FURNISH AND ERECT "ROAD CONSTRUCTION AHEAD" SIGNS (W20-1 (O)-48) AT BOTH ENDS OF THE PROJECT AND AT ALL SIDE ROADS WITHIN THE LIMITS OF THIS SECTION WHEN WORKING IN THE VICINITY OF THE SIDE ROAD INTERSECTION.

OFF-PEAK HOURS

FOR CONSTRUCTION OPERATION OUTSIDE THE DESIGNATED DETOUR PERIOD, THE "OFF-PEAK" HOURS ARE DEFINED AS THE DAYTIME HOURS FROM 9:00 A.M. TO 3:00 P.M. AND NIGHT TIME HOURS FROM 9:00 P.M. TO 6:00 A.M., MONDAY THROUGH FRIDAY.

KEEPING ROADS OPEN TO TRAFFIC

THE CONTRACTOR SHALL SCHEDULE HIS SEQUENCE OF OPERATIONS TO PERMIT THE CONSTRUCTION OF THIS SECTION WITH THE LEAST INCONVENIENCE TO THE TRAVELING PUBLIC. THE CONTRACTOR'S SCHEDULE SHALL REFLECT THE FOLLOWING REQUIREMENTS AND SEQUENCE OF CONSTRUCTION. THESE REQUIREMENTS FOLLOW THE SUGGESTED TRAFFIC CONTROL PLAN INCLUDED IN THE DRAWINGS.

1. HOPPS ROAD MAY BE COMPLETELY CLOSED TO TRAFFIC FOR THE DURATION SPECIFIED IN THE CONTRACT DOCUMENTS.
2. ACCESS TO FIELD AND PRIVATE ENTRANCES SHALL REMAIN OPEN AT ALL TIMES. ON PROPERTIES THAT HAVE MORE THAN ONE ACCESS, ONE ENTRANCE MAY BE TEMPORARILY CLOSED. HOWEVER, VEHICULAR ACCESS MUST REMAIN OPEN TO TRAFFIC FOR THE OPPOSITE ENTRANCE. WHEN IT IS NECESSARY TO CLOSE AN ENTRANCE, THE CONTRACTOR SHALL COORDINATE WITH THE RESIDENT ENGINEER AND THE PROPERTY OWNER FORTY-EIGHT (48) HOURS IN ADVANCE OF THE WORK. IN ALL CASES, THE ENTRANCE SHALL BE OPEN AT THE END OF THE WORKDAY.

TRAILER MOUNTED ARROW BOARD

UNLESS OTHERWISE REQUIRED BY A SPECIFIED TRAFFIC CONTROL STANDARD, THE USE OF A TRAILER MOUNTED ARROW BOARD(S) ARE NOT ANTICIPATED FOR THIS PROJECT.

SEQUENCE OF CONSTRUCTION

IN GENERAL, THE STAGING OF CONSTRUCTION FOR THIS SECTION SHALL BE AS FOLLOWS:

- MAJOR WORK ITEMS - STAGE 1 HOPPS ROAD
- COORDINATE UTILITY RELOCATES.
 - SET UP CHANGEABLE MESSAGE BOARD.
 - SET UP DETOUR AS DETAILED IN THE PLANS.
 - SET UP TEMPORARY EROSION CONTROL MEASURES.
 - REMOVE EXISTING VEGETATION, PAVEMENTS, AND BRIDGE STRUCTURE (SEE REMOVAL PLANS SHEETS).
 - CONSTRUCT THE PROPOSED BRIDGE, UNDERGRADE, AGGREGATE BASE COURSES, PAVEMENTS (TO SURFACE), STORM SEWERS, GUARD RAILS AND UNDERDRAINS.
 - CONSTRUCT GUARDRAILS AND SIGNAGE.

MAJOR WORK ITEMS - STAGE 2 - RESTORATION

THESE ITEMS MAY TAKE PLACE AFTER THE ROADWAY IS OPEN TO TRAFFIC.

- PLACE PERMANENT RESTORATION.
- PLACE PERMANENT PAVEMENT MARKINGS.
- FINALIZE PUNCH LIST AND SITE CLEANUP.

LEGEND	
	TEMPORARY INFORMATION SIGN
	CHANGEABLE MESSAGE SIGN
	DETOUR ROUTE
	TYPE III BARRICADE WITH TYPE A FLASHER
	TYPE A FLASHER
	DETOUR SIGN ASSEMBLY WITH STREET NAME AND DIRECTION PLATES (NUMBER DENOTES TYPE)
	W20 SERIES SIGN (NUMBER DENOTES TYPE)
	OTHER SIGN (NUMBER DENOTES TYPE)

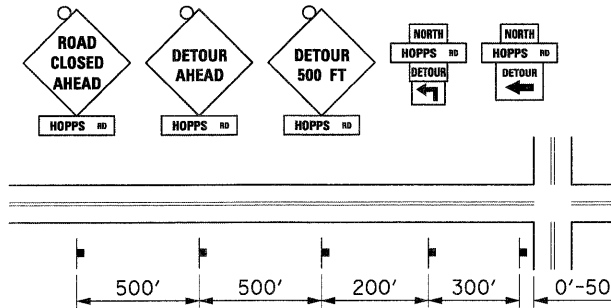

TYPICAL INDIVIDUAL SIGN SPACING

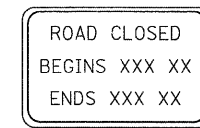

TEXT FOR TEMPORARY INFORMATION SIGN

SEE STD. TC 22 FOR SIGN DIMENSIONS AND DETAILS

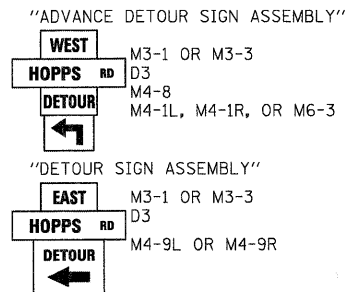

TYPICAL DETOUR SIGN ASSEMBLIES

FILE NAME = P:\CIBEL\WEST Projects\2009\05-2073 HoppsRd\11\02\Sign\Site\N01_Detour-1.dgn

WILLS BURKE KELSEY ASSOCIATES LTD. 118 West Main Street, Suite 201 St. Charles, Illinois 60174	USER NAME = nparis	DESIGNED - KMA	REVISED -	STATE OF ILLINOIS DEPARTMENT OF TRANSPORTATION	MAINTENANCE OF TRAFFIC DETOUR PLAN			T.R. RTE.	SECTION	COUNTY	TOTAL SHEETS	SHEET NO.		
	PLOT SCALE = AS SHOWN	DRAWN - NDP	REVISED -		SCALE: AS SHOWN	SHEET NO. 17	OF 80 SHEETS	STA.	TO STA.	2442	04-08107-00-BR	KANE	80	17
	PLOT DATE = 12/16/2011	CHECKED - RPD	REVISED -								CONTRACT NO.63644			
	DATE - 12/19/11	REVISED -							ILLINOIS FED. AID PROJECT					