

|                     |                |                  |              |           |
|---------------------|----------------|------------------|--------------|-----------|
| F.A.P. RTE.         | SECTION        | COUNTY           | TOTAL SHEETS | SHEET NO. |
| 856                 | 01-00170-26-TL | WILL             | 171          | 87        |
| STA. 84+00          |                | TO STA. 112+00   |              |           |
| FED. ROAD DIST. NO. | ILLINOIS       | FED. AID PROJECT |              |           |
| CONTRACT NO: 63570  |                |                  |              |           |

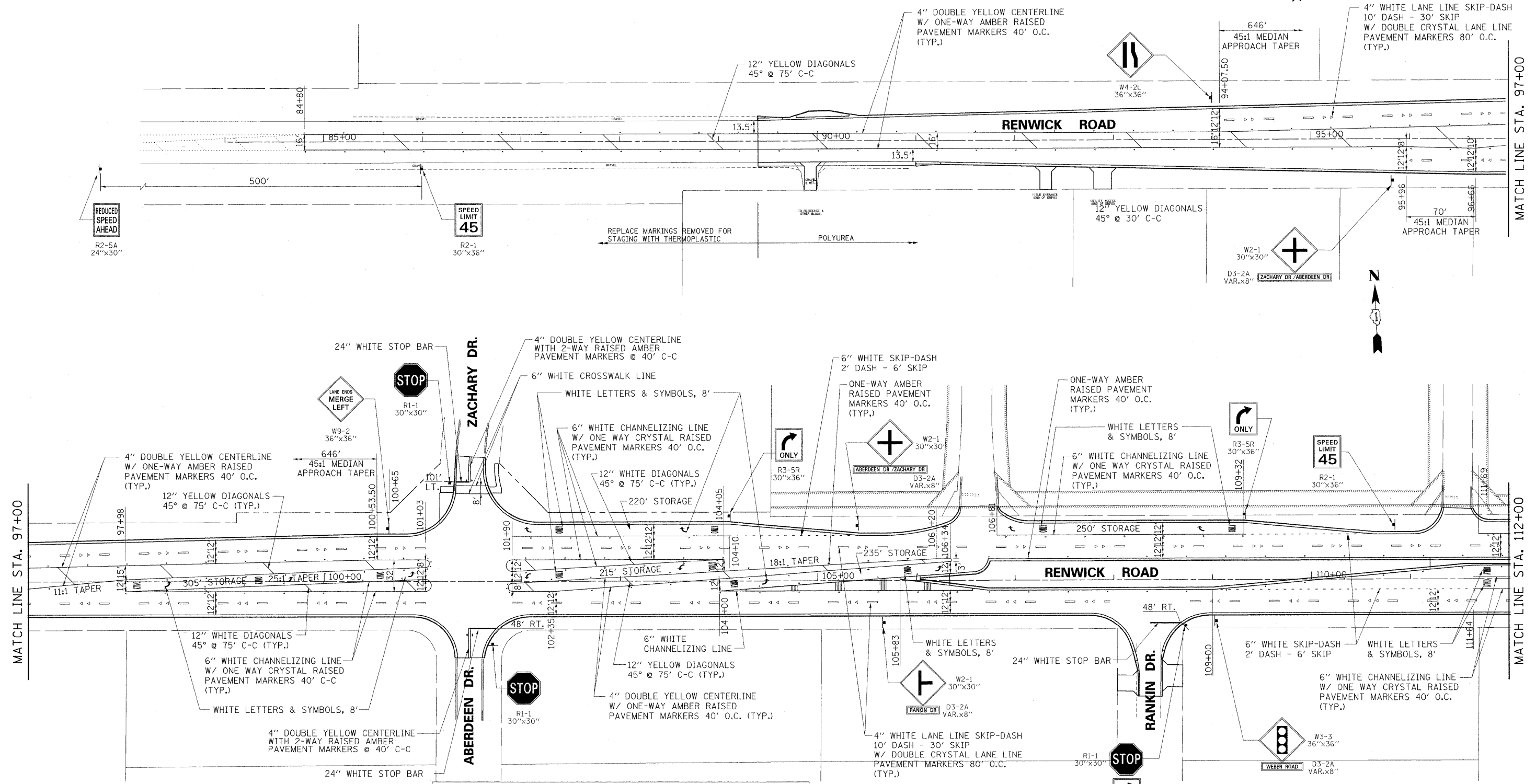

**NOTES:**

ALL PAVEMENT MARKINGS ON PCC ARE POLYUREA TYPE I.

ALL PAVEMENT MARKINGS ON HOT MIX ASPHALT ARE THERMOPLASTIC.

REFER TO DISTRICT STANDARD TC-11 AND IDOT STANDARD 781001 FOR RAISED REFLECTIVE PAVEMENT MARKER DETAILS.

RAISED REFLECTIVE PAVEMENT MARKERS ADJACENT TO WHITE SKIP DASH AND CENTERLINES SHALL BE OFFSET 4 INCHES TOWARD TRAFFIC.

SIGN LOCATIONS AND ORIENTATIONS WILL BE DETERMINED BY THE ENGINEER.

REFER TO DISTRICT STANDARD TC-13 FOR PAVEMENT MARKING DETAILS.

- LEGEND**
- ◀ ONE WAY CRYSTAL RAISED PAVEMENT MARKER
  - ONE WAY AMBER RAISED PAVEMENT MARKER
  - TWO WAY AMBER RAISED PAVEMENT MARKER
  - ◀ PROPOSED SIGN
  - ◀ PROPOSED TRAFFIC SIGNAL MAST ARM
  - ◀ PROPOSED TRAFFIC SIGNAL POLE

| REVISIONS |      |
|-----------|------|
| NAME      | DATE |
|           |      |
|           |      |
|           |      |
|           |      |
|           |      |
|           |      |
|           |      |
|           |      |
|           |      |
|           |      |

ILLINOIS DEPARTMENT OF TRANSPORTATION

**RENWICK ROAD**  
**PAVEMENT MARKING & SIGNING PLAN**  
**STA. 84+00 TO STA. 112+00**

SCALE: 1" = 50'  
 DATE: APRIL, 2011  
 DRAWN BY: CJO  
 CHECKED BY: MFB

8/22/2011 P:\79766\cadd\dr\wtngs\087pavmark.dgn