

**LEGEND**

- 1 PAVEMENT MARKING - LINE 4" WHITE SOLID LINE
- 2 PAVEMENT MARKING - LINE 4" YELLOW DOUBLE CENTER LINE @ 11" C-C
- 3 PAVEMENT MARKING - LINE 6" WHITE
- 4 PAVEMENT MARKING - LINE 12" YELLOW @ 45 DEGREE
- 5 PAVEMENT MARKING - LINE 12" WHITE @ 45 DEGREE
- 6 PAVEMENT MARKING - LINE 24" WHITE
- 7 PAVEMENT MARKING - LETTERS & SYMBOLS
- 8 AMBER BARRIER MARKERS, TYPE B @ 40' C-C

THERMOPLASTIC PAVEMENT MARKINGS WILL BE USED FROM STA. 24+40 TO STA. 30+42 AND FROM STA. 33+46 TO STA. 38+91. (HOT-MIX ASPHALT PAVEMENT). POLYUREA PAVEMENT MARKINGS WILL BE USED FROM STA. 30+42 TO STA. 33+46 (CONCRETE PAVEMENT).

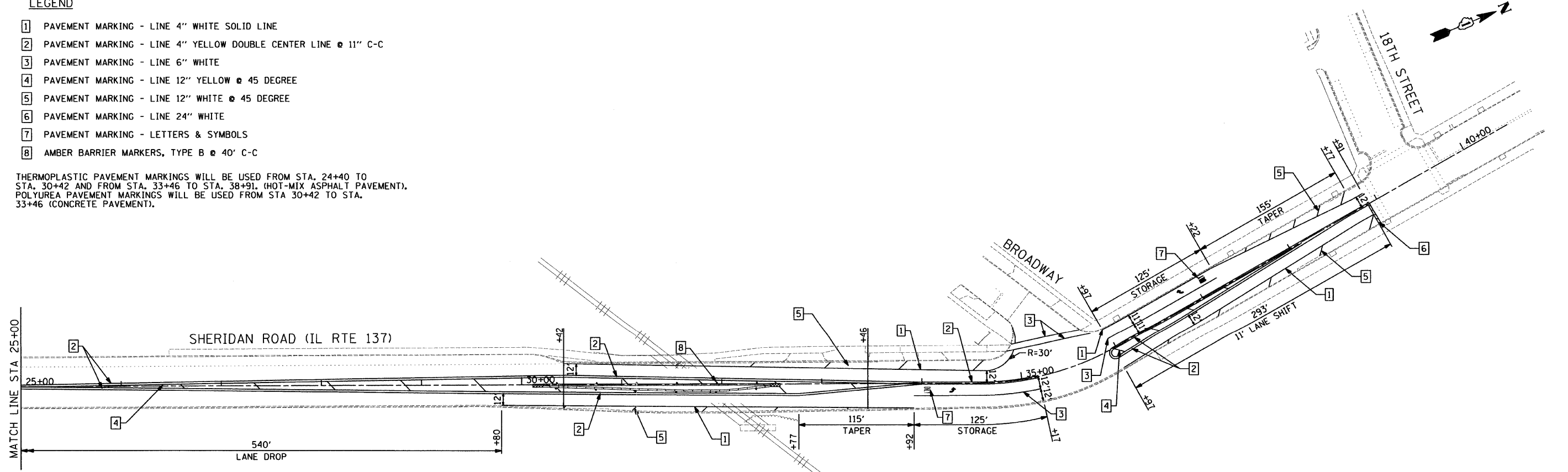

|                        |                             |                |           |   |   |                         |                 |                    |             |                 |             |
|------------------------|-----------------------------|----------------|-----------|---|---|-------------------------|-----------------|--------------------|-------------|-----------------|-------------|
| FILE NAME =<br>#FILE#  | USER NAME = .USER.          | DESIGNED - SRC | REVISED - | <b>STATE OF ILLINOIS<br/>DEPARTMENT OF TRANSPORTATION</b> | <b>IL 137 - 18th STREET TO MARTIN LUTHER KING DRIVE<br/>PAVEMENT MARKING PLAN</b> |                         | F.A.P. RTE. 352 | SECTION 2011-023-1 | COUNTY LAKE | TOTAL SHEETS 15 | SHEET NO. 8 |
|                        | PLOT SCALE = 50,0000' / IN. | CHECKED - RS   | REVISED - |   | SCALE: 50   | SHEET NO. 1 OF 1 SHEETS | STA. TO STA.    | CONTRACT NO. 60P23 |             |                 |             |
| PLOT DATE = 12/13/2011 | DATE = 12-12-2011           | REVISED -      | REVISED - |   | ILLINOIS FED. AID PROJECT   |                         |                 |                    |             |                 |             |
|                        |                             |                |           |   |   |                         |                 |                    |             |                 |             |