

EXISTING CONDITIONS

FOR A DETAIL DESCRIPTION
SEE CONCRETE BARRIER DETAIL SHEET 10

PROP. CURVE CIA
 PI STA. = 35+31.75
 $\Delta = 29^\circ 34' 06''$ (LT)
 $D = 20^\circ 50' 05''$
 $R = 275.00'$
 $T = 72.58'$
 $L = 141.92'$
 $E = 9.42'$
 $\theta = \text{---}$
 $T.R. = \text{---}$
 $S.E. \text{ RUN} = \text{---}$
 $P.C. \text{ STA.} = 34+59.17$
 $P.T. \text{ STA.} = 36+01.09$

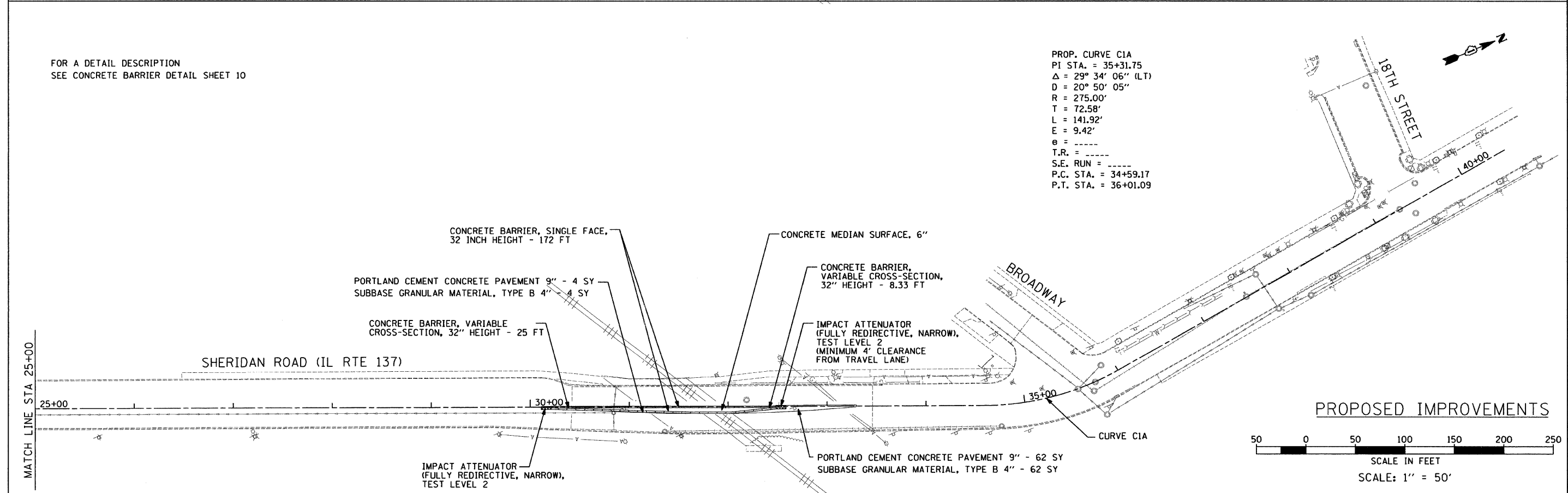

PROPOSED IMPROVEMENTS

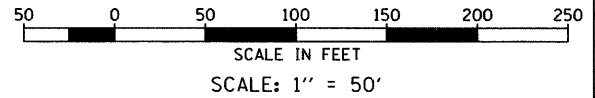

FILE NAME =	USER NAME = .USER.	DESIGNED - SRC	REVISED -	STATE OF ILLINOIS DEPARTMENT OF TRANSPORTATION	IL 137 - 18th STREET TO MARTIN LUTHER KING DRIVE EXISTING & PROPOSED CONDITIONS	F.A.P. RTE.	SECTION	COUNTY	TOTAL SHEETS	SHEET NO.	
#FILEL*	PLOT SCALE = 50.0000' / IN.	DRAWN - SRC	REVISED -			352	2011-023-I	LAKE	15	7	
	PLOT DATE = 12/12/2011	CHECKED - RS	REVISED -			CONTRACT NO. 60P23					
		DATE - 12-12-2011	REVISED -			ILLINOIS FED. AID PROJECT					
					SCALE: 50	SHEET NO. 1 OF 1 SHEETS		STA.	TO STA.		