

STATE OF ILLINOIS
DEPARTMENT OF TRANSPORTATION

Sheet No. 1
Description: Gen. Plan, Gen. Notes & Total Bill of Mat'l

SHEET 1
OF 1

F.A.I. RTE.	SECTION	COUNTY	TOTAL SHEETS	SHEET NO.
270	60-6HB-1	MADISON	156	94
FED. ROAD DIST. NO.	ILLINOIS	FED. AID PROJECT	CONTRACT NO. 76857	

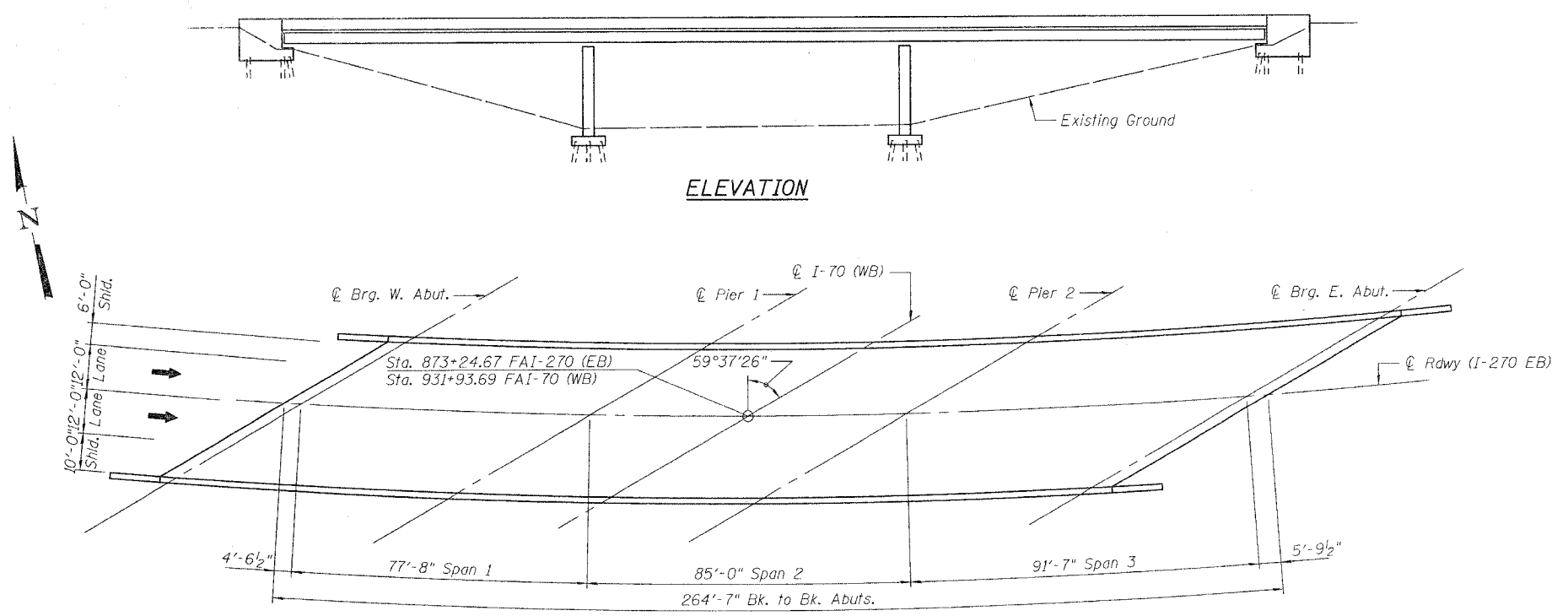

ELEVATION

PLAN

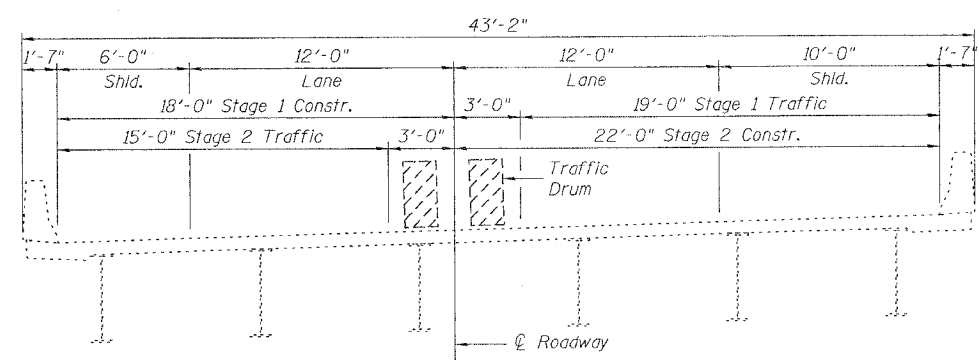

CROSS SECTION
(Looking East)

GENERAL NOTES

A Concrete Sealer shall be applied to the surfaces of the deck and parapets, including wings. (See Special Provisions for BRIDGE DECK CONCRETE SEALER.)

TOTAL BILL OF MATERIAL

ITEM	UNIT	SUPER	SUB	TOTAL
Concrete Sealer	Sq Ft	12735	--	12735

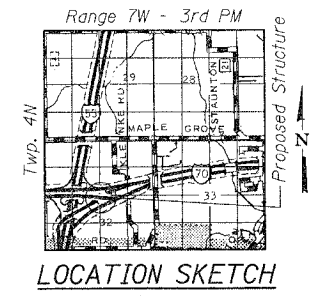

LOCATION SKETCH

GENERAL PLAN
INTERSTATE 270 (EB) OVER
INTERSTATE 70 (WB)
FAI ROUTE 270 SECTION 60-6HB-1
MADISON COUNTY
STATION 873+24.67
STRUCTURE NO. 060-0059

<p>Johnson, Depp & Quisenberry CONSULTING ENGINEERS Springfield, Illinois</p>	
DESIGNED: CDB	DRAWN: SJS
CHECKED: DCD	CHECKED: CDB/DCD

Signed: *David Depp*
 Date: *12-1-2006*
 Lic. Expires: 11-30-2008

DATE: 1/30/2006 - 10:29:00 USER: DCD FILE: J:\JDD\NICH2_IL-DBW#5_I-70 Bridge_Repairs\4-SN060-0059_I-270eb\06plan.dgn