

F.A.I. RTE.	SECTION	COUNTY	TOTAL SHEETS	SHEET NO.
70	60-(10,11)RS	MADISON	156	34
STA. _____		TO STA. _____		
FED. ROAD DIST. NO. _____		ILLINOIS FED. AID PROJECT		

EXIST. CURVE RAMPG4-2
 PI STA. = 19+91.10
 $\Delta = 59^\circ 14' 31''$ (RT)
 $D = 4^\circ 09' 07''$
 $R = 1,380.00'$
 $T = 784.62'$
 $L = 1,426.87'$
 $E = 207.46'$
 $E = \text{-----}$
 $T.R. = \text{-----}$
 $S.E. RUN = \text{-----}$
 $P.C. STA. = 12+06.48$
 $P.T. STA. = 26+33.35$

RAISED REFLECTIVE PAVEMENT MARKER
 ONE-WAY AMBER MARKER @ 40' CENTERS

THERMOPLASTIC PAVEMENT MARKING
 4" WHITE EDGE LINE

EXIST. CURVE RAMPG4-1
 PI STA. = 9+53.70
 $\Delta = 44^\circ 19' 58''$ (RT)
 $D = 8^\circ 18' 13''$
 $R = 690.00'$
 $T = 281.11'$
 $L = 533.89'$
 $E = 55.07'$
 $E = \text{-----}$
 $T.R. = \text{-----}$
 $S.E. RUN = \text{-----}$
 $P.C. STA. = 6+72.59$
 $P.T. STA. = 12+06.48$

THERMOPLASTIC PAVEMENT MARKING
 4" YELLOW EDGE LINE

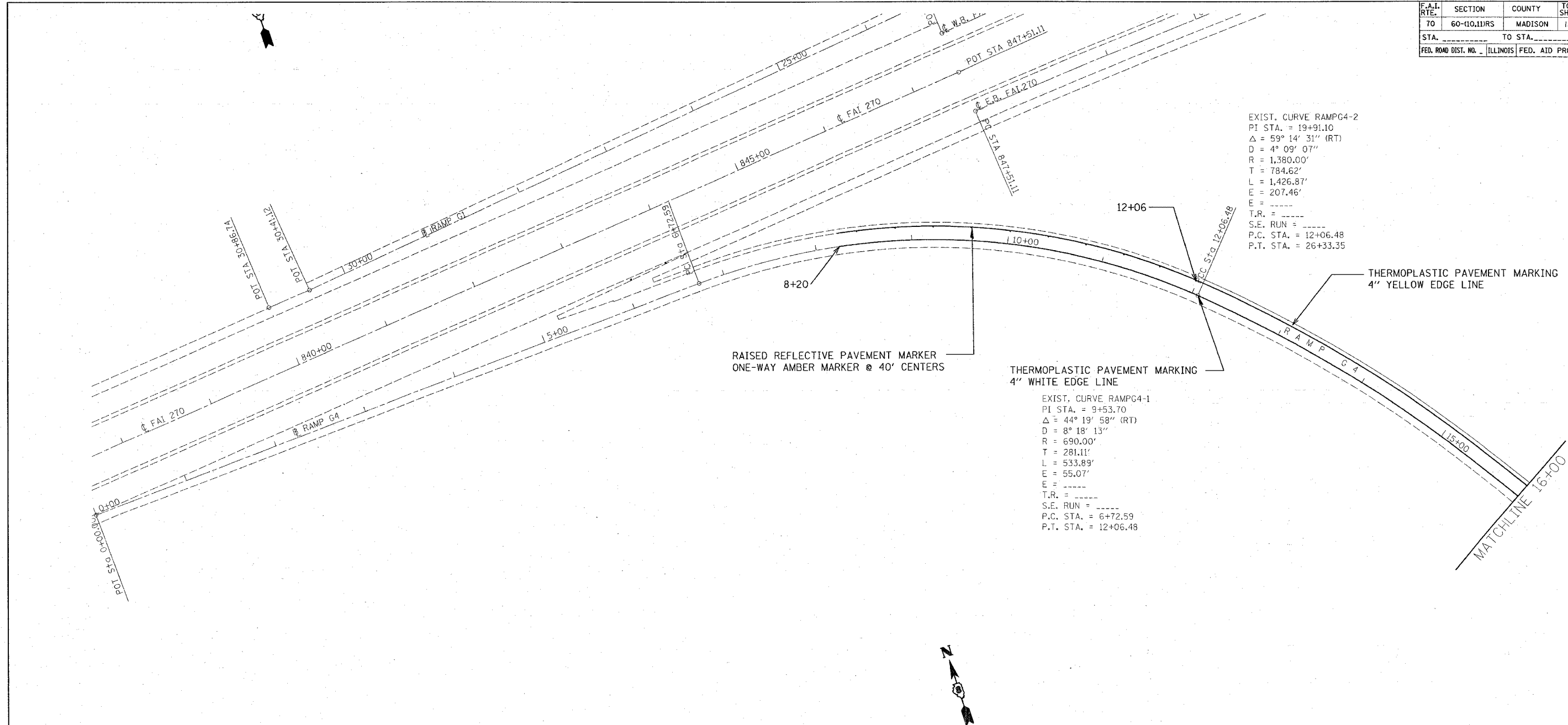

PLOT DATE = *DATE*
 FILE NAME = *FILE*
 PLOT SCALE = *SCALE*
 REFERENCE = *REF*

REVISIONS	
NAME	DATE

ILLINOIS DEPARTMENT OF TRANSPORTATION
PAVEMENT MARKING
RAMP G4
 FAI 70
 SECTION 60-(10,11)RS
 MADISON COUNTY

SCALE: VERT. _____
 DATE: _____ HORIZ. _____

DRAWN BY _____
 CHECKED BY _____