

F.A.I. RTE.	SECTION	COUNTY	TOTAL SHEETS	SHEET NO.
70	60-(10,11)RS	MADISON	156	118
STA.		TO STA.		
FED. ROAD DIST. NO.		ILLINOIS FED. AID PROJECT		

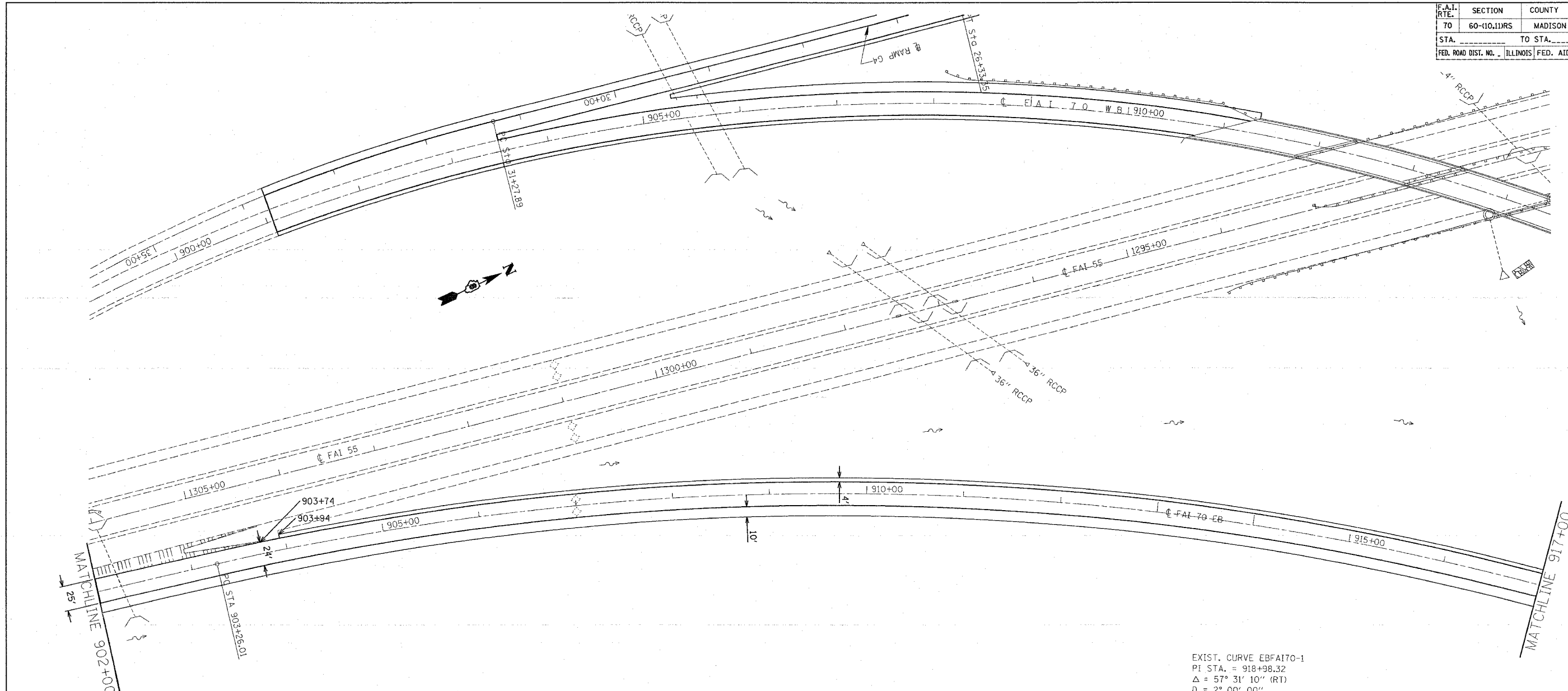

EXIST. CURVE EBFAI70-1
 PI STA. = 918+98.32
 $\Delta = 57^\circ 31' 10''$ (RT)
 $D = 2^\circ 00' 00''$
 $R = 2,864.79'$
 $T = 1,572.31'$
 $L = 2,875.97'$
 $E = 403.11'$
 $E = \text{---}$
 $T.R. = \text{---}$
 $S.E. \text{ RUN} = \text{---}$
 $P.C. \text{ STA.} = 903+26.01$
 $P.T. \text{ STA.} = 932+01.98$

PLOT DATE = #DATE#
 FILE NAME = #FILE#
 PLOT SCALE = #SCALE#
 REFERENCE = #REF#

REVISIONS	
NAME	DATE

ILLINOIS DEPARTMENT OF TRANSPORTATION
PLAN VIEW
EASTBOUND 70
 FAI 70
 SECTION 60-(10,11)RS
 MADISON COUNTY

SCALE: VERT. _____
 HORIZ. _____
 DATE _____

DRAWN BY _____
 CHECKED BY _____