

STATE OF ILLINOIS
DEPARTMENT OF TRANSPORTATION

PLANS FOR PROPOSED
HIGHWAY BRIDGE PROGRAM

TOWNSHIP ROUTE 44 (TWENTE CROSSING ROAD)
SECTION 11-01164-00-BR
PROJECT NO. BROS-0003(126)
JOB NO. C-99-544-11
TRIBUTARY TO CIRCLE DITCH

ALEXANDER COUNTY

ROUTE	SECTION	COUNTY	TOTAL SHEETS	SHEET NO.
TR 44	11-01164-00-BR	ALEXANDER	12	1
PROJECT NO. BROS-0003(126)			CONTRACT NO. 99461	

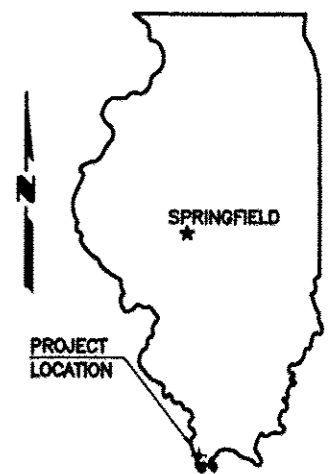

SUMMARY OF QUANTITIES

CODE NO.	PAY ITEM	UNIT	TOTAL
* X2501000	SEEDING, CLASS 2 (SPEL)	ACRE	0.2
20200100	EARTH EXCAVATION	CU YD	45
* 20300100	CHANNEL EXCAVATION	CU YD	117
* 28100807	STONE DUMPED RIPRAP, CLASS A4	TON	210
* 40200800	AGGREGATE SURFACE COURSE, TYPE B	TON	139
* 50100100	REMOVAL OF EXISTING STRUCTURES	EACH	1
50200100	STRUCTURE EXCAVATION	CU YD	68
50300225	CONCRETE STRUCTURES	CU YD	16.8
50300280	CONCRETE ENCASEMENT	CU YD	2.1
50400405	PRECAST PRESTRESSED CONCRETE DECK BEAMS (21" DEPTH)	SQ FT	1,224
50800105	REINFORCEMENT BARS	POUND	2,254
Δ 50900205	STEEL RAILING, TYPE S1	FOOT	104
51200957	FURNISHING METAL SHELL PILES 12" X 0.250"	FOOT	455
51202305	DRIVING PILES	FOOT	455
51203200	TEST PILE METAL SHELLS	EACH	1
51500100	NAME PLATES	EACH	1
67100100	MOBILIZATION	L SUM	1
Δ 78201000	TERMINAL MARKER - DIRECT APPLIED	EACH	4

* SEE SPECIAL PROVISIONS Δ SPECIALTY ITEMS

INDEX OF SHEETS

1. COVER SHEET
 2. PLAN AND PROFILE
 3. GENERAL PLAN AND ELEVATION
 4. 21" X 36" PPC DECK BEAM
 5. 21" X 36" PPC DECK BEAM DETAILS
 6. 21" X 48" PPC DECK BEAM
 7. 21" X 48" PPC DECK BEAM DETAILS
 8. ABUTMENT
 9. STEEL RAILING, TYPE S1
 10. NAME PLATES
 11. PILING DETAILS
 12. CROSS SECTIONS
- STANDARDS 000001-06 STANDARD SYMBOLS, ABBREVIATIONS AND PATTERNS
- 280001-07 TEMPORARY EROSION CONTROL SYSTEMS
- 635006-03 REFLECTOR AND TERMINAL MARKER PLACEMENT
- 701901-02 TRAFFIC CONTROL DEVICES
- BLR 21-9 TYPICAL APPLICATION OF TRAFFIC CONTROL DEVICES

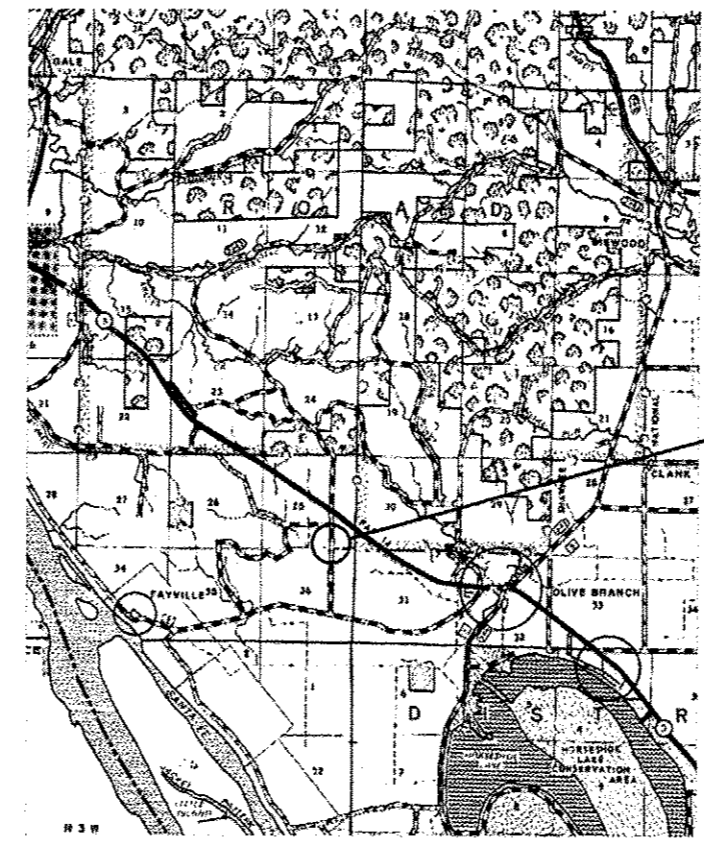

PROPOSED IMPROVEMENT

CLASSIFICATION : LOCAL ROAD (RURAL)
ADT : 325
DESIGN SPEED : 40 MPH

CONTRACT NO. 99461



12-5-12

Edward W. Miller

Edward W. Miller
PROFESSIONAL ENGINEER
#062-025277
EXPIRES NOV. 30, 2013

E. MILLER ENGINEERING, INC.
CONSULTING ENGINEERS
HARRISBURG, ILLINOIS

LOCATION MAP

SCALE: 1" = 2 MILES

NET LENGTH OF IMPROVEMENT = 280.00 FT. = 0.0530 MILES



ILLINOIS DEPARTMENT OF TRANSPORTATION	
Approved	12-6-12 <i>[Signature]</i> Alexander County Engineer
Passed	12-20-2012 <i>Deni W. Hill</i> District 9 Engineer of Local Roads and Streets
Releasing for Bid Based on Limited Review	12-20-2012 <i>Omer Osman</i> Deputy Director of Highways, Region 5 Engineer Illinois Department of Transportation