

REFERENCE POINT			NORTHING	EASTING
TYPE	STATION	LOCATION		
POT	137+00.00	FAP 685	3589969.95	4143805.02
POT	147+05.00	FAP 685	3590129.50	4144797.27
POT	156+93.03	FAP 685	3590286.36	4145772.78
POT	8+00.00	CHANNEL	3589928.49	4144764.00
POT	12+00.00	CHANNEL	3590326.39	4144804.88

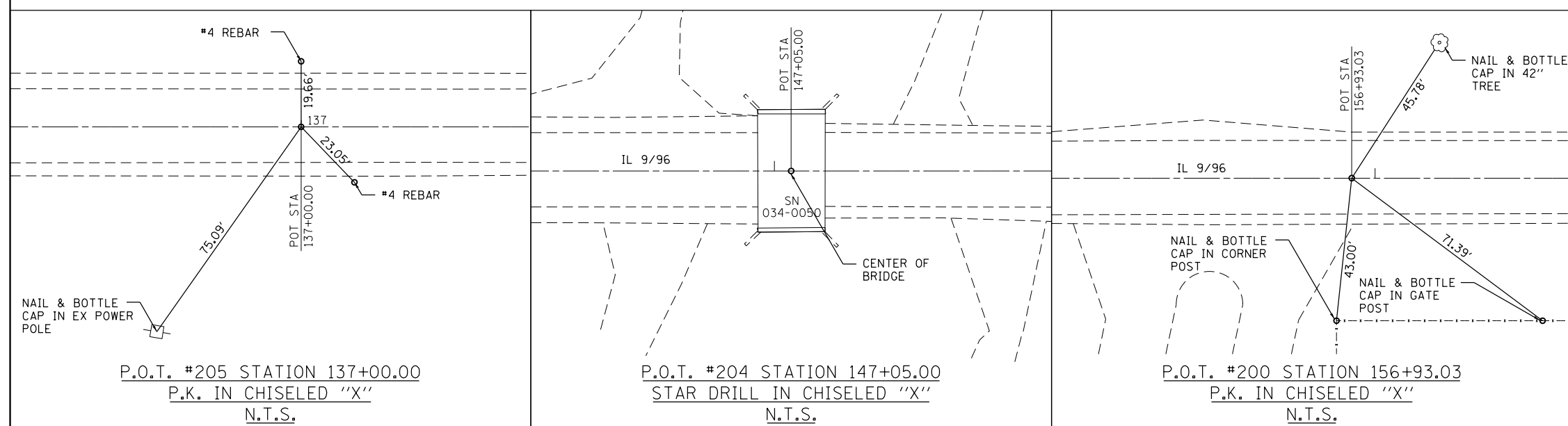

BENCHMARK TA-2
 SET 600 NAIL IN POWER POLE ON SOUTH SIDE OF IL 9/96 @ STATION 138+50.10, 35.60' RT. NAVD '88 ELEVATION = 535.35 FT.

BENCHMARK TA-2A
 FOUND CHISELED "□" ON SOUTHWEST WING WALL OF SN 034-0050 @ STATION 146+95.20, 18.60' RT. NAVD '88 = 540.86 FT.

BENCHMARK TA-3
 SET CHISELED "□" ON WEST END OF NORTH CONCRETE HEADWALL @ STATION 152+42.30, 17.60' RT. NAVD '88 = 540.97 FT.

FILE NAME = c:\pwwork\pwwork\sparks\sparks\14832\885\0672B62-sht-ATB.dgn
 MODEL = \$MODEL\$
 PLOT DRIVER = \$PLTDRVR\$



USER NAME = sparks	DESIGNED - MCV	REVISED -
FILE NAME = D672B62-sht-ATB.dgn	DRAWN - CMM	REVISED -
PLOT SCALE = 200.0000' / in.	CHECKED - MTM	REVISED -
PLOT DATE = Dec-18-2012 10:19:32AM	DATE - 12/12	REVISED -

**STATE OF ILLINOIS
 DEPARTMENT OF TRANSPORTATION**

ALIGNMENT, TIES & BENCHMARK DATA	
SCALE: 1"=100'	SHEET NO. 1 OF 1 SHEETS
STA. 137+00.00 TO STA. 156+93.03	

F.A.P. RTE.	SECTION	COUNTY	TOTAL SHEETS	SHEET NO.
685	113B-4	HANCOCK	57	14
CONTRACT NO. 72B62				
ILLINOIS FED. AID PROJECT				