

BM #63B - Spike & Cap on stump 10' Rt. Sta. 846+55 Elev. 279.6  
Existing Structure - None.

STATE OF ILLINOIS  
DEPARTMENT OF PUBLIC WORKS & BUILDINGS  
DIVISION OF HIGHWAYS

NO. SHEET	NO. SHEETS	COUNTY	PIECE NO.	SHEET NO.
26	1418	Iroquois	13	2
SHEET NO. 1 OF 8 SHEETS				

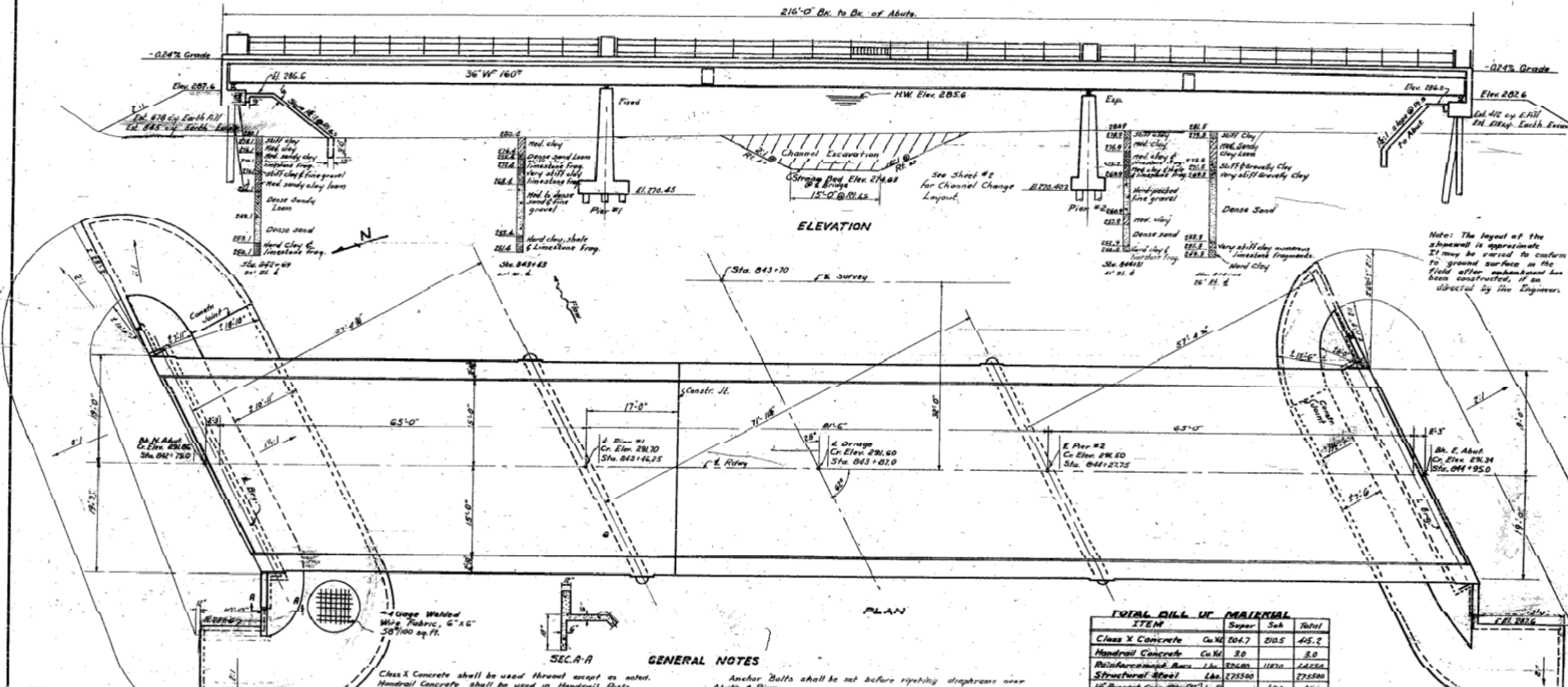

**STRESSES**  
 f<sub>c</sub> = 18,000 psi. (Struct.)  
 f<sub>c</sub> = 20,000 psi. (Pavt.)  
 f<sub>c</sub> = 1200 psi. (Super.)  
 f<sub>c</sub> = 800 psi. (Sub.)  
 n = 10  
 Loading H20-S16

**GENERAL NOTES**

Class X Concrete shall be used throughout except as noted.  
 Handrail Concrete shall be used in Handrail Posts.  
 All connections shall be riveted except as noted. Rivets shall be 8" holes 3/4" except as noted.  
 All holes for anchors shall be 1/2" larger than diameter of anchor.  
 1/2" x 1/2" in web and 3/4" in flange with all stringers assembled in shop in proper position with or without diaphragms in place. Leave assembled for shop inspection.  
 Inspection of Structural Steel and Metal Handrail by Illinois Division of Highways shall be made before painting.  
 Structural Steel and Metal Handrail shall receive one shop coat of red lead paint and two field coats of aluminum paint. All paint to be furnished and applied by the Contractor.  
 All rollers, rockers, bearing plates and anchor bolts shall be finished, painted & set in accordance with Art. 54.3(d) of the Std. Specs. and are included for payment as Structural Steel. Est. Wt. 10120 #  
 Drilling notes are shown only as a guide to bidders in estimating soil conditions which may be encountered in the work.  
 Concrete Floor Slab shall be poured in one continuous operation or in two continuous operations with one construction joint as shown. No additional construction joints will be allowed without the written permission of the Engineer.

Anchor Bolts shall be set before riving diaphragms over Abut. & Piers.  
 All welding shall comply with Art. 55.6 (3d) of Std. Specs.  
 The handrail shall be adjusted to true alignment after the floor slab and curbs have been poured.  
 When piers are in precast concrete two test piles shall be driven in permanent pile location as indicated by the Engineer before casting remainder of piers.  
 One Untreated Test Pile shall be driven as directed by the Engineer at a Pier in a permanent pile location before ordering remainder of piers.  
 The Contractor shall construct the embankment around the Abut. as shown and in accordance with Sec. 16 of Std. Specs.  
 The Contractor shall make the Channel Change as shown on the plans. Est. 5354 Cu. Yds. channel excavation to be placed in old channel.  
 Earth embankments at the abutments shall be backfilled with earth excavation obtained from roadway excavation immediately north of North Abut. of proposed bridge.

**TOTAL BILL UP MATERIAL**

ITEM	Super	Sub	Total
Class X Concrete Cu Yd	204.7	210.5	415.2
Handrail Concrete Cu Yd	3.0		3.0
Reinforcement Bars Lbs.	32600	11820	44420
Structural Steel Lbs.	275500		275500
16' Precast Conc. Pile (20') Lm. Ft.		420	420
16' Precast Conc. Test Pile Ea.	2	2	2
Name Plate Ea.	1	1	2
Earth Excavation Cu Yd		1360	1360
Metal Handrail Lm. Ft.	404		404
Untr. Test Piles (20') Lm. Ft.	1200		1200
Untr. Test Piles Ea.	1		1
Channel Excav. Cu Yd		5354	5354
Metal Shoes Ea.	61		61

**WATERWAY INFORMATION**  
 Drainage Area 60,000 Acres  
 Character Rolling  
 Opening Required (50 year flood) 1000 Sq. Ft.  
 Proposed Bridge Opening 1002 Sq. Ft.

STATION 843+70 (1)  
 SHEET 13 BY  
 STATE OF ILLINOIS  
 FA. RT. 26 SEC. 141-B  
 FA. PROJ. FI. 25 (11)  
 LOADING H20-S16

LET TALKING FOR NAME PLATE  
 See Std. 1082

PLAN AND ELEVATION  
 LANGAN CREEK BRIDGE  
 PROJ. FI. 25 (11)  
 FA. RT. 26 (S.B.) SEC. 141-B  
 IROQUOIS COUNTY  
 STA. 843+70 (1)

**FOR INFORMATION ONLY**



DESIGNED	REVISOR	REVISION
CHECKED	REVISOR	REVISION
DRAWN	REVISOR	REVISION
CHECKED	REVISOR	REVISION

STATE OF ILLINOIS  
DEPARTMENT OF TRANSPORTATION

EXISTING STRUCTURE PLANS  
STRUCTURE NO. 038-0215 (S.B.)

SHEET NO. 9 OF 19 SHEETS

F.A.I. RTE.	SECTION	COUNTY	TOTAL SHEETS	SHEET NO.
57	141 BR(SB) & 38-1 BR(NB)	IROQUOIS	138	85
CONTRACT NO. 66944				
ILLINOIS FED. AID PROJECT				

12/7/2012 4:52:45 AM 0380215\_66944\_001\_EX09.dgn