

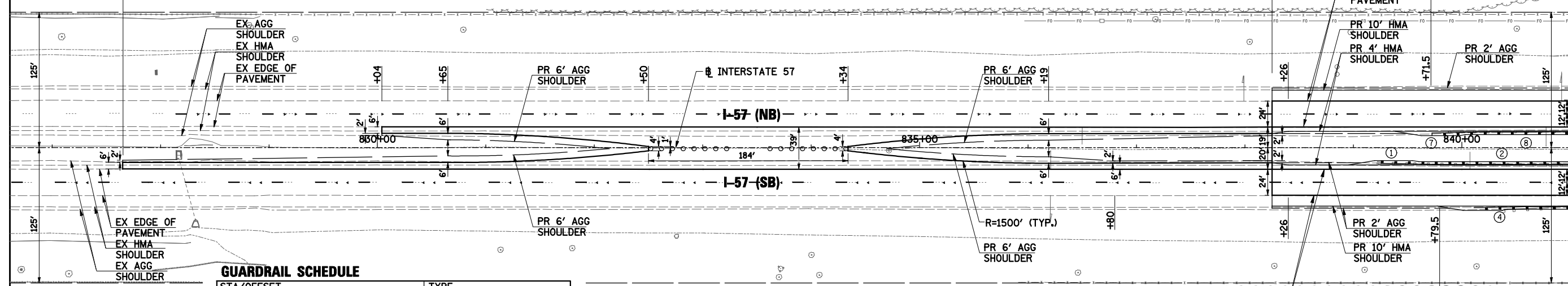

BEGIN IMPROVEMENTS
PCC PAVEMENT
STA. 827+65.00

BEGIN RESURFACING
END PCC PAVEMENT
STA. 838+25.00

END RESURFACING
BEGIN RECONSTRUCTION
PR EDGE OF PAVEMENT



GUARDRAIL SCHEDULE

STA/OFFSET	TYPE
1 839+25.6, 14.5'R - 839+75.6, 15.5'R	TR BAR TRM T1 SPL TAN
2 839+75.6, 15.5'R - 842+25.6, 15.5'R	SPBGR TY A 6FT POSTS
4 840+11.1, 55.5'R - 840+61.1, 54.5'R	TR BAR TRM T1 SPL TAN
7 839+72.5, 13.5'L - 840+22.5, 14.5'L	TR BAR TRM T1 SPL TAN
8 840+22.5, 14.5'L - 842+10.0, 14.5'L	SPBGR TY A 6FT POSTS

ROW LEGEND

--- EXISTING ROW LIMITS
- - - CONSTRUCTION LIMITS

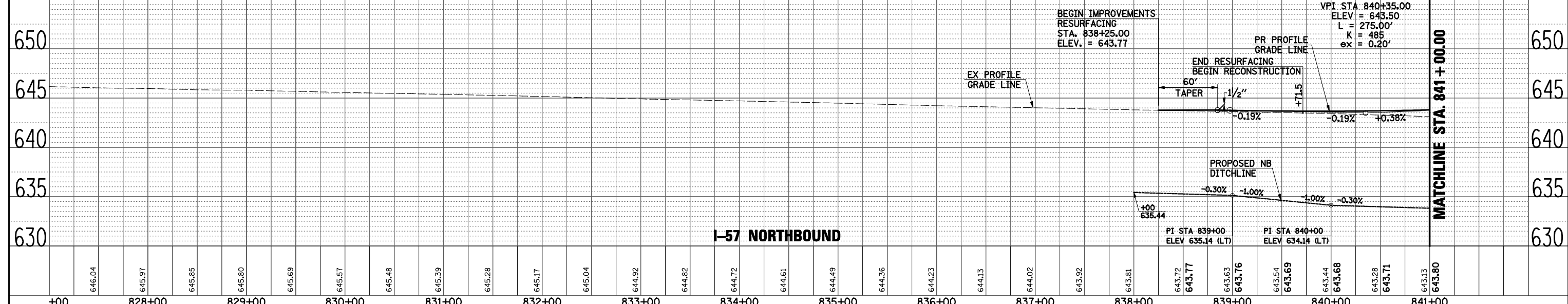

I-57 NORTHBOUND

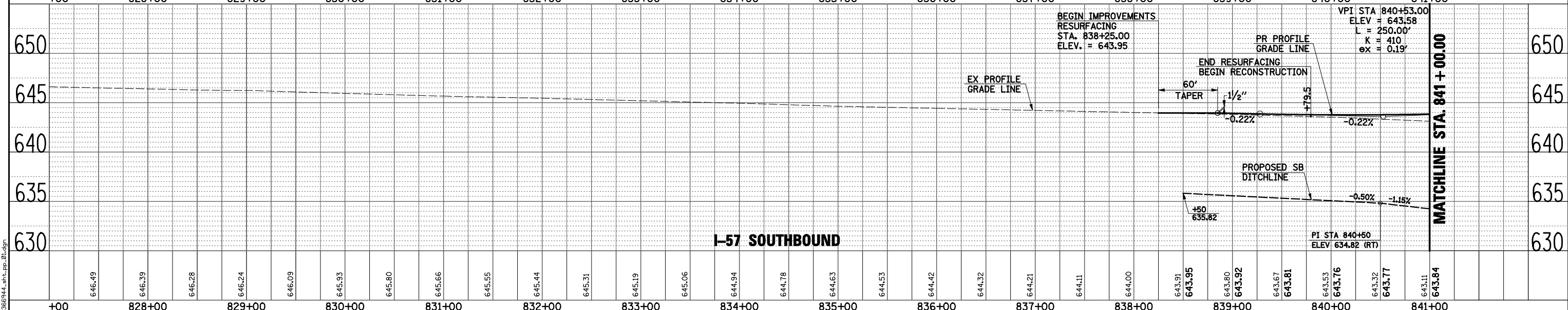

I-57 SOUTHBOUND

PLAN	SURVEYED	DATE
	PLOTTED	
	CHECKED	
	DATE	

PROFILE	SURVEYED	DATE
	PLOTTED	
	CHECKED	
	DATE	

FILE NAME = D36944_sht-pp_01.dgn



USER NAME = bhenrichs	DESIGNED BAH	REVISED
	DRAWN BAH	REVISED
PLOT SCALE = 50.00' / IN.	CHECKED KAC	REVISED
PLOT DATE = 12/7/2012	DATE 12/07/2012	REVISED

**STATE OF ILLINOIS
DEPARTMENT OF TRANSPORTATION**

INTERSTATE 57 OVER LANGAN CREEK PLAN AND PROFILE	
SCALE:	SHEET 1 OF 4 SHEETS STA. TO STA.

F.A.I. R.T.E.	SECTION	COUNTY	TOTAL SHEETS	SHEET NO.
57	141 BR(S) & 38-1 BR(NB)	IROQUOIS	138	19
CONTRACT NO. 66944			ILLINOIS FED. AID PROJECT	