

SCHEDULE OF QUANTITIES
U.S. 20 (LAKE ST) AT MEDINAH ROAD

NO.	QUANT.	UNIT	DESCRIPTION
1.	1	EACH	MAINTENANCE OF EXISTING TRAFFIC SIGNAL INSTALLATION
2.	1	EACH	TRANSCIVER - FIBER OPTIC
3.	4	EACH	SIGNAL HEAD, LED, 1-FACE, 3-SECTION, BRACKET MOUNTED
4.	2	EACH	PEDESTRIAN SIGNAL HEAD, LED, 1-FACE, BRACKET MOUNTED WITH COUNTDOWN TIMER
5.	13	EACH	INDUCTIVE LOOP DETECTOR
6.	2	EACH	PEDESTRIAN PUSH-BUTTON
7.	1	EACH	REMOVE EXISTING TRAFFIC SIGNAL EQUIPMENT
8.	1	EACH	FULL-ACTUATED CONTROLLER AND TYPE IV CABINET, SPECIAL
9.	1	EACH	UNINTERRUPTABLE POWER SUPPLY, SPECIAL
10.	2	EACH	SIGNAL HEAD, LED, 2-FACE, 1-3 SECTION, 1-5 SECTION, BRACKET MOUNTED, RETROFIT
11.	6	EACH	SIGNAL HEAD, LED, 1-FACE, 5-SECTION, MAST ARM MOUNTED, RETROFIT
12.	2	EACH	SIGNAL HEAD, LED, 2 FACE, 5-SECTION, BRACKET MOUNTED, RETROFIT

NOTE:
THE EXISTING CONTROLLER IS AN ECONOLITE ASC/2S-2100 IN A TYPE IV CABINET.

EXISTING INTERCONNECT TO GLENN ELLYN ROAD

EXISTING INTERSECTION AND SAMPLING (SYSTEM) DETECTORS

- CONSTRUCTION NOTES:**
- ① REMOVE THE EXISTING PROGRAMMABLE TRAFFIC SIGNAL HEAD AND REPLACE WITH NEW SIGNAL HEAD, LED, 1-FACE, 3-SECTION, MAST ARM MOUNTED. REINSTALL EXISTING BACKPLATE AND REUSE ALL EXISTING CABLES.
 - ② RELOCATION OF THE EXISTING PHASING UNIT FOR THE EMERGENCY VEHICLE PRE-EMPTION SYSTEM IS TO BE INCLUDED IN THE COST OF THE PAY ITEM "FULL ACTUATED CONTROLLER AND CABINET OF THE TYPE SPECIFIED."

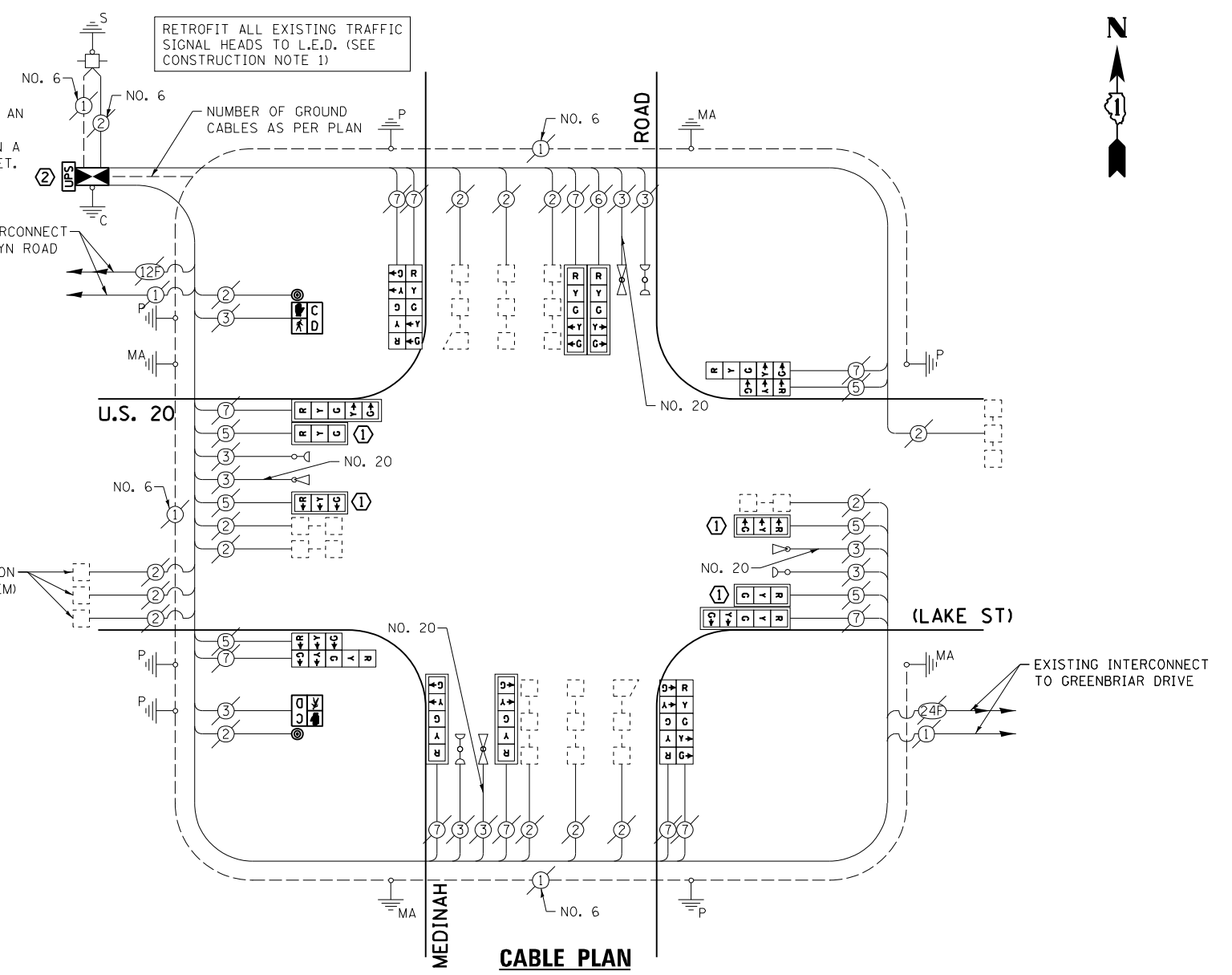

THE FOLLOWING ITEMS SHALL BE REMOVED BY THE CONTRACTOR AND SHALL BE DISPOSED OF BY THEM OUTSIDE THE RIGHT-OF-WAY AT THEIR EXPENSE. THE SALVAGE VALUE OF THE REMOVED EQUIPMENT SHALL BE REFLECTED IN THE CONTRACT BID PRICE.

- 1 EACH CONTROLLER AND CABINET (COMPLETE)
- 4 EACH TRAFFIC SIGNAL HEAD, 1-FACE, 3-SECTION
- 2 EACH PEDESTRIAN SIGNAL HEAD, 1-FACE
- 2 EACH PEDESTRIAN PUSH-BUTTON

I.D.O.T. TRAFFIC SIGNAL INSTALLATION ELECTRICAL SERVICE REQUIREMENTS					TOTAL WATTAGE
TYPE	NO. LAMPS	INCAND.	L.E.D.	OPERATION	
SIGNAL (RED)	18	135	17	0.50	153.0
SIGNAL (YELLOW)	18	135	25	0.25	112.5
SIGNAL (GREEN)	18	135	15	0.25	67.5
ARROW	24	135	12	0.10	28.8
PED. SIGNAL	2	90	25	1.00	50.0
CONTROLLER	1	-	100	1.00	100.0
LUMINAIRE	-	-	250	0.50	-
L.E.D. ST. NAME SIGN	-	-	64	0.50	-
VIDEO SYSTEM	-	-	150	1.00	-
BATTERY BACKUP	1	-	25	1.00	25.0
ILLUMINATED SIGN	-	-	25	0.05	-
TOTAL =					536.8

ENERGY COSTS - BILLED TO: VILLAGE OF BLOOMINGDALE (ADDRESS) 201 BLOOMINGDALE ROAD (ADDRESS) BLOOMINGDALE, IL 60104
ENERGY SUPPLY - CONTACT: JOE STACHO (PHONE: (630) 424-5704) COMPANY: CQM-ED

THE TRAFFIC SIGNAL CONTROL EQUIPMENT FOR THIS PROJECT SHALL BE "ECONOLITE" TO MATCH THE EXISTING ADJACENT SYSTEM.

EXISTING AND PROPOSED CONTROLLER SEQUENCE

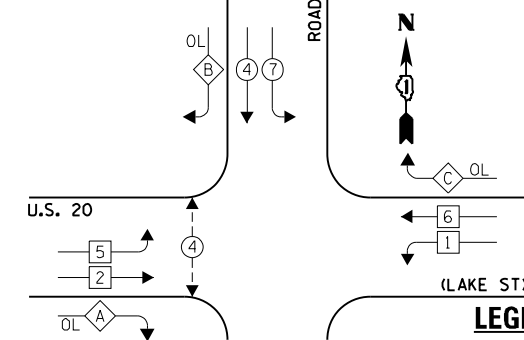

OVERLAP LETTER	PERMISSIVE PHASE	PROTECTED PHASE
A	= 2 +	3
B	= 4 +	5
C	= 6 +	7
D	= 8 +	1

EXISTING AND PROPOSED PHASE DESIGNATION DIAGRAM

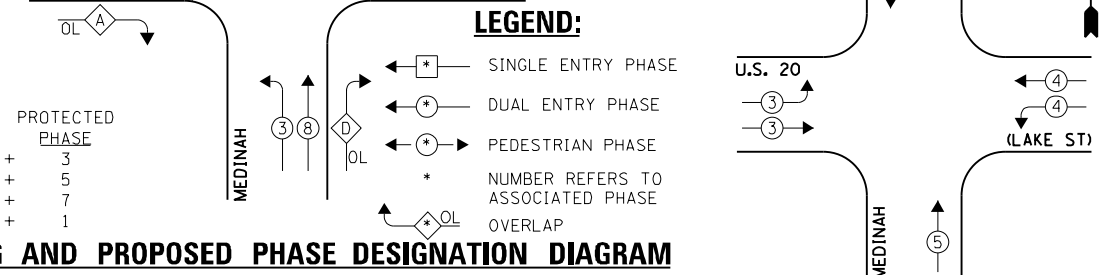

EXISTING EMERGENCY VEHICLE PREEMPTION SEQUENCE

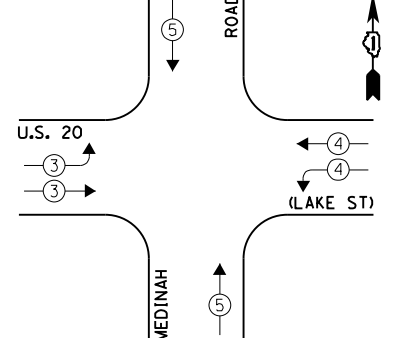

EXISTING EMERGENCY VEHICLE PREEMPTORS		
EMERGENCY VEHICLE PREEMPTOR	3	4
MOVEMENT	→	↑

FILE NAME = 60V80-049-ts.dgn	USER NAME = zwallsten	DESIGNED - JRD	REVISIONS -
Default	PLOT SCALE = 1:200	DRAWN - ZCW	REVISIONS -
	PLOT DATE = 12/20/2012	CHECKED - KLB	REVISIONS -
		DATE - 12-20-12	REVISIONS -

STATE OF ILLINOIS
DEPARTMENT OF TRANSPORTATION

SCHEDULE OF QUANTITIES, CABLE PLAN, PHASE DESIGNATION DIAGRAM, & EMERGENCY VEHICLE PREEMPTION SEQUENCE
U.S. 20 (LAKE ST) AT MEDINAH ROAD

SCALE: NONE SHEET OF SHEETS STA. TO STA.

F.A. RTÉ.	SECTION	COUNTY	TOTAL SHEETS	SHEET NO.
VARIES	2012-070 I	DuPAGE	103	49
			CONTRACT NO. 60V80	
ILLINOIS FED. AID PROJECT				